

Surveyed for Henry Bayles 466-2/3 acres of land on part of a Military Warrant No. 3548 on the waters of Darby Creek. Beginning at two ashes, northerly corner to John M. Gregory's Survey No. 3679 in the line of Charles Simms's Survey No. 1187; thence with Simms line passing his corner and with the line of Robert Cochran's

Survey No. 3464 and passing his easterly corner N. 53 E, 375 poles to two sugartrees and two beeches; thence S. 10 E. 104 poles to a hickory, large beech and small ironwood; thence N. 80 E. 128 poles crossing a small branch to three beeches and two sugartrees; thence S. 10 E. 57 poles to a beech, two sugartrees and a hickory; thence S. 55 W. 253 poles to an ash, northerly corner to William Taylor's Survey No. 3744; thence with his line S. 53 W. 160 poles to two sugartrees and a small blue ash, westerly corner to Taylor and in the line of the representatives of Thomas Sandor's Survey No. 3751; thence with said line and with Gregory's line N. 37 W. 199 poles to the beginning.

Jonathan Piper,  
William Calhoon, C.C.  
Isaac Wiggitt, M.

Walter Dun, D.S.  
May 20th, 1813.  
July 23rd, 1813.

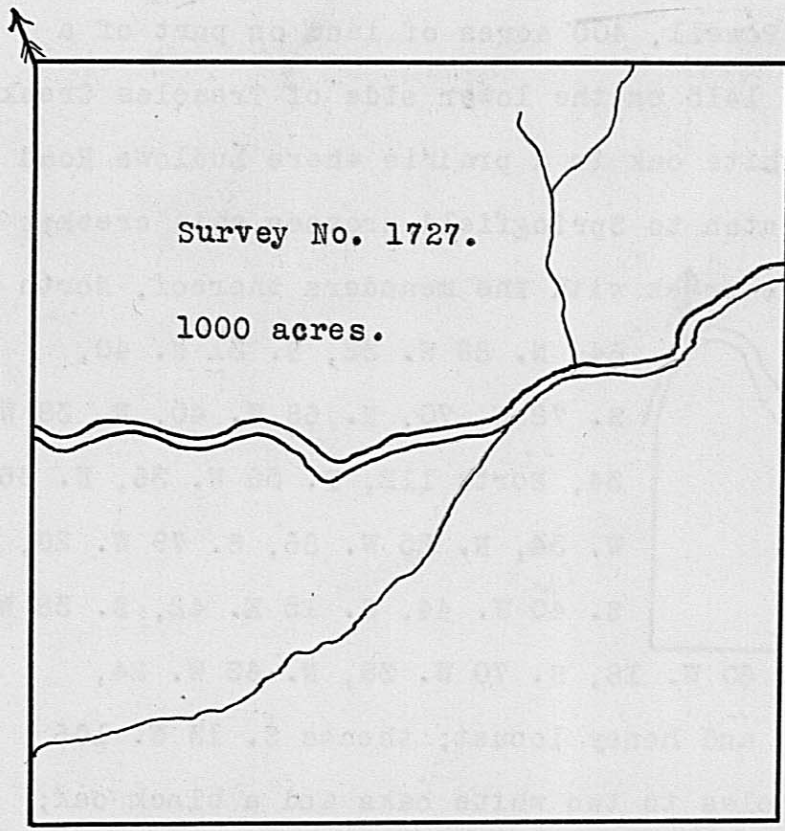

Surveyed for James Innis 1000 acres of land on part of a Military Warrant No. 2214 on Deercreek, a branch of the Scioto River. Beginning at two hickories, a mulberry and white oak, running S. 20 W. 400 poles, crossing Deercreek at 200 poles and a branch at 330 poles to a stake; thence S. 70 E. 400 poles to a small post oak; thence N. 20 E. 400 poles crossing the creek at 292 poles to an ash, white oak and maple; thence N. 70 W. 400 poles crossing a branch at 108 poles to the beginning.

John Hamilton,  
Joshua Dodson, C.C.  
Edward Mosby, M.

John Obannon, D.S.  
June 30th, 1796  
July 7th, 1796.

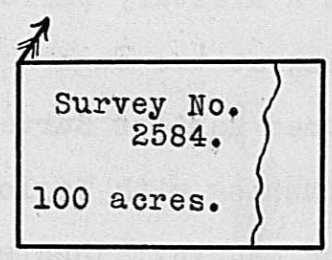

Surveyed for Daniel Morris, assignee, 100 acres of land on a Military Warrant No. 4418 on the south fork of Darby's Creek. Beginning at three white oaks, northerly corner to Strother Jones' Survey No. 4750, running with his line S. 35 E. 100 poles to a stake in a prairie, easterly corner to said Jones's Survey; thence N. 55 E. 160 poles, crossing the Creek to two white oaks and a honey locust; thence N. 35 W. 100 poles to a stake in a prairie; thence S. 55 W. 160 poles crossing the creek at 15 poles to the beginning.

George Fisher,  
Peter Paugh, C.C.  
John McDonald, M.

Duncan McArthur, D.S.  
September 24th, 1805.  
December 17th, 1805.