

Surveyed for William Moody 160 acres of land on part of a Military Warrant No. 3337 on the waters of Darby's creek. Beginning at three White Oaks, Southwest corner to George Mathews Survey No. 5749, running with his line N. 62 E. 180 poles to three Elms in said line; thence S. 28 E. 130 poles to two White Oaks; thence S. 62 W. 250 poles to a Stake; thence North 147 poles to the beginning.

William Galloway,  
James Andrew, C.C.  
William Townsley, M.

James Galloway, Jur. D.S.  
March 30th, 1810.  
April 19th, 1810.

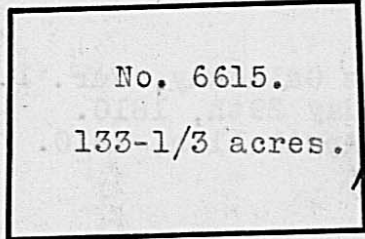

Surveyed for William and George Galloway, assees. 133-1/3 acres of land on part of a Military Warrant No. 5541, on the waters of Paint Creek. Beginning at a Black Oak and Hickory, Northeast corner to James Galloway's Jur's. Survey No. 6204, running North 120 poles to three Hickories; thence West 180 poles to a Stake; thence South 120 poles to a Black Oak, Northwest corner to said Galloway's Survey; thence with his line East 180 poles to the beginning.

James Andrew,  
Jonah Hanaman, C.C.  
William Townsley, M.

James Galloway, Jur. D.S.  
March 15th, 1810.  
April 18th, 1810.

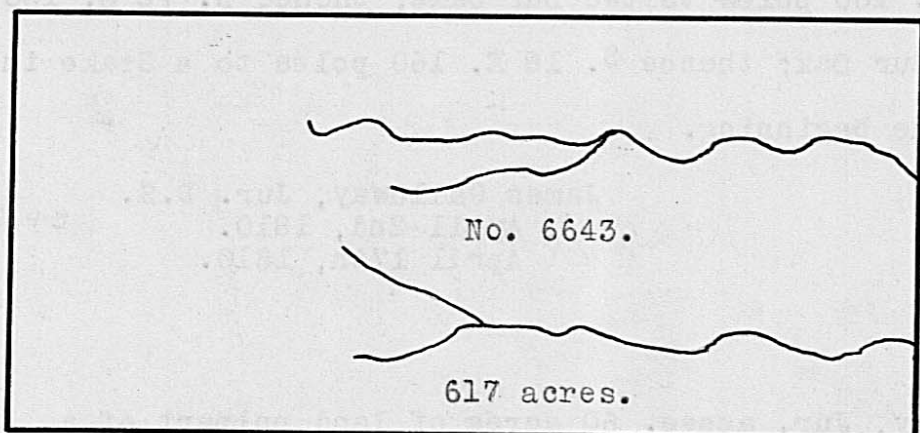

Surveyed for Joseph B. Lapsley, assee. 617 acres of land on part of a Military Warrant No. 5609, on the waters of Darby's Creek. Beginning at a Bur Oak, lower back corner to John Crawford's Survey No. 2681, in the line of said Crawford's Survey No. 2680, running with the line of the first mentioned Survey No. 2681, N. 37 W. 212 poles crossing a branch at 44 poles and one at 154 poles to three White Oaks and a Honey Locust, on the South side of a branch; thence S. 53 W. 466 poles to two Hickories and an Elm; thence S. 37 E. 212 poles to two Elms and a Hickory; thence N. 53 E. 466 poles passing the upper back corner of said Crawford's Survey No. 2680 and with his line to the beginning.

William Galloway,  
James Andrew, C.C.  
William Townsley, M.

James Galloway, Jur. D.S.  
March 30th, 1810.  
April 19th, 1810.

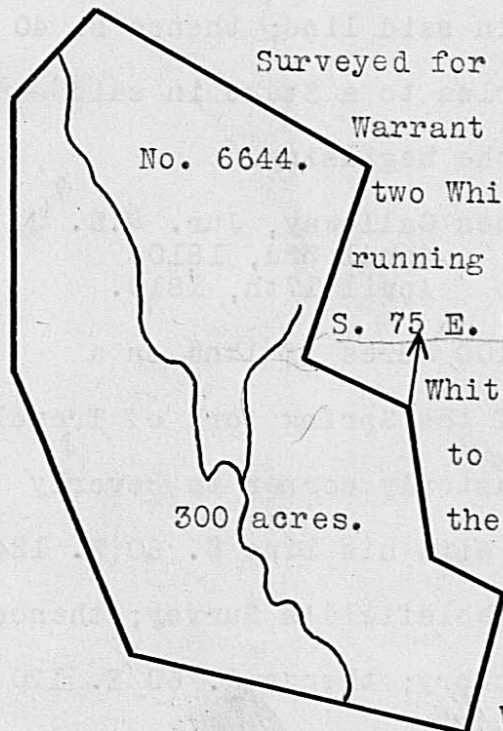

Surveyed for Lincoln Goodale, assee. 300 acres of land on part of a Military Warrant No. 5404, on Gladly run a branch of Deer creek. Beginning at two White Oaks, Northwesterly corner to Robert Mean's Survey No. 5652, running with his line S. 10 E. 84 poles to two White Oaks; thence S. 75 E. 34 poles to three White Oaks; thence S. 15 W. 80 poles to a White Oak; thence N. 75 W. 170 poles crossing Gladly run at 66 poles to three White Oaks; thence N. 52 W. 150 poles to three Bur Oaks; thence North 140 poles to a forked White Oak; thence N. 40 E. 64 poles crossing the run at 36 poles to two Hickories and a White Oak; thence S. 60 E. 160 poles to a Stake; thence S. 17 W. 100 poles to a Stake; thence S. 67 E. 58 poles to the beginning.

James Andrew,  
Josiah Hanaman, C.C.  
Wm. Townsley, M.

James Galloway, Jur. D.S.  
March 29th, 1810.  
April 18th, 1810.