

Surveyed for Gross Scruggs and John Graham, assees. 216-1/3 acres of land on part of three Military Warrants, Scruggs 145-1/3 acres on No. 5916 and Graham 65 acres on No. 5881 and 6 acres on No. 5791, on the waters of Deer creek. Beginning at a Bur Oak in a prairie N. 70 E. 79 poles from the Easterly corner of Gross Scrugg's Survey No. 7628; thence N. 87 E. 68 poles to three Bur Oaks; thence S. 66 E. 124 poles to two Bur Oaks and a Hickory; thence S. 25 W. 176 poles to two Bur Oaks and a Hickory; thence N. 74 W. 196 poles to two Bur Oaks and a forked Hickory; thence N. 27° 30' E. 172 poles to the beginning.

Henry Frack,
David Hanaman, C.C.
Enoch Hanaman, M.

Walter Dun, D.S.
July 18th, 1813.
July 24th, 1813.

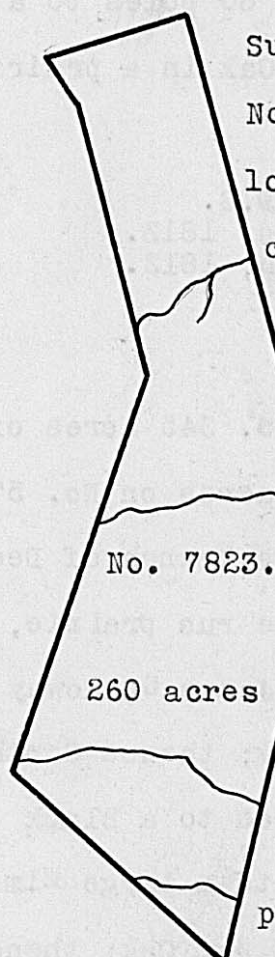

Surveyed for James Johnston 260 acres of land on part of a Military Warrant No. 5792, on the lower side of Darby's creek. Beginning at two Hackberries lower corner on the creek to Lucas Sullivant's Survey No. 3240 and upper corner on the creek to Robert Kay's Entry No. 4276; thence with Kay's line S. 53 W. 109 poles crossing a branch at 20 poles to four Bur Oaks from one root; thence S. 6 W. 194 poles crossing a small branch at 82 and 90 poles a large branch at 112 poles and a branch at 162 poles to two Hickories and a large Bur Oak; thence N. 57 W. 142 poles to a Buckeye and two -lms, Southeasterly corner to Joseph Chambers Survey No. 7398; thence with his line N. 10 E. 222 poles crossing a large branch at 2 and one at 134 poles to a Bur Oak and Jack Oak, Northeasterly corner to Chambers and Easterly corner to Johnston's & Dun's Survey No. 7243; thence with their line N. 23 W. 140 poles crossing a large branch at 20 poles to three Bur Oaks, another corner of their Survey; thence N. 39 W. 33 poles to three Bur Oaks; thence N. 67 E. 74 poles to a Stake in a prairie, upper back corner to said Sullivant's Survey; thence with his back line S. 23 E. 281 poles crossing a large branch at 121 and one at 269 poles to a Hickory, -lm and Bur Oak; lower back corner to Sullivant; thence with his/line N. 67 E. 93 poles crossing a branch to the beginning.

John Roberts,
Charles Hanaman, C.C.
James Chard, M.

W. Dun, D.S.
July 22nd, 1813.
July 24th, 1813.

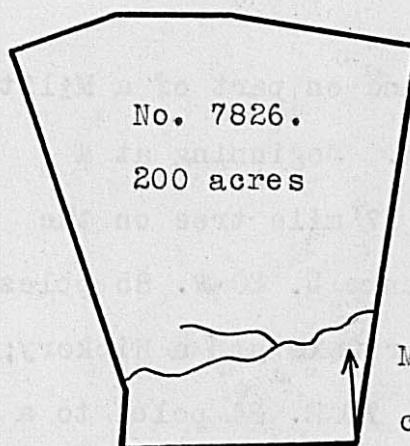

Surveyed for John Graham, assee. 200 acres of land on part of a Military Warrant No. 5791 on the waters of Treacle's creek. Beginning at a Bur Oak, lower back corner to James Galloway's Survey No. 5996; thence S. 81 W. 122 poles to a Bur Oak; thence North 25 poles to a Stake in a prairie, Easterly corner to Robert Mean's Survey No. 5148; thence with his line N. 25 W. 190 poles crossing a branch to three Bur Oaks, Northerly corner to Mean's said Survey; thence N. 65 E. 60 poles to two Bur Oaks; thence N. 87 E. 46 poles to a large White Oak; thence S. 88 E. 109 poles to three White Oaks and a Stake, upper back corner to said Galloway's Survey; thence with his back line S. 4 W. 207 poles crossing a branch at 149 poles to the beginning.

William Lappin,
Henry Johnston, C.C.
James Lappin, M.

Walter Dun, D.S.
July 21st, 1813.
July 23rd, 1813.