

Surveyed for Levi Springer  
1000 acres of land on part of  
a Military Warrant No. 6045, o  
on the waters of Deer creek.  
Beginning at two Post Oaks and a  
Hickory, Southwest corner to  
Benjamin Stubblefield's Survey No.  
5205; thence with his line East 250  
poles to a Stake in a prairie in said  
line; thence S. 17 W. 448 poles to a  
Stake in a prairie, in the line of  
Jesse McKay's Survey No. 5891; thence  
S. 73 W. 45 poles to a Black Oak and Post  
Oak, Northwesternly corner to McKay's said

Survey; thence West 264 poles to two Post Oaks and a Hickory; thence N. 14 E.  $7\frac{1}{2}$  poles  
to three Post Oaks; thence N. 3 E. 84 poles to two Bur Oaks; thence N. 42 W. 104 poles  
to three White Oaks; thence N. 15 E. 96 poles to two Bur Oaks and a Hickory; thence  
N. 46 W. 124 poles to a Post Oak and Hickory; thence West 46 poles to a Red Oak, Hickory  
and White Oak, corner to the Representatives of William Sanford and William Robinson's  
Survey No. 6052 and 9803, in the line of Thomas Worthington's Survey No. 8922; thence  
with his line N. 75 E. 173 poles to a Bur Oak, Southeasterly corner to his Survey and  
Southwesterly corner to Cadwallader Wallace's Survey No. 5880; thence with his line,  
N.  $77\frac{1}{2}$  E. 204 poles to the beginning.

Hugh Montgomery,  
John Chapman, C.C.  
William Robinson, M.

Cadwallader Wallace, D.S.  
October 20th, 1818.  
February 5th, 1819.

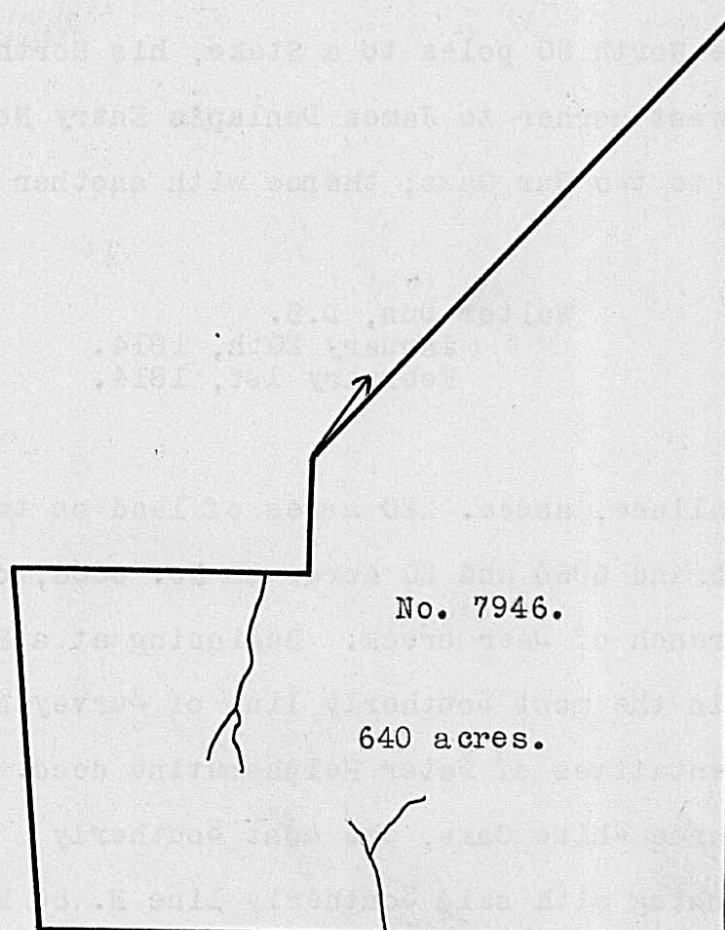

Surveyed for Levi Springer, assee. 640 acres of  
land on part of a Military Warrant No. 6045, on  
the waters of Treacle's creek. Beginning at three  
Hickories, Southerly corner to Richard C. Ander-  
son's Survey No. 4942; thence with his line and  
course thereof, N. 7 E. 325 poles to two White  
Oaks, Easterly corner to the said Survey, South-  
erly corner to Duncan McArthur's Survey No. 4769,  
and Westerly corner to John Ervin's Survey No.  
7676; thence with the line of Ervins said Survey,  
passing his Southerly corner at 54 poles, S. 35 E.  
481 poles to three White Oaks and a Small Hickory  
thence S. 55 W. 353 poles crossing a large wet  
prairie from 176 to 220 poles to three Bur Oaks  
one of them forked, a White Oak and Hickory in

the edge of a prairie; thence N. 40 W. 183 poles to three Bur Oaks in a small grove of  
timber in a large prairie; thence N. 55 E. 150 poles crossing a wet prairie to two Bur  
Oaks on the edge; thence N. 35 W. 57 poles to the beginning.

Robert Lappin,  
John Vannort, C.C.  
Abraham Johnston, M.

Walter Dun, D.S.  
October 26th, 1816.  
December 16th, 1816.