

No. 8564.
103 acres.

Surveyed for Walter Dun, assee. 103 acres of Land on part of a Military Warrant No. 6098 on the waters of Treacle's creek. Beginning at two Elms on the edge of a prairie, Southeasterly corner to Graham and Dun's Survey No. 7391 in the line of Samuel Wallace's Survey No. 2884; thence with said line S. 52 W. 93 poles to two Elms in said line, lower back corner to John M. Gregory's Survey No. 3153; thence with the line of Gregory's said Survey and course thereof N. 9 W. 254 poles to a Stake in said line; thence S. 83 E. 67 poles to three Elms and Honey Locust, Southeasterly corner to Joseph Swearingen's Survey No. 4820, 4945 & 5207, and Westerly corner to Graham and Dun's Survey; thence with their line S. 14 E. 192 poles to the beginning.

George D. Roberts,
Albert Newton, C.C.
Jeremiah Converse, jur. M.

Walter Dun, D. S.
November 26th, 1815.
May 7th, 1816.

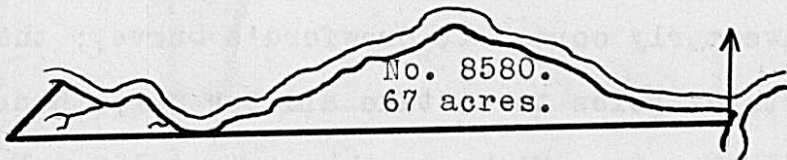

Surveyed for Walter Dun, assee. 67 acres of land on part of a Military Warrant No. 6098 on Little Darby's creek. Beginning at a Stake at the mouth of said creek on the lower side thereof; thence North 4 poles crossing the mouth of said creek to a Sycamore and Willow on the upper side, lower corner on the creek to Thomas Thweatt's Survey No. 2661; thence up the said creek on the upper side thereof with the meanders and binding thereon, N. 86½ W. 16, N. 65 W. 30, N. 42 W. 11, S. 72 W. 9, N. 77 W. 16, N. 49 W. 52, N. 76 W. 14, N. 49 W. 10, S. 74 W. 43, S. 70 W. 38, S. 67 W. 32, S. 76 W. 22, S. 88 W. 24, N. 6 W. 14, N. 63 W. 12, S. 63 W. 11, N. 59 W. 13, N. 47 W. 21 poles to a Stake on the Bank of the creek on the upper side in the line of William Heth's Survey No. 4752; thence with said line S. 10 W. 9 poles crossing the creek to a Buckeye, Cherry tree, three Honey Locusts and two Elms on the bank of the creek, lower corner thereon to Heth's said Survey; thence with the lower line of Heth's said Survey, S. 53 W. 44 poles to two White Oaks and a small Black Oak in said line; thence S. 85° 15' E. 374 poles crossing a Spring branch at 16 at 22 and a small branch at 75 poles to the beginning.

John Steen,
Moses Steen, C.C.
James Gardiner, M.

Walter Dun, D.S.
November 29th, 1815.
December 2nd, 1815.

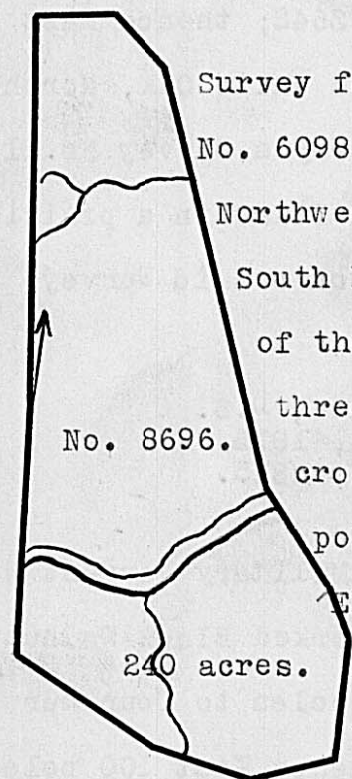

Survey for Walter Dun, assee. 240 acres of land on part of a Military Warrant No. 6098 on the waters of Darby's creek. Beginning at a Black and Bur Oak, Northwesterly corner to George Mathew's Survey No. 5749; thence with his line South 120 poles, crossing Three Mile run at 56 poles to four White Oaks two of them from one root in the edge of a prairie; thence S. 57 E. 78 poles to three small Bur Oaks, two of them from one root; thence S. 73 E. 54 poles crossing a small branch at 20 poles to two Bur Oaks; thence N. 79 E. 50 poles to three Elms from one root; thence N. 3 E. 62 poles to two Red Elms; thence N. 19 W. 26 poles to a Bur Oak in the back line of John Crawford's Survey No. 2681; thence with said line N. 37 W. 52 poles to two Bur Oaks on the bank of Three Mile run; thence N. 16 W. 230 poles crossing the run at 2 poles and a branch at 170 poles to two Bur Oaks; thence N. 48 W. 40 poles to two Bur Oaks and an Elm, Southeasterly corner to the Representatives of William Carters Survey No. 5874, and Southwesterly corner to said Dun's Survey No. 8417; thence with Carter's line West 42 poles to three Bur Oaks in said line; thence S. 3 E. 207 poles crossing a branch to the beginning.

John Steen,
Moses Patterson, C.C.
Levi Francis, M.

Walter Dun, D.S.
April 23rd, 1816.
May 6th, 1816.