

Surveyed for Mary Stephenson 300 acres of land on part of a Military Warrant No. 6441 on the waters of Deer Creek. Beginning at two White Oaks and a Bur Oak, Southerly corner to Gross Scrugg's Survey No. 7828; thence East 131 poles to a Black Oak and Hickory; thence N. 82 E. 66 poles to a large Bur Oak and Hickory; thence N. 23 E 120 poles to a Bur Oak; thence S. 80½ E. 123 poles to a Black Oak, White Oak and Hickory; thence N. 71 E. 45 poles to four Bur Oaks from one root; thence N. 15 W. 106 poles to three Hickories and a Bur Oak, corner to Scruggs and corner to Dun and Graham's Survey No. 9199 &c; thence S. 57 E. 144 poles to two Bur Oaks corner to said Survey; thence S. 32 W. 133 poles to a double Bur Oak in a prairie; thence S. 70 E. 10 poles to two Bur Oaks and a Hickory, Northwesterly corner to John Graham's Survey No. 7560; thence S. 15 W. 138 poles to a Bur Oak and large Black Oak, Northeasterly corner to Stubblefield's No. 6317; thence N. 67 W. 68 poles to two Elms and an Ash; thence N. 23 E. 20 poles to an Elm; thence N. 52 W. 89 poles to two Black Oaks and Elm; thence S. 60 W. 183 poles to three White Oaks; thence N. 26 W. 77 poles to a forked White Oak; thence N. 76 W. 62 poles to two Hickories and a Bur Oak, Northwesterly corner to No. 6317; thence N. 37 W. 22 poles to the beginning.

Andrew Shields
John Shields, C.C.
P. N. White, M.

Allen Latham, D.S.
January 16th, 1824.
Oct. 20, 1824.

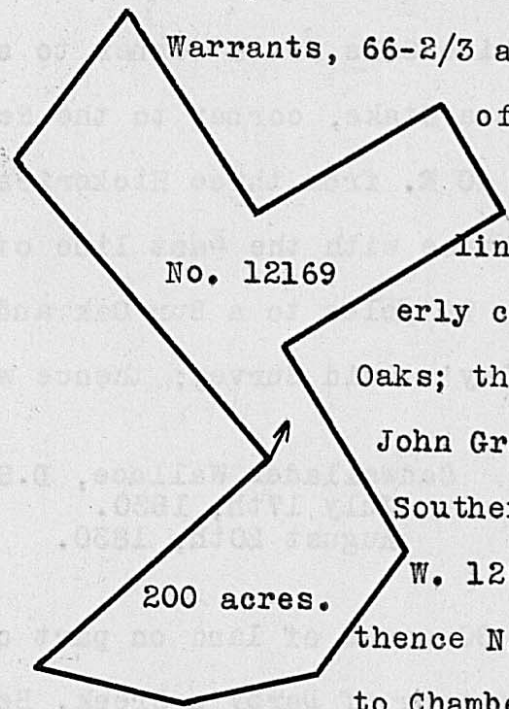

Surveyed for Samuel Smith, assee. 200 acres of land on part of two Military Warrants, 66-2/3 acres on No. 6518 and 133-1/3 acres on No. 6519, on the waters of Darby's Creek. Beginning at two Bur Oaks, the Easterly corner of James Galloway's Survey No. 6602; thence with his line S. 20 W. 162 poles to two Black Oaks and a Bur Oak, Southerly corner to said Survey; thence N. 75½ E. 86 poles to two Bur Oaks; thence N. 49 E. 68 poles to three Bur Oaks, Northerly corner to John Graham's Survey No. 7393; thence N. 8½ E. 75 poles to a Stake, Southerly corner to Joseph Chamber's Survey No. 7400; thence N. 60 W. 120 poles to a Stake, Westerly corner to Chamber's said Survey; thence N. 30 E. 133 poles to a Stake in a prairie, Northerly corner to Chamber's said Survey in the line of Graham and Johnston's Survey No. 7245; thence with said line N. 60 W. 62 poles to a Hickory and two Jack Oaks in said line, Easterly corner to said Chamber's Survey No. 7399; thence S. 50 W. 109 poles to a Stake, Southerly corner to said Survey No. 7399; thence N. 60 W. 127 poles to a Stake, Westerly corner to Chamber's said last mentioned Survey; thence S. 7 W. 96 poles, passing two Dogwoods and a Black Oak, a corner to Galloway's said Survey No. 6602 and with his line to two Bur Oaks another of his corners; thence with another of his lines S. 70 E. 208 poles to the beginning.

Thomas Thompson
Joseph Vance, C.C.
Timothy Smuggle, M.

Walter Dun, D.S.
January 9th, 1823.
May 25th, 1826.