

Surveyed for James Guy, assee. 200 acres of land on part of two Military Warrants, 100 acres on No. 1600 and 100 acres on No. 1601, on the waters of Spring fork of Treacle's Creek. Beginning at three Bur Oaks, Southwesterly corner to the Representatives of George McCormick's Survey No. 12130; thence with his line, correcting the course, N.  $67\frac{1}{2}$  E. 264 poles to a Stake, his corner, in the line of William Case's Survey No. 5482; thence with Case's line S. 9 E. 252 poles to three White Oaks, Easterly corner to said Representatives Survey No. 12129; thence N. 63 W. 320 poles to the beginning.

James Dockum  
William Frakes, C.C.  
P. N. White, M.

E. P. Kendrick, D.S.  
November 15th, 1839.  
August 8th, 1840.

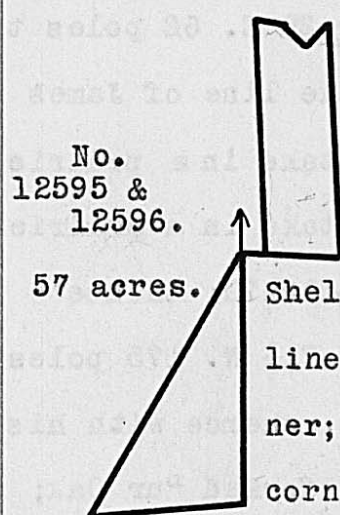

Surveyed for Allen Latham, assee. 57 acres of land on part of a Military Warrant No. 6549 on the waters of Deer Creek. Beginning at three Post Oaks and three White Oaks, Northwest corner to Francis Ratcliff's Survey No. 4685; thence S. 31 W. 154 poles to a Stake in the line of Clough Shelton's Survey No. 9338; thence East 76 poles to three White Oaks in the line of Ratcliff's said Survey; thence North 133 poles to his Northwest corner; thence East 10 poles to a Stake; thence North 119 poles to a Post Oak, corner to Charles Scott's Survey No. 6483 & 6945; thence with said Survey S. 75 E. 20 poles to two White Oaks, his corner; thence S. 58 E. 11 poles to three White Oaks, his corner; thence N. 37 E. 14 poles to three White Oaks, beginning corner to said Survey; thence South 118 poles to a Stake, Northeast corner to Ratcliff's said Survey; thence West 49 poles to the beginning.

William Vaughan  
John Armstrong, C.C.  
P.N. White, M.

E. P. Kendrick, D.S.  
July 8th, 1829.  
August 8th, 1840.

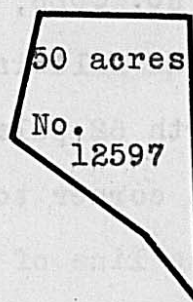

Surveyed for Nathaniel Sawyer assee. 50 acres of land on part of a Military Warrant No. 6549 on the waters of Deer creek. Beginning at three Hickories North corner to James Johnston's Survey No. 7636; thence N. 37 W. 40 poles to two Bur Oaks; thence N. 45 W. 90 poles to a Bur Oak; thence N. 10 E. 64 poles to a Hickory; thence S. 89 E. 80 poles to a Bur Oak, North corner to McCormick's Survey No. 10508; thence with his line S. 1 E. 160 poles to the beginning.

John Davidson  
Joseph C. Davidson, C.C.  
P. N. White, M.

Allen Latham, D.S.  
November 18th, 1833.  
November 19th, 1833.

Surveyed for James Heron and John Graham, assees. 142 acres of land on part of two Military Warrants, to-wit: Heron 100 acres on No. 64 and Graham 42 acres on No. 3223 on the waters of Darby's Creek. Beginning at a Black Oak and a Bur Oak, Northeasterly corner to George Mathew's Survey No. 5749; thence with the line of Walter Dun's Survey No. 8696, N. 3 W. 207 poles to three Bur Oaks, Northwesterly corner to Dun's said Survey in the line of the Representatives of William Carter's Survey No. 5874; thence with their line West 134 poles to two Bur Oaks and a Hickory, a Southerly corner to Carter's said Survey; thence S. 15 E. 216 poles to three White Oaks, a Northerly corner to Mathew's said Survey; thence with Mathew's line East 85 poles to the beginning.

Asahel Parmenter,  
Eber McDowell, C.C.  
David Chapman, M.

Walter Dun, D.S.  
January 20th, 1825.  
February 17th, 1825.