

Surveyed for William Evans,
1076 acres of land on part of
two Military Warrants No. 247
and 248 on Deer Creek. Begin-
ning at a hickory, white oak
and Black oak, Northeasterly
corner to Uriah Springer's
Survey No. 1020, running with
Springer's line N. 70 W. 544
poles, passing his corner at
534 poles to a white oak and
hickory; thence N. 20 E. 206

poles crossing a branch at 64 poles to two hickories; thence N. 64 E. 204 poles crossing
a bend of the Creek at 54 poles, and the Creek at 74 poles to two hickories; thence
S. 70 E. 402 poles crossing a branch to five hickories; thence S. 20 W. 355 poles, cross-
ing the Creek at 95 poles to the beginning.

Frederick Zimmerman,
Joseph Bowman, C.C.
Isaac M. Riley, M.

Duncan McArthur, D.S.
January 30th, 1802.
February 27th, 1802.

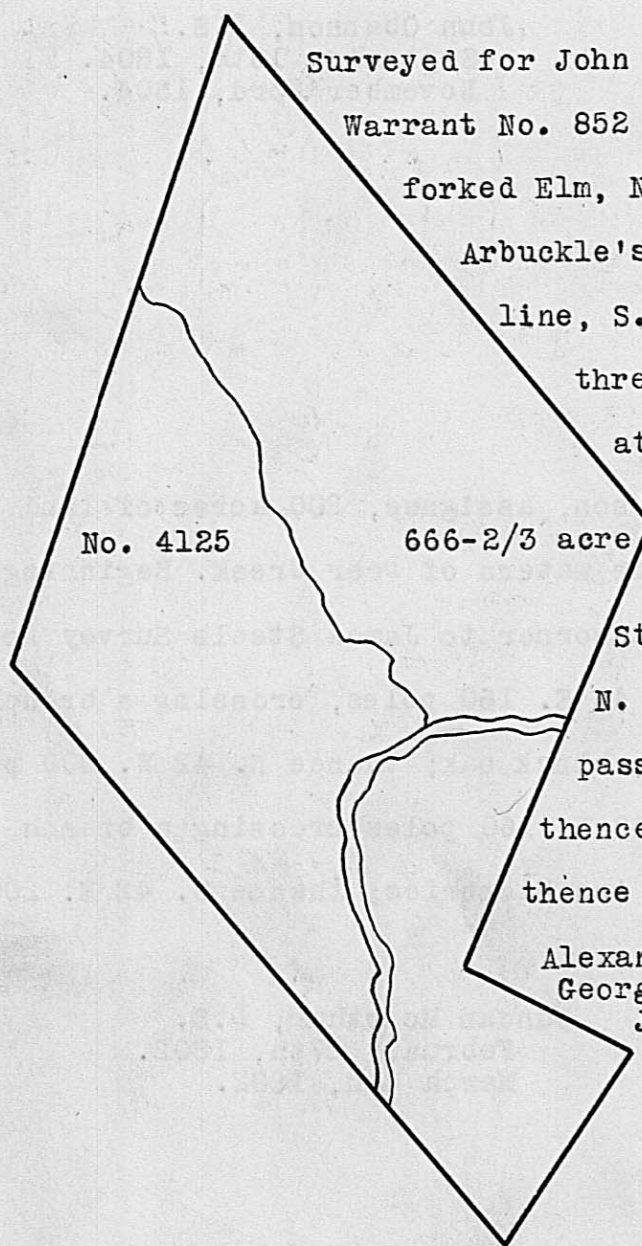

Surveyed for John Bick, 666-2/3 acres of land on part of a Military
Warrant No. 852 on Deercreek. Beginning at a forked white oak and
forked Elm, Northerly corner to the Representatives of Mathew
Arbuckle's, dec'd Survey No. 3900, running with their upper
line, S. 23 W. 250 poles crossing the Creek at 123 poles to
three white oaks from one root, corner to the Represent-
atives Survey; thence with another of their lines,
S. 67 E. 100 poles to a white oak; thence S. 30 W.
123 poles to a stake, Southerly corner to James
Stut's Survey No. 3725; thence with his lower line,
N. 42 W. 400 poles crossing the Creek at 100 poles and
passing his corner at 200 poles to three small ash;
thence N. 17 E. 352 poles, crossing a branch to a stake;
thence S. 41 E. 352 poles to the beginning.

Alexander Gwins,
George Shraner, C.C.
John McDonald, M.

Duncan McArthur, D.S.
January 29th, 1802.
February 26th, 1802.