

Surveyed for William B. Wallace, 166-2/3 acres of land on part of a Military Warrant No. 702 on the Springfork of Treacles Creek. Beginning at a Stake in a Prairie, on the East bank of the creek, 80 poles above a Spring where are three White Oaks, one marked N.D. one W.R. and the other R. running S. 50 W. 50 poles to a Stake in a Prairie; thence S. 20 E. 174 poles to two White Oaks; thence S. 80 E. 120 poles to two White Oaks; thence N. 20 E. 120 poles crossing the creek at 60 poles to two Black Oaks; thence N. 80 W. 60 poles to a large White Oak; thence N. 34 W. 146 poles to a large White Oak and two Hickories; thence S. 50 W. 50 poles to the beginning.

William Townsley,  
William Townsley, C.C.  
Samuel Galloway, M.

James Galloway, jr. D.S.  
November 12th, 1807.  
March 19th, 1808.

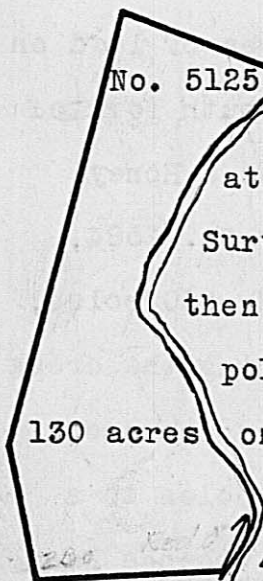

Surveyed for James Galloway, junr. assee. 130 acres of land on part of a Military Warrant No. 5041 on the lower side of Darby's Creek. Beginning at a Red Oak and five Ironwoods, upper corner on the creek to Lucas Sullivant's Survey No. 3240, running with his line S. 67 W. 96 poles to two Bur Oaks; thence N. 35 W. 66 poles to two Black Oaks and a Bur Oak; thence N. 10 W. 236 poles to a Stake in a Prairie; thence S. 85 E. 98 poles to two Honey Locusts on the bank of the creek; thence down the creek with the meanders thereof, S. 43 W. 8, S. 15 W. 104, S. 21 E. 48, S. 64 E. 40, S. 33 E. 30, S. 65 E. 40, S. 33 E. 18, S. 48 W. 26, S. 44 E. 20 poles to the beginning.

Moses Mitchell,  
Samuel Mitchell, C.C.  
James Boner, M.

James Galloway, junr. D.S.  
January 21st, 1807.  
January 26th, 1807.

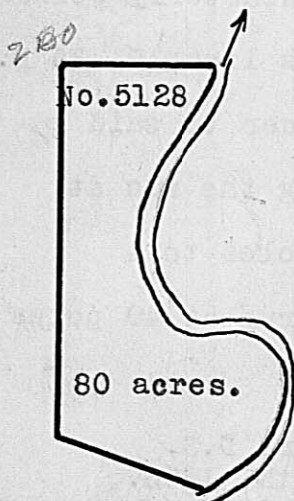

Surveyed for Alexander Kerr, assee. 80 acres of land on part of a Military Warrant No. 3016, on the lower side of Darby's Creek. Beginning at two Honey Locusts upper corner on the Creek to James Galloway Junr. Survey No. 5125, running up the creek with the meanders thereof, N. 26 E. 40, N. 12 W. 38, N. 56 W. 30, S. 62 W. 52, N. 41 W. 56, North 96 poles to an Ash and Honey Locust, lower corner to William Henry's Survey No. 1571; thence with his line S. 63 W. 80 poles to two Bur Oaks, corner to said Henry's Survey; thence S. 26 E. 190 poles to a Stake; thence S. 85 E. 83 poles to the beginning.

Samuel Mitchell,  
Moses Mitchell, C.C.  
James Boner, M.

James Galloway, junr. D.S.  
January 23rd, 1807.  
January 27th, 1807.