

Tom Straley  
0.792<sup>a</sup>  
D.B. 261 p. 480

LUCAS ROAD 60' Co. Road No. 45

Reference  
Begin for  
Description

P.K. Nail  
found

0.937<sup>a</sup>

Vacant land

Jay E. Straley, Jr.

8.132<sup>a</sup>... "Seventh" Tract  
Deed Bk. 258 p. 662

8.132<sup>a</sup>  
0.937<sup>a</sup> this Survey  
7.195<sup>a</sup> remaining

Tom V. Reed  
1.038<sup>a</sup>  
D.B. 249 p. 246

Ralph T. Eagle, et al.  
56<sup>a</sup> D.B. 250 p. 264

Reference; Being part of a 8.132<sup>a</sup> tract "Seventh Tract"  
as conveyed to Jay E. Straley by certificate of transfer  
in the matter of the Estate of Ben Straley, deceased,  
as recorded in Deed Book 258, page 662, Madison  
County, Ohio records.

**SURVEY OF 0.937<sup>ac</sup> TRACT**  
VIRGINIA MILITARY SURVEY No. 8696  
CANAAN TWP. MADISON COUNTY, OHIO  
SCALE; 1"=100'  
JUNE, 1985  
Surveyed for - Mr. Jay E. Straley, Jr.

F. K. Harvey  
Registered Surveyor No. 2570  
Tel. 614-877-3293

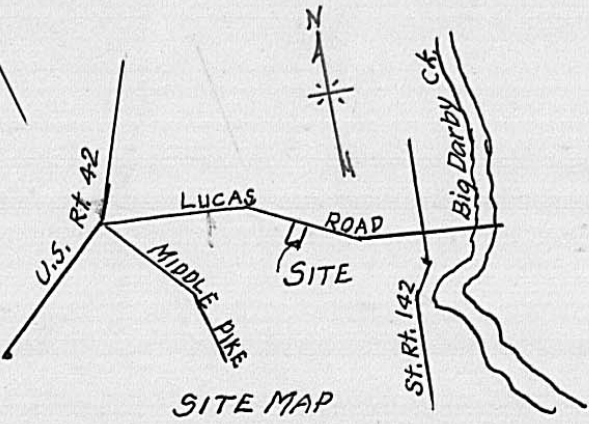

Situated in Virginia Military Survey No. 8696, Township of Canaan, County of Madison, State of Ohio. Being part of a 8.132 acre tract "Seventh Tract" as conveyed to Jay E. Straley by certificate of transfer in the matter of the estate of Ben Straley, deceased as recorded in Deed Book 258, page 662, Madison County, Ohio, records and more particularly described as follows:

Beginning at a spike nail in the center of Lucas Road, County Road No. 45, 60' wide, which is referenced as being North  $64^{\circ} 34'$  West a distance of 600.00 feet, measured along the centerline of said Lucas Road, from a P.K. nail at the Northwesterly corner of a 1.038 acre tract as conveyed to Tom V. Reed, Deed Book 249, page 246, and being also the Northeasterly corner of said 8.132 acre tract.

Thence from said true point of beginning south  $25^{\circ} 26'$  West a distance of 272.00 feet to an iron pin, passing an iron pin at 30.00 feet.

Thence North  $64^{\circ} 34'$  West parallel to said Lucas Road a distance of 150.00 feet to an iron pin.

Thence North  $25^{\circ} 26'$  East, a distance of 272.00 feet, passing an iron pin at 242.00 feet to a spike nail in the centerline of said Lucas Road.

Thence South  $64^{\circ} 34'$  East a distance of 150.00 feet, along the centerline of said Lucas Road to place of beginning, containing 0.937 acre.

Subject however to all legal highways, easements and restrictions of record.

Surveyed by F.K. Harvey, Registered Surveyor No. 2570, June, 1985.