

Mary A. Roby
66.99°

HAYDEN RUN ROAD

Tile 145'

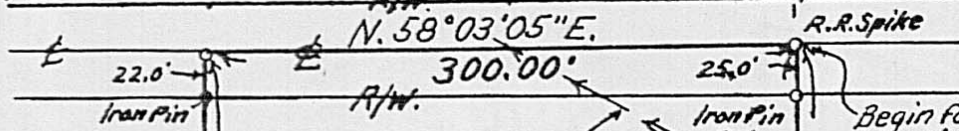

Reference; Being part of a 206.677^{ac} Tract as conveyed by Certificate of transfer to The Huntington National Bank, Trustee in the matter of the Estate of Harry J. Shaver, deceased, as recorded in Deed Bk. 261, pg. 825 Madison County, Ohio records.

Tile flows into Big Darby Creek and progresses in size at going to Creek.

Note; The only tiling on this 6.887^{ac}.

Euletta M. Roby

59.52^a

Deed Bk. 216 p 206, 207

HAYDEN RUN ROAD

N. 31° 54' 35\"/>

1000.00'

6.887^{ac}.

Vacant land as of June, 1986

S. 31° 54' 35\"/>

1000.00'

The Huntington National Bank, Trustee
Trust No. 320637
Deed Bk. 261, pg. 825

206.677^{ac} - deed
6.887^{ac} - this Survey
199.790^{ac} - remaining



Iron Pin

S. 58° 03' 05\"/>

300.00'

Iron Pin

Huntington National Bank, Trustee

CARTER MILL ROAD

(Franklin County) LANGTON ROAD

MADISON COUNTY Canaan Twp.
FRANKLIN COUNTY Brown Twp.

Canaan Twp.
Madison County
Franklin County
Brown Twp.

SITE MAP
Scale; 1" = 600'

Not in Flood Plane

SURVEY OF 6.887^{ac}.
VIRGINIA MILITARY SURVEY # 3744
CANAAN TWP. MADISON COUNTY, OHIO
SCALE; 1" = 100'
JUNE, 1986

SURVEYED FOR - THE HUNTINGTON NATIONAL BANK

F. K. Harvey
Registered Surveyor No. 2570
Tel. (614) 877-3293

42-86 A

Situated in Virginia Military Survey No. 3744, Township of Canaan, County of Madison, State of Ohio. Being part of a 206.677 acre tract as conveyed by certificate of transfer to The Huntington National Bank, Trustee, in the matter of the Estate of Harry J. Shaver, deceased, as recorded in Deed Book 261, page 825, Madison County, Ohio records and more particularly described as follows:

Beginning at a Railroad Spike in the center of Hayden Run Road at the Northeast corner of said 206.677 acre tract, Deed Book 261, page 825. Said point being also the Northwest corner of a 59.52 acre tract as conveyed to Euletta M. Roby, Deed Book 216, page 206.

Thence from said point of beginning South $31^{\circ} 54' 35''$ East a distance of 1000.00 feet along the Easterly line of said 206.677 acre tract, being also the Westerly line of said 59.52 acre tract, to an iron pin, passing an iron pin at 25.00 feet.

Thence South $58^{\circ} 03' 05''$ West, parallel to said Hayden Run Road a distance of 300.00 feet to an iron pin.

Thence North $31^{\circ} 54' 35''$ West, parallel to the Easterly line of tract herein being described, a distance of 1000.00 feet, passing an iron pin at 978.00 feet to a Railroad Spike in the center of said Hayden Run Road.

Thence North $58^{\circ} 03' 05''$ East a distance of 300.00 feet along the centerline of said Hayden Run Road to place of beginning, containing 6.887 acres.

Subject however to all legal highways, easements and covenants of record.

Description from a new survey made by Francis K. Harvey dated June 7, 1986.