

Doris Jay Pickens
 1.34[±] in Corporation
 4.767[±] in Township
 Deed Bk. 257
 pg. 676

1.0683[±] ac

Corp line of W. Jefferson
 JEFFERSON TWP.

0.487[±] in Jefferson Twp.

S. 56° 37' 00" W.
 179.00'

J. William Hurt

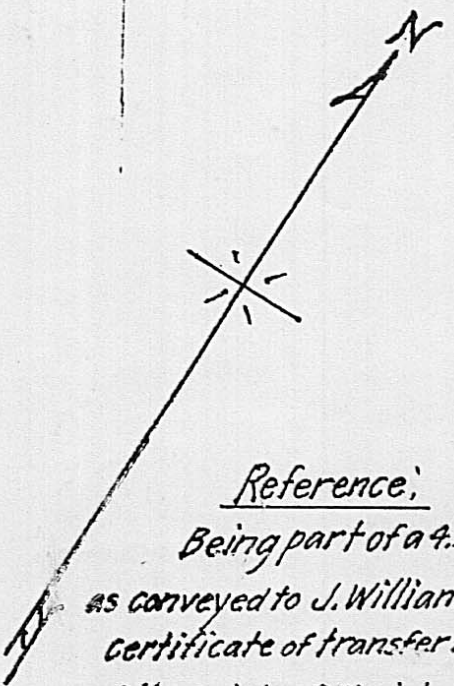

Reference:
 Being part of a 4.53[±] tract; 3rd Tract
 as conveyed to J. William Hurt by
 certificate of transfer in the matter
 of the Estate of Virginia B. Hurt as recorded
 in Deed Book 162, p. 365.

SURVEY OF 1.0683[±] ac.
 VIRGINIA MILITARY SURVEY #2836
 JEFFERSON TWP. & VILLAGE OF W. JEFFERSON
 MADISON COUNTY, OHIO

Scale: 1" = 30'

Sept. 1986

DR. J. WILLIAM HURT - Owner

F. K. Harvey
 Registered Surveyor No. 2570
 Tel. 614-877-3293

50A-86

Situated in Virginia Military Survey No. 2836, Village of West Jefferson and Jefferson Township, Madison County, Ohio. Being part of a 4.53 acre tract, "Third Tract" as conveyed to J. William Hurt by certificate of transfer in the matter of the Estate of Virginia B. Hurt as recorded in Deed Book 162, page 365 and more particularly described as follows:

Beginning at a Railroad spike in the center of West Jefferson-Kiousville Road, which is referenced as being South $56^{\circ} 37' 00''$ West a distance of 35.00 feet, measured along the centerline of said road from a Railroad spike at the Northeasterly corner of said 4.53 acre tract, also being the Northwesterly Corner of a 6.107 acre tract as conveyed to Doris J. Pickens as recorded in Deed Book 257, page 676.

Thence from said true point of beginning South $32^{\circ} 32' 00''$ East a distance of 260.00 feet to an iron pin, passing an iron pin at 35.00 feet. Said last course being parallel to and 35.00 feet distant from the Easterly line of said 4.53 acre tract, Deed Book 162, page 365.

Thence South $56^{\circ} 37' 00''$ West a distance of 179.00 feet to an iron pin.

Thence North $32^{\circ} 32' 00''$ West a distance of 260.00 feet to a Railroad Spike in the center of said West Jefferson-Kiousville Road, passing an iron pin at 225.00 feet.

Thence North $56^{\circ} 37' 00''$ East a distance of 179.00 feet along the centerline of said West Jefferson-Kiousville Road to place of beginning containing 1.0683 acres.

Being 0.581 acre in the Village of West Jefferson and 0.487 acre in Jefferson Township.

Subject however to all legal highways, easements and restrictions of record.