

ENLARGED DRAWING OF HOUSE 1"=10'

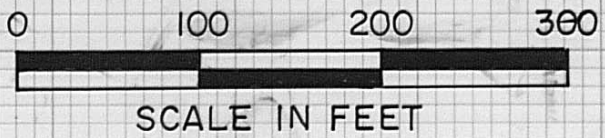
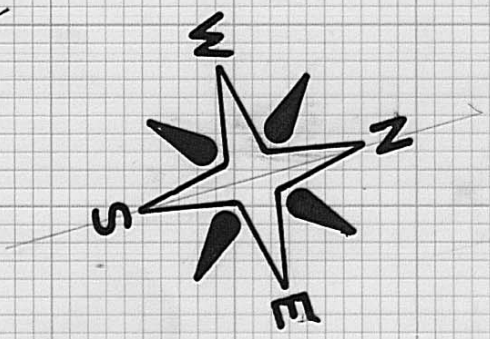
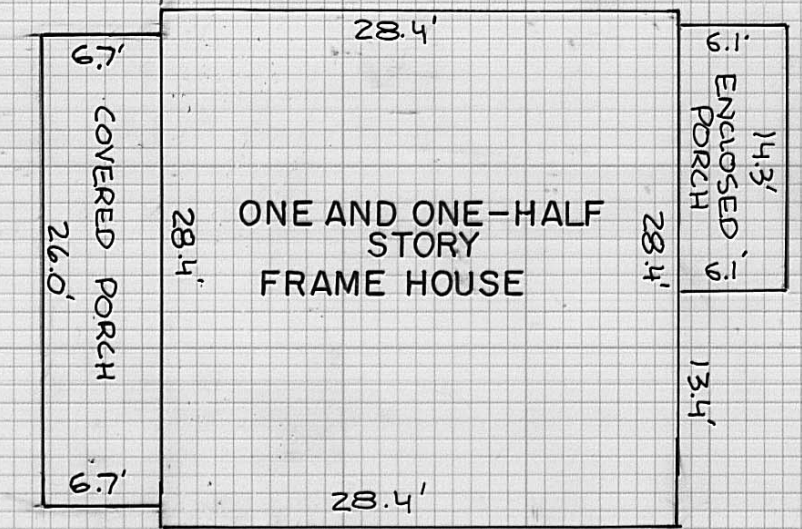

POINT OF BEGINNING
FOUND IRON MONUMENT

TRUE POINT OF BEG:
26.26'

IRON MONUMENT FOUND
AT SE CORNER OF WILCOX

7.0000 ACRES

⊙ - IRON PIPES SET ARE 3/4" IN DIA. BY 30" IN LENGTH WITH ALUMINUM CAPS MARKED P.S. 5969

BABB ENGINEERING & SURVEYING
209 LAFAYETTE ST. P.O. BOX 374
LONDON, OHIO 43140
TELE: 614-852-4121

PLAT OF A 7.0000 ACRE SURVEY, MADISON CO., OHIO, UNION & OAK RUN TOWNSHIPS, V.M.S. 4510 & V.M.S. 5823, BEING PART OF A 731.661 ACRE TRACT IN THE NAME OF THE J.L. WILCOX & CO., AN OHIO CORPORATION, AS RECORDED IN DEED BOOK 256, PAGE 688

I HEREBY CERTIFY THAT THE HEREON PLATTED PROPERTY WAS SURVEYED TO ACCEPTABLE STANDARDS

Neil Babb
NEIL BABB P.S. 5969

DATE: 23 JULY 1982	DRAWN BY: nb
FIELD BOOK NO. <u>XIII</u>	CHECKED BY: NB
JOB NO. SV-03682	51/86

S.R. 56

BIG PLAIN - CIRCLEVILLE ROAD 50' RIGHT OF WAY C.R. 4

UNION TWP.
OAK RUN TWP.

S 73°53'13" E 357.18'

N 73°53'13" W 320.00'

S 73°53'13" E 320.00'

N 22°36'29" E 959.03'

S 22°36'29" W 959.03'

GRAVEL DRIVE

ELECTRIC SERVICE POLES ARE 3' INSIDE PROPERTY LINE

LEACH FIELD

EXISTING HOUSE

TWO CAR GARAGE 28.4' X 23.7'

DEEP WELL

EXISTING FENCE

V.M.S. 5823

V.M.S. 9336

V.M.S. 4510

173.4'

195.0'