

(1)(2)

GRANTOR: Robert Stevens, D.B. 180, Pg. 161

LOCATION: City of London, VMS 8742

ACREAGE: (1) 0.0229 ac. (2) 0.2513 ac.

3/4" iron pipe set at all corners

N 60 deg. 00' E 300.00'

(3)(4)(5)(6)

GRANTOR:

John E. McConnell, D.B. 275, Pg.56

LOCATION:

City of London, VMS 8742

ACREAGE:

(3) 0.0456 ac. (4) 0.3188 ac.

(5) 0.3630 ac. (6) 0.3616 ac.

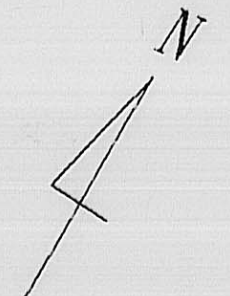
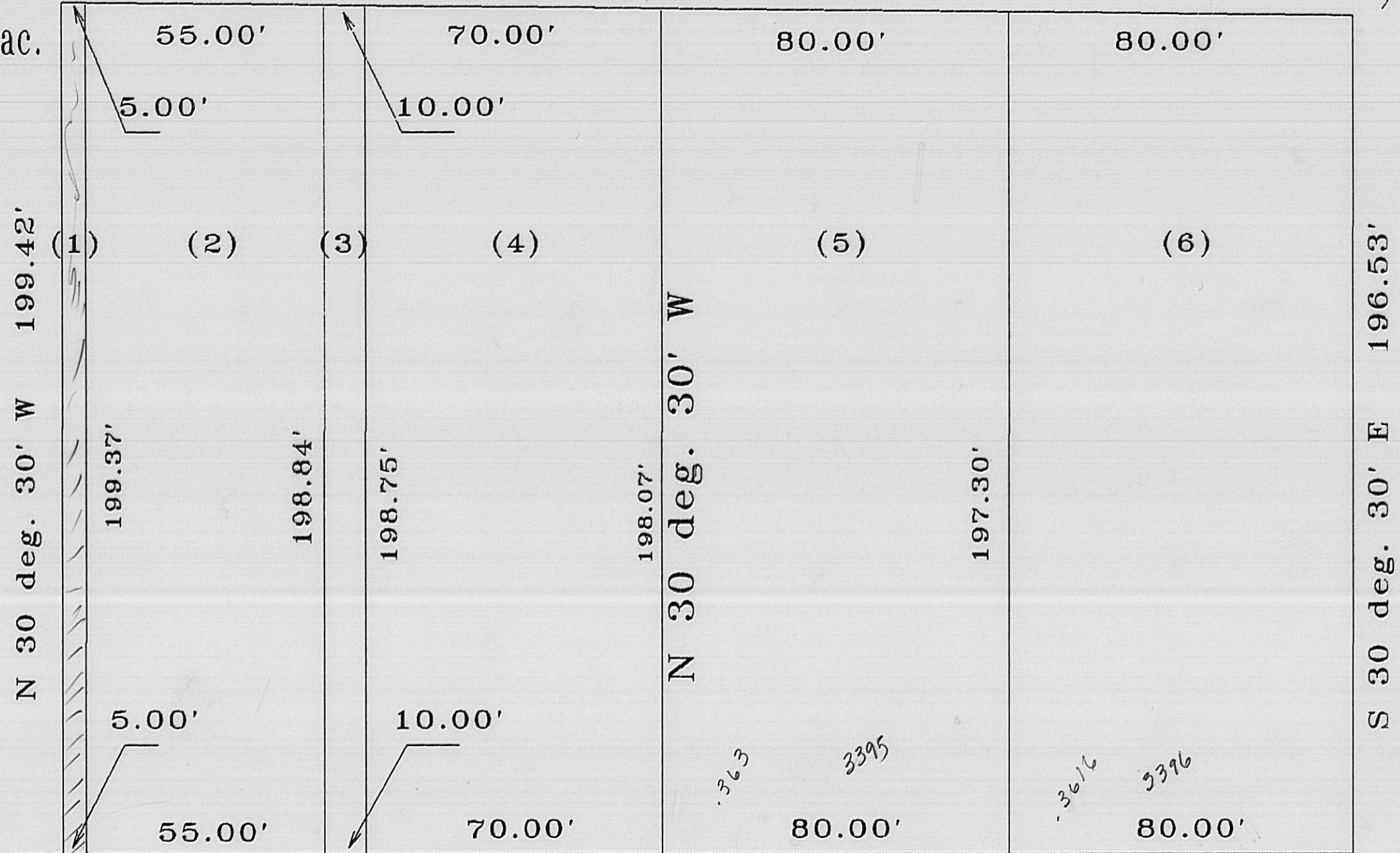

North R/W line

650.2' to

Olive St.

MOUND STREET

S 59 deg. 27' W 300.00'

CERTIFICATION

I hereby certify that the hereon platted parcel was surveyed to acceptable survey standards and that the linear error in closure does not exceed 0.02 feet.

Roger E. Thompson
Roger E. Thompson, PS #6552



THOMPSON SURVEYING
2005 DEER RUN LANE
LONDON, OHIO 852-4345

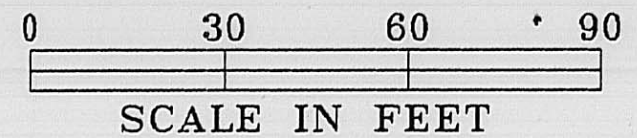

May, 1988

32-90!!