

VILLAGE OF
PLAIN CITY

Ernestine Eversole $\frac{1}{2}$ Interest
Life Interest
19.60
D.B. 154 pg. 151

Linda K. Clay
PARCEL 2 0.36
Total = 0.4413 by deed & tax duplicate
Deed BK 275 pg. 211
Hse #10835

PARCEL 1
0.0818

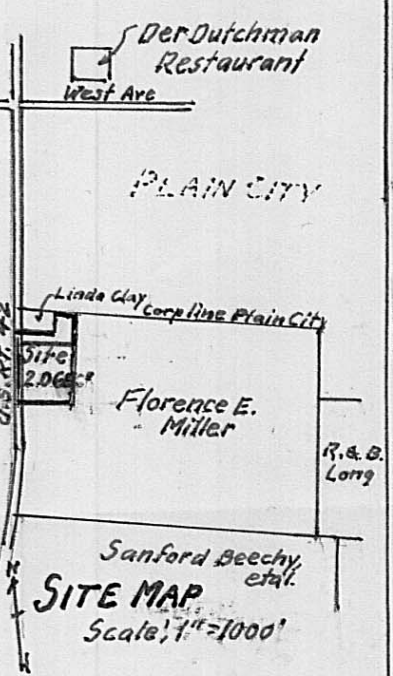

Florence E. Miller
41,559[±] includes
2,7696[±]
Deed Bk. 230 pg. 218



U.S. ROUTE
No. 42
300.00
N. 03° 55' 00\"/>

SURVEY OF 2.0662[±] TRACT
Also Showing location of Buildings & Facilities
VIRGINIA MILITARY SURVEY No. 7064
DARBY TWP. MADISON COUNTY OHIO
Scale, 1" = 30'
Start, 1930

Reference; Being part a 41,559[±] tract as conveyed to Florence E. Miller by certificate of transfer in the matter of the Estate of Charles F. Miller, deceased as shown of record in Deed Book 230, page 218.

Bearings are based on bearings of centerline of U.S. Route 42 by Ohio Dept. of Transportation Road Plans.

$\frac{3}{4}$ " new iron pipe used for corners

F. K. Harvey
Registered Surveyor No. 2570
Tel. 614-877-3293

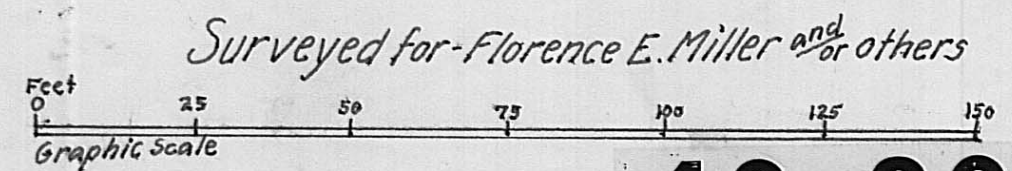

40-90