

PAUL R. AND ETHEL E. WIGHTMAN,
39.502 ACRE TRACT,
D.V. 283, PG. 501

SCALE 1" = 50'
DATE 6-20-91

U.S. ROUTE # 42 (60')

(ASSUMED BEARING)
N 13° 15' 00" E
300.00'

2.500 ACRES

PART OF PAUL R. AND
ETHEL E. WIGHTMAN'S
39.502 ACRE TRACT
D.V. 283, PG. 501

PLACE OF
BEGINNING

V.M.S. 8439
V.M.S. 7070

N 87° 03' 45" W
368.96'

N 87° 03' 45" W
P/L
1908.92'

CENTRAL OHIO JOINT VOCATIONAL SCHOOL DISTRICT
BOARD OF EDUCATION, 148.19 ACRES,
D.V. 212, PG. 339

O.D.O.T. R/W
MON. FOUND

REFERENCE DEEDS SHOWN HEREON

BEARINGS INDICATED HEREON ARE BASED ON
AN ASSUMED MERIDIAN WITH ALL OTHERS
BASED ON ANGLES ONLY.

LEGEND

- 5/8" IRON PIN SET WITH
CAP MARKED "CLAPPSADDLE, R.S. #6140"
- RAILROAD SPIKE SET
- ⊙ 1/2" IRON PIPE FOUND

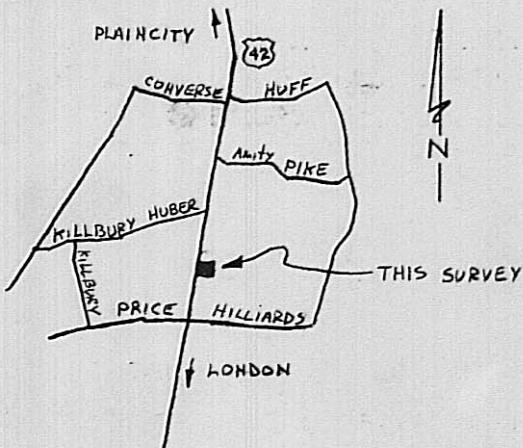

VICINITY MAP (NOT TO SCALE)

SURVEY FOR PAUL WIGHTMAN

STATE OF OHIO, COUNTY OF MADISON,
TOWNSHIP OF CANAAN, V.M.S. # 8439
BEING PART OF PAUL R. AND ETHEL E.
WIGHTMAN'S 39.502 ACRE TRACT
DESCRIBED IN D.V. 283, PG. 501

I HEREBY CERTIFY THAT THIS PLAT WAS
PREPARED FROM AN ACTUAL FIELD SURVEY
AND THAT MONUMENTS WERE PLACED AS INDICATED.

Paul R. Clapsaddle

PAUL R. CLAPSADDLE, R.S. # 6140
19019 WEST DARBY ROAD
MARYSVILLE, OHIO 43040
(513) 747-2599

