

1 INCH = 400 FEET



RICHARD M. BIDWELL  
D.B. 270, P.462  
THIRD TRACT  
79.46 ACRES

VERNON MILLER et al  
D.B.218, P.215  
132.73 ACRES

SPIKE SET  
IN CONCRETE  
CULVERT

VMS 6000  
VMS 2985

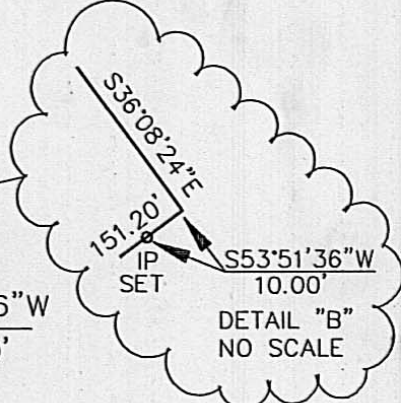
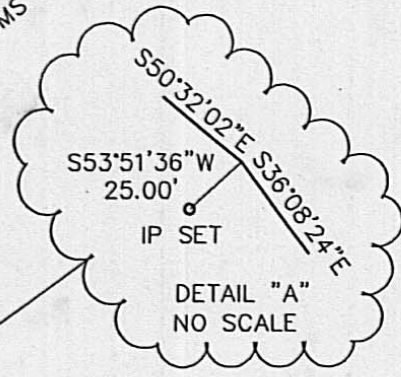

N52°54'47\"/>

S50°32'02\"/>

S36°08'24\"/>

STONE FD.  
1' NW OF  
END POST

68.561  
ACRES

N37°33'08\"/>

S37°33'08\"/>

VERNON & ALICE  
MILLER  
D.B. 253, P.652  
66.77 ACRES

EXISTING  
FENCE

S70°35'00\"/>

Reference  
Beginning  
SPIKE  
FD.

GOODSON RD. 60' R/W

THOMAS & ROBIN GREEN  
42 Acres  
D.B. 276, P.63

Iron pins set are 5/8" x 30" rerod with ID cap stamped "ELSWICK RS 6395"

SURVEY FOR: <b>RICHARD T. BIDWELL</b>		LOCATION: VMS 2985 Jefferson Twp.
PROJECT: Survey of a 68.561 Acre Tract		COUNTY: Madison
DATE: 11/08/93		STATE: Ohio
SCALE: 1"=400'		REVISIONS: 12/04/93

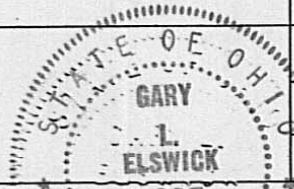

THIS PLAT REPRESENTS THE RESULTS OF A FIELD SURVEY MADE IN NOVEMBER 1993. ALL MONUMENTS SHOWN HEREON EXIST AND MEASUREMENTS ARE CORRECT TO THE BEST OF MY KNOWLEDGE.

GARY L. ELSWICK REGISTERED SURVEYOR #6395

DRAWING NO.  
**107-93**

Being a 68.561 acre tract out of an original 79.46 acre tract of record in Deed Book 270, page 462 (third tract) of the Recorder's records, Madison County, Ohio and being in VMS 2985 in the Township of Jefferson, the County of Madison and the State of Ohio, said 68.561 acre tract being more particularly described as follows:

Beginning, for reference, at a spike found marking the northwesterly corner of a 42 acre tract of record in Deed Book 276, page 63 of said Recorder's records;

thence North 70° 35' 00" East, in the centerline of Goodson Road, to a spike set marking the PLACE OF BEGINNING at the most southerly corner of the 68.561 acre tract herein described and said 79.46 acre tract;

thence North 37° 33' 08" West 2021.23 feet, in an existing fence line and the easterly line of a 66.77 acre tract of record in Deed Book 253, page 652 of said Recorder's records and in the westerly line of said 79.46 acre tract, to a stone found one foot northerly of a fence end post;

thence North 52° 54' 47" East 1318.98 feet, in the southerly line of a 132.73 acre tract of record in Deed Book 218, page 215 of said Recorder's records and the northerly line of said 79.46 acre tract, to an iron pin set in the center of Lucas ditch;

thence South 50° 32' 02" East 536.01 feet, in the center of said Lucas ditch, to an angle point of said ditch referenced by an iron pin set at South 53° 51' 36" West 25.00 feet;

thence South 36° 08' 24" East 630.57 feet, in the center of said ditch, to a point referenced by an iron pin set at South 53° 51' 36" West 10.00 feet;

thence South 53° 51' 36" West 151.20 feet, passing said reference pin set at 10.00 feet, to an iron pin set;

thence South 37° 33' 08" East 1278.39 feet, to a spike set in the centerline of Goodson Road and being South 70° 35' 00" West 254.29 feet from a spike found marking an angle point in said centerline;

thence South 70° 35' 00" West 1339.18 feet, in the centerline of Goodson Road, to the place of beginning containing 68.561 acres more or less and being as shown on the plat attached hereto and made a part hereof.

Bearings are assumed and for the determination of angles only. Iron pins set are 5/8 inch by 30 inch reinforcing rod with identification cap stamped "ELSWICK RS6395".

Subject to all legal highways, restrictions and easements of record and zoning ordinances and regulations.