

PLAT OF SURVEY FOR:
THE JUDSON LUMBER COMPANY
DARBY TOWNSHIP - VMS 775B-7830
MADISON COUNTY, OHIO
VILLAGE OF PLAIN CITY
DEED RECORD 282, PG 493

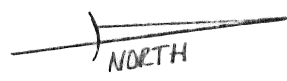

- NOTES:
- 1) SCALE 1" = 60'
 - 2) O.I.P. SET ARE 3/4" X 30" GALV. PIPE W/ PLASTIC I.D. CAP
 - 3) ● I.P. FOUND
 - 4) ● P.K. NAIL FOUND
 - 5) BEARINGS BASED ON ASSUMED REF. (E MAPLE STREET S 6° 12' 00" W)

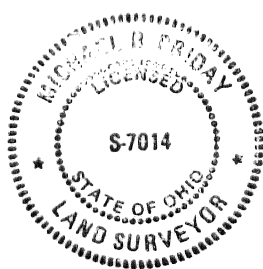

Michael R. Priday
MICHAEL R. PRIDAY L.S.
S-7014 APRIL 12 1993
JN 93-12

I HEREBY CERTIFY THAT THIS PLAT WAS PREPARED FROM AN ACTUAL FIELD SURVEY AND MONUMENTS WERE SET AS INDICATED.

PRIDAY SURVEYING INC.

327 NORTH MAIN STREET P.O. BOX 192
MARYSVILLE, OHIO 43040-0192
(513) 642-3400

44-93

Real estate situated in Darby Township of Madison County, Ohio; in the Virginia Military Survey Number 7758-7830 in the Village of Plain City; being part of the 5.199 acre tract of The Judson Lumber Company, Deed Record 282, page 493, and being further bounded and described as follows:

Beginning for reference at an iron pin found in the west right-of-way of Maple Street (previously Railroad Street) in the line between VMS 7758-7830 and VMS 7064 and at the northeast corner of Lot 16 of Dominy's Addition, Plat Book 1 page 127. Thence with said west line of Maple Street (40' wide) North 6 -12'-00" East (assumed bearing) 61.00 feet to an iron pipe found at the southeast corner of The Judson Lumber Company 5.199 acre tract, Deed Record 282, page 493. Said iron pipe being the true place of beginning.

Thence with three consecutive lines of said 5.199 acre tract (previously being the south right-of-way of Consolidated Railroad Corp.) North 65 -49'-52" West 319.96 feet to an iron pipe found, North 0 -10'-08" East 57.42 feet to an iron pipe found and North 65 -49'-52" West 61.89 feet to an iron pipe set. Said iron pipe being 50.00 feet (measured perpendicular) from the centerline of the north track of the previously removed railroad.

Thence North 22 -29'-44" East 72.02 feet to an iron pipe set. Said iron pipe being 22.00 feet (measured perpendicular) from the centerline of the said north track.

Thence parallel with and 22.00 feet from said centerline of railroad South 65 -49'-52" East 366.95 feet to an iron pipe found in the west line of aforesaid Maple Street. Said iron pipe also being the southeast corner of Arther Wesner 0.086 acre tract, Deed Record 282, page 780.

Thence with the west line of Maple Street South 6 -12'-00" West 130.83 feet to the true place of beginning.

Bearing (South 6 -12'-00" West) assumed from centerline of Maple Street. The tract as described from an actual field survey performed on or about April 12, 1993, by Registered Surveyor Michael R. Priday (S-7014), contains 1.013 acres, more or less, subject to all previous easements and rights-of-way of record. All iron pipes set are 3/4" x 30" galvanized pipe with yellow survey caps. The survey is recorded in the office of the Madison County Engineer.

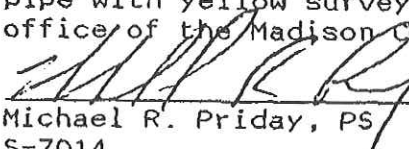
Michael R. Priday, PS
S-7014

Date: April 13, 1993
JN: 93-12