

SURVEY OF RECORD  
 LOCATED IN VIRGINIA MILITARY SURVEY NO. 8582,  
 VILLAGE OF SOUTH SOLON, MADISON COUNTY, OHIO  
 CONTAINING 0.1629 ACRES

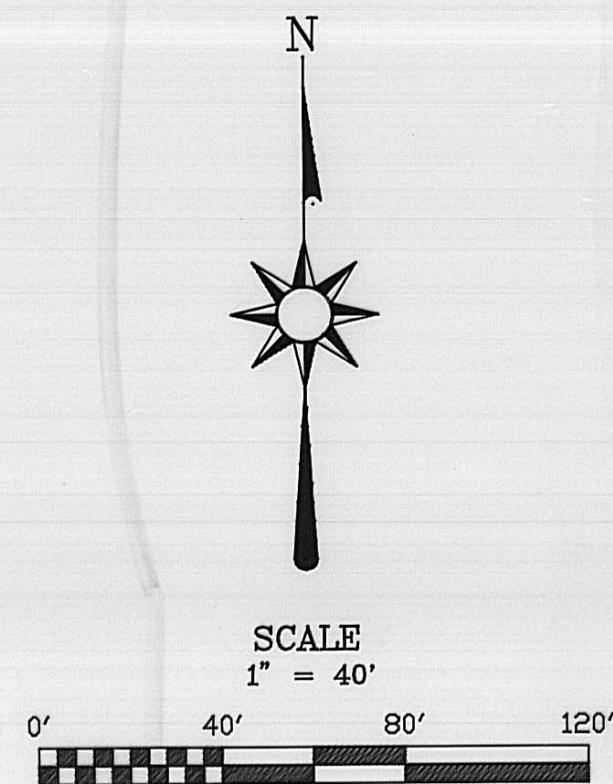
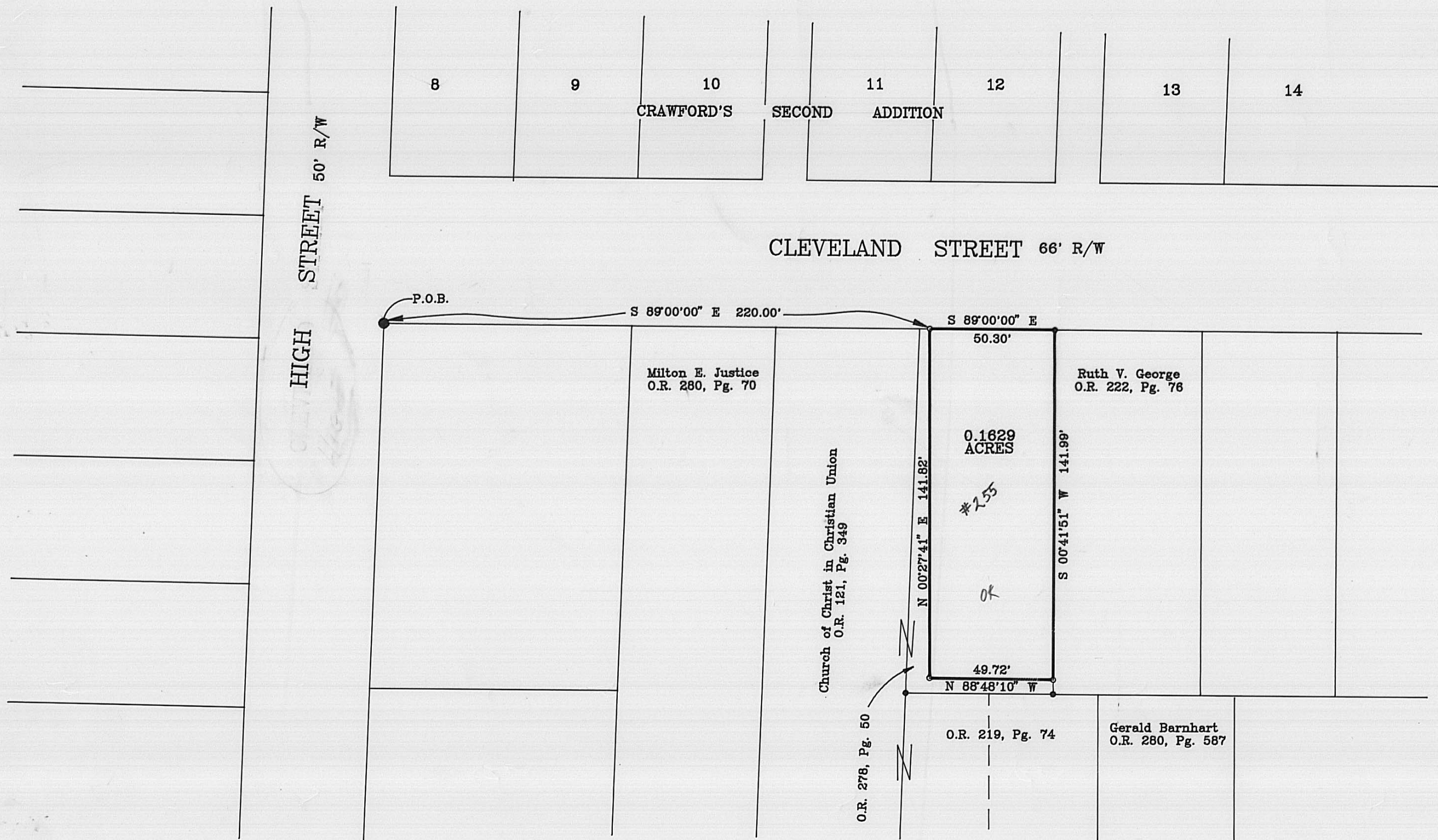

- = I.P. Set
- = I.P. FD.

NOTE:  
 The reference bearing fro this survey is S 89°00'00" E,  
 which is the bearing for the southerly line of Cleveland Street  
 as determined by deed recorded in Volume 121, Page 349 of the  
 Deed Records of Madison County, Ohio

All Iron Pins Set are 3/4" smooth dowell-rods with identifying  
 yellow surveyor caps.

Prepared By,  
 Louis A Green and Associates  
 894 North Detroit Street  
 Xenia, Ohio 45385

Prepared For,  
 Church of Christ in Christian Union  
 7220 East Main Street  
 South Solon, Ohio 45135



South Solon Map

49-96-96

*Louis A. Green*  
 Louis A. Green  
 Registered Surveyor No. 6147

5/14/95  
 Date



Located in Virginia Military Survey Number 8582, Village of South Solon, Madison County, Ohio, and being further described as follows:

Beginning at the point of intersection of the east line of High Street with the southerly line of Cleveland Street, thence in an eastwardly direction with the southerly line of Cleveland Street on a bearing of south eighty-nine degrees no minutes no seconds ( $89^{\circ}00'00''$ ) east for a distance of two hundred twenty and no/100 (220.00) feet to an iron pin set at a new division line by this survey, said pin being the true point of beginning for the tract herein described;

thence continuing in an eastwardly direction with said southerly line of Cleveland Street on the last described course for a distance of fifty and 30/100 (50.30) feet to an iron pin set at the northwest corner of land conveyed to Ruth V. George, by deed recorded in Volume 222, Page 76, of the Official Records of Madison County, Ohio;

thence in a southwardly direction with the westerly line of said George land on a bearing of south no degrees forty-one minutes fifty-one seconds ( $00^{\circ}41'51''$ ) west for a distance of one hundred forty-one and 99/100 (141.99) feet to an iron pin set, said pin being at a new division line by this survey;

thence in a westwardly direction with said new division line on a bearing of north eighty-eight degrees forty-eight minutes ten seconds ( $88^{\circ}48'10''$ ) west for a distance of forty-nine and 72/100 (49.72) feet to an iron pin set;

thence in a northwardly direction continuing with a new division line on a bearing of north no degrees twenty-seven minutes forty-one seconds ( $00^{\circ}27'41''$ ) east for a distance of one hundred forty-one and  $82/100$  ( $141.82$ ) feet to the true point of beginning containing  $1629/10000$  ( $0.1629$ ) acres and being subject to all easements and roadways of record.

The above described tract is part of land conveyed to the Church of Christ in Christian Union, by deed recorded in Volume 278, Page 50, of the Deed Records of Madison County, Ohio.

The reference bearing for this survey is south eighty-nine degrees no minutes no seconds ( $89^{\circ}00'00''$ ) east which is the bearing for the southerly line of Cleveland Street as determined by deed recorded in Volume 121, Page 349, of the Deed Records of Madison County, Ohio.

The above description is based on a field survey conducted by Louis A. Green, Registered Surveyor Number 6147, State of Ohio, completed June 29, 1995.