

BEARINGS BASED ON THE ϕ OF U. S. 42 (N 66°53' E)
AS DESCRIBED IN VOL. 267, PG. 298.

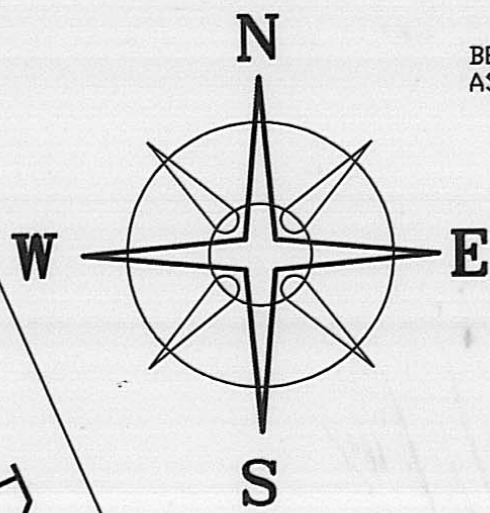

DEED REFERENCE

MADISON COUNTY SENIOR CITIZENS' CENTER, INC.
VOL. 79, PG. 267
1.89 ACRES

(677)

MADISON COUNTY SENIOR CITIZENS' CENTER, INC.
VOL. , PG.
1.1659+/- ACRES

(B)

MADISON LANDMARK INC.
VOL. 228, PG. 73
1.75 AC.
(558)
(556)

US 42

DEGER DR.

3.0472+/- ACRES

1.8813+/- ACRES

ACRES

1.1659+/- ACRES

(B)

CITY OF LONDON
UNION TOWNSHIP

JAMES A. MABE ET. AL.
VOL. 242, PG. 357
0.678 AC.

MARTHA J. MABE
VOL. 267, PG. 298
5.327 ORIG. ACRE

(645)

CON RAIL

10' EASEMENT FOR DRAINAGE PIPE
D. B 153, PG. 611

HOUSE TO BE TORN DOWN

NEW 10' DRAINAGE EASEMENT
EXTENDED TO PROPOSED DITCH

AS SHOWN ON RR DWG. BY
RICHARD THOMAS FEB. 8, 1995
FOR THE OHIO TO ERIE
TRAIL FUND

LEGEND

- IRON PIPE (FOUND)
- △ WOOD FENCE POST (FOUND)
- ⬡ 5/8" ϕ REBAR & YELLOW PLASTIC CAP STAMPED "COTTRILL 6858" (SET)

ALL MONUMENTS FOUND OR SET ARE IN GOOD CONDITION UNLESS OTHERWISE NOTED.

○ TAX MAP PARCEL NUMBER

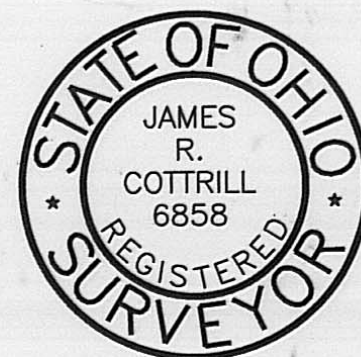

JAMES R. COTTRILL P.S.

8256 S.R. 207 N.E. MT. STERLING, OHIO 43143 PH. (740) 869-3811

3.0472± ACRES, VMS 8742,
CITY OF LONDON, UNION TWP.,
MADISON COUNTY, OHIO.
SURVEYED FOR SENIOR CITIZENS

I HEREBY CERTIFY THAT THIS PLAT DEPICTS
AN ACTUAL FIELD SURVEY PERFORMED BY
JAMES R. COTTRILL P.S. #6858

James R. Cottrill DATE: 6-10-99

DATE DRAWN:
4-14-99
JOB #S990412A
F. B. # FILE

SCALE : 1" = 50'
50' 25' 0' 50'

CREW: RC, MW
DWN. BY: RC
CK. BY:

100.00'

Description of a 3.0472 acre tract
Surveyed for the Senior Citizens

The following described 3.0472 acre tract is situated in the State of Ohio, Madison County, Union Township and in the City of London, being all of a 1.89 acre tract conveyed to Madison County Senior Citizens Center, Inc. by Volume 79 Page 267, also being all of a 1.1659 acre tract conveyed to the Madison County Senior Citizens Center, Inc. by Volume _____ Page _____ and being more particularly described as follows:

Beginning at a point in the centerline of U.S. 42 said point being the northeast corner of said 1.89 acre tract and the northwest corner of a 1.75 acre tract conveyed to Madison Landmark Inc. by Volume 228 Page 73;

Thence, with the line between said 1.75 and 1.89 acre tracts South 22 deg. 17 min. 06 sec. East, passing an iron pin and cap set at 32.08 feet, a total distance of 324.08 feet to an iron pin and cap set in the north line of the old Conrail

Thence, with said North line South 64 deg. 15 min. 40 sec. West passing an iron pin and cap set at the southern corner common to said 1.89 and said 1.1659 acre tracts at 253.00 feet, a total distance of 403.00 feet to an iron pin and cap set corner to a 5.327 original acre tract conveyed to Martha J. Mabe by Volume 267 Page 298 being the southwest corner of said 1.1659 acre tract

Thence, with said line North 20 deg. 58 min. 45 sec. West, passing an iron pin and cap set at 312.70 feet, a total distance of 342.72 feet to a point in the centerline of U.S. 42

Thence, with said centerline North 66 deg. 53 min. 00 sec. East, passing the northern corner common to said 1.89 acre tract and said 1.1659 acre tracts at 150.00 feet, a total distance of 394.50 feet, returning to the point of beginning containing 3.0472 acres more or less, of which 1.4808 acres is in the City of London, and 1.5664 acres is in Union Township, also 1.8813 acres is all of said 1.89 acre tract, and 1.1659 acres is all of said 1.1659 acre tract;

Bearings are based on the centerline of U.S. 42 (North 66 deg. 53 min. East) as described in Volume 267 Page 298.

Also subject to a 10 foot drainage easement as recorded in Plat Book 153 Page 611 and shown on plat accompanying this description.

This deed is subject to and with the benefit of all legal highways, restrictions, easements, limitations, and reservations, of record, if any and to zoning restrictions which have been imposed thereon, if any.

All iron pins set are 5/8 inch diameter rebar with yellow plastic caps stamped "Cottrill 6858."

This description is based on a field survey performed April 14, 1999 by James R. Cottrill registration #6858.

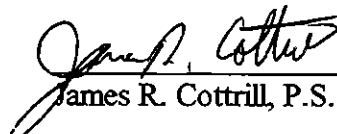
James R. Cottrill, P.S.