

**LEGEND SYMBOLS**  
 P = PROPERTY LINE  
 RW = RIGHT OF WAY  
 VMS = VIRGINIA MILITARY SURVEY LINE  
 P.P.N. = AUDITOR'S PERM. PAR. N°  
 I.C.H. = INTER COUNTY HIGHWAY DESIGNATION (O.D.O.T.)  
 --- = PRIVATE LANE OR DRIVEWAY  
 --- = PUBLIC ROADWAY  
 --- = EXISTING DRAINAGE SWALE (Low)  
 Low = TYPICAL LOW AREA - WATER PONDING AREA (TEMPORARY STANDING RETENTION ONLY) IT DRIES UP

**NOTE: SEE LISTING OF PROPERTY OWNERSHIP FOR AERIAL PARCELS SHOWN RECORD DATA - ACRES - OTHER DATA TAX MAP 46/107**  
 BASIS FOR BEARINGS: S09°E - 2701 FEET OR 0067 PG. 0694  
 MARKERS SET ARE 5/8" REBAR AND 3/4" PIPE CAPS - R. BAKER S-5539  
**56.5059 ACRES IN VMS 9231 AND 29.6183 ACRES IN VMS 5652**

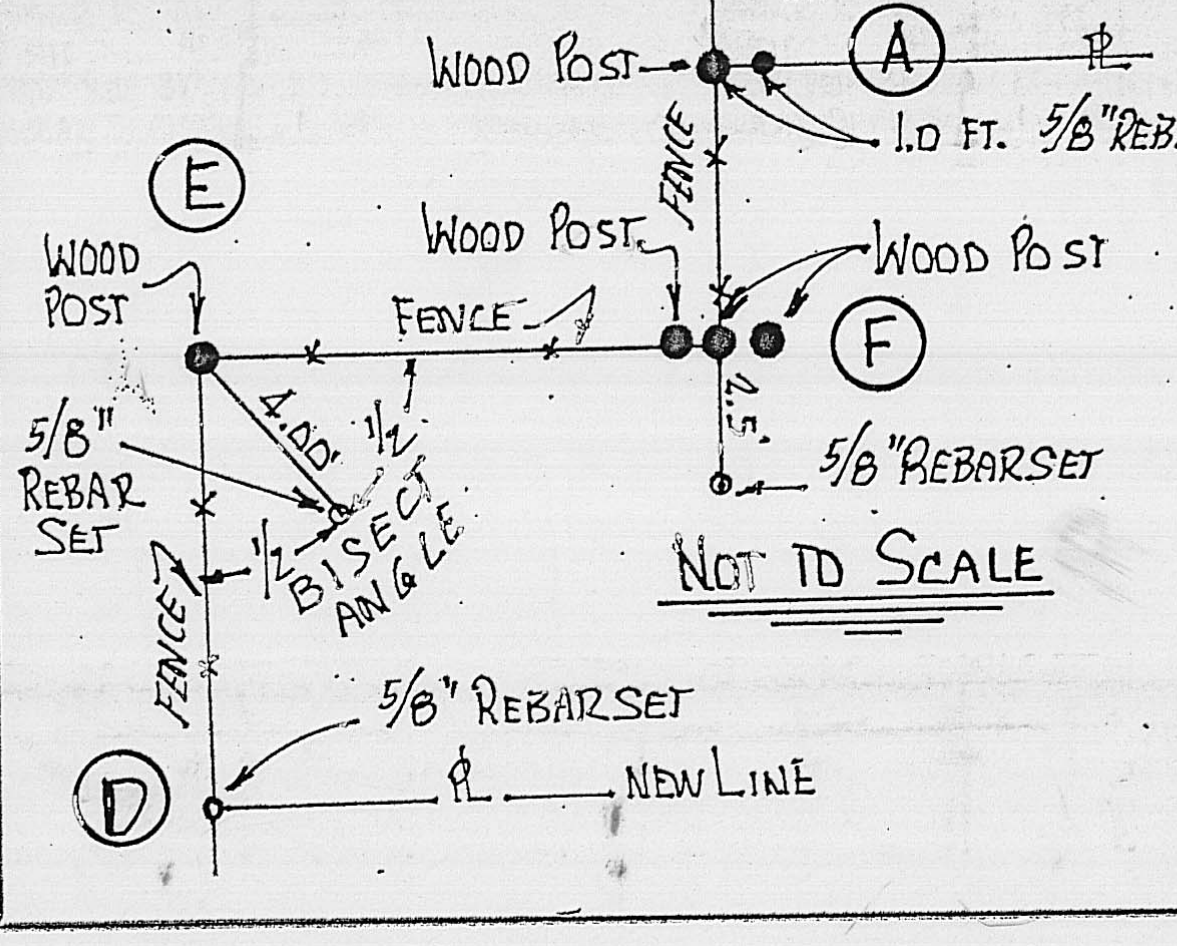
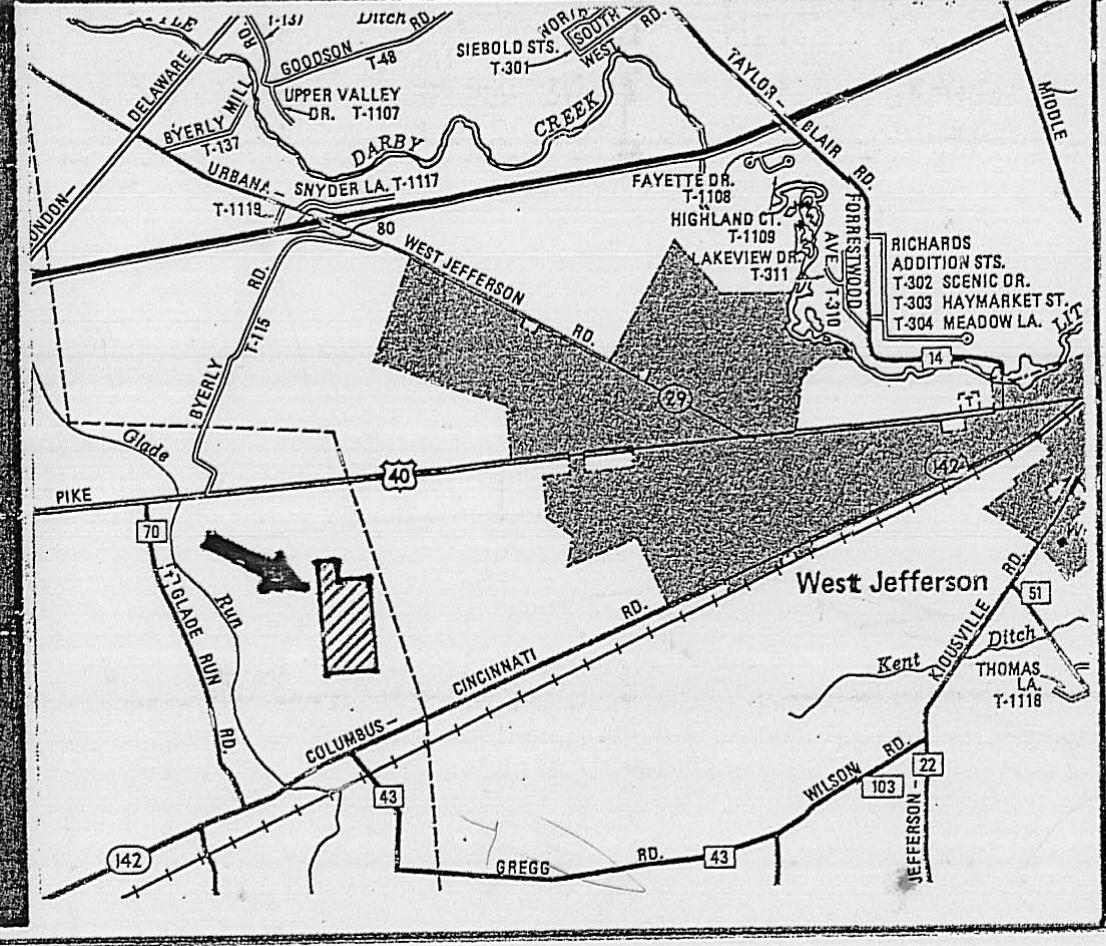
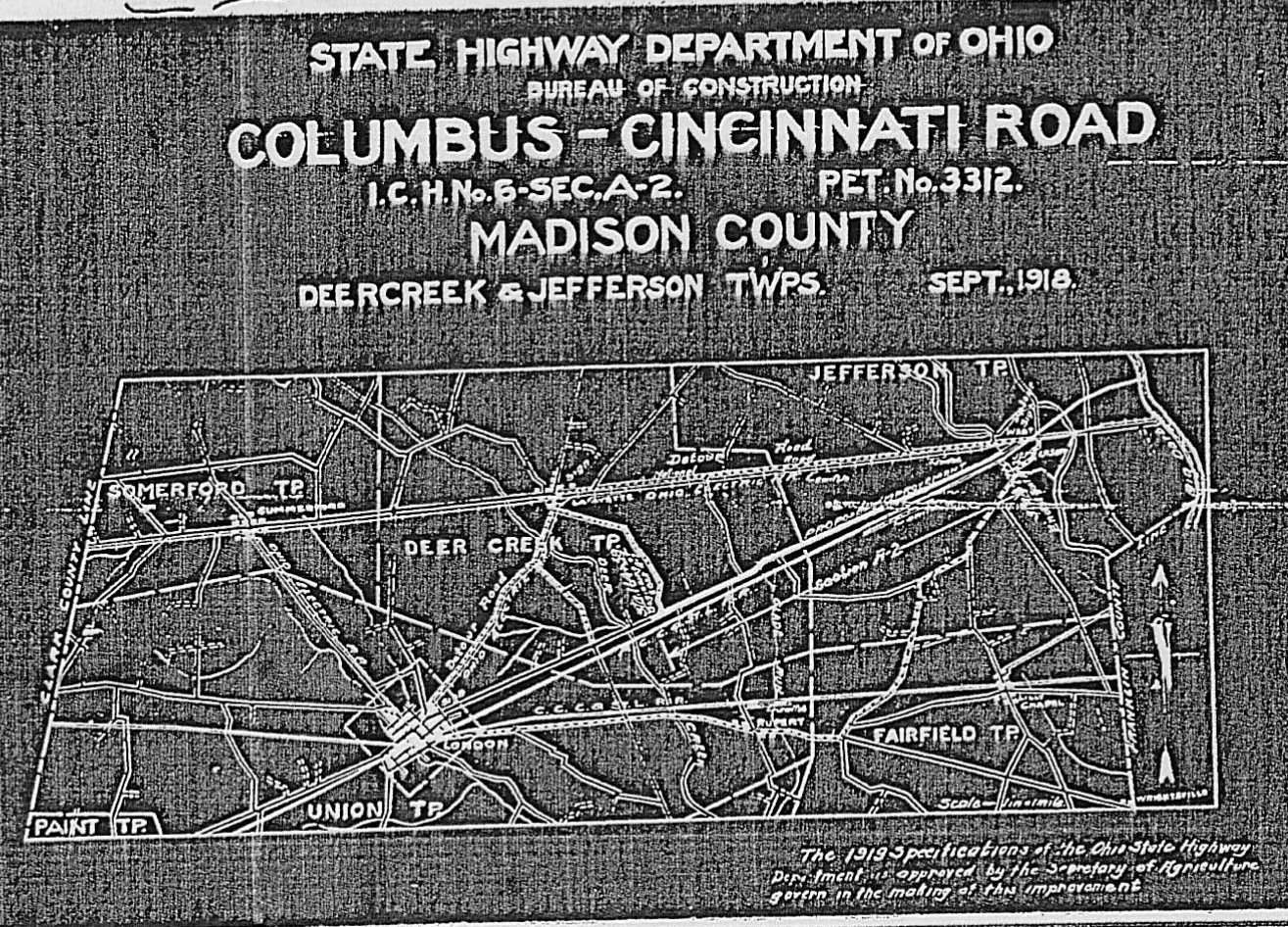

Property boundary description of 86.1242+ acres of land of which 59.5059 acres are in VMS 9231 and 29.6183 acres are in VMS 5652 all within Deer Creek Civil Township, Madison County, State of Ohio and its aerial parcels 281 & 282 and a part of aerial parcel 279 (see aerial tax map 46/107)... said 86.1242+ acres is one fourth of those total 344.497 acres described in Official Record Vol. 106 at Pages 230 through 234 Kirk K. Miller, Trustee, Trust B... said 86.1242+ acres having been surveyed in April, 2000 by Rodger Irwin Baker, Ohio surveyor # S-005539 and is bounded and more particularly described as follows:

From a metal monument box found in the middle of Gregg Road (Co. Rd. # 43) and in the centerline of State Route # 142 at I.C.H. 6 Sec. "A-2" station 275+19 (aka Columbus-Cincinnati Road and aka London-West Jefferson Turnpike)... go then with the center of State Route # 142 N 64 deg 34 min 00 sec E 1346.50 feet to station 289+65.5 and the southerly corner of 122.75 acres belonging to Kirk K. Miller and Susan M. Miller O R 0067 at Pg. 0694... said point being the southeasterly corner of 10.43 acres belonging to Raymond P. Keeton Tract 3 O R 0098 at Pg. 1621... then with a wire fence and boundary between Miller and Keeton N 09 deg 13 min W 1512.0 feet to a set 5/8 inch rebar at the base of a wood corner post and fence corner; then again with a wire fence between Miller and Keeton (passing a wood corner post and property corner of Keeton at 319.50 feet) and passing through a set 5/8 inch rebar at 321.50 feet... N 68 deg 52 min W 409.69 feet to a set 5/8 inch rebar at the true point of beginning;

Thence: With a new survey boundary line S 80 deg 34 min 14 sec W 1327.761 feet to a steel 5/8 inch rebar set;

Thence: N 09 deg 00 min 00 sec W 3154.751 feet to a set 5/8 inch rebar in a wire fence and northerly boundary of the Miller farm and being on the boundary between VMS 5652 and VMS 12143;

Thence: Following said VMS boundary and existing fence N 80 deg 33 min 33 sec E 372.396 feet to a wood corner post... a fence corner and corner to National Road Golf Course and corner to VMS 5652 (a 5/8 inch rebar set 4.0 feet south-west on the 1/2 bisect of the interior angle for a point of reference);

Thence: Following a wire fence and line of National Road Golf Course and easterly boundary of VMS 5652 S 09 deg 23 min 18 sec E 458.325 feet to an end post between two other wood posts... being the corner of VMS 9231, 5652 and 12143 (a 5/8 inch rebar set as a reference only at 2.5 feet S 80 deg 34 min 14 sec W from said true corner post);

Thence: Following the fence and VMS boundary between VMS 9231 and VMS 12143 and the northerly line of Miller farm... the southerly line of National Road Golf Course, N 80 deg 34 min 14 sec E 832.246 feet to a wood end post... former fence corner and being the northwesterly corner to the aforementioned 122.75 acres of Kirk K. Miller and Susan M. Miller; (cited herein)

Thence: Following the westerly line of said 122.75 acres... a former fence but now removed... (passing through a set 5/8 inch rebar at 1.00 foot) S 09 deg 00 min 00 sec E 2696.485 feet to the true point of beginning. This last call being the basis for bearings used in this description... adapted to O R 0067 Pg. 0694.

Containing within said bounds a total of 86.1242+ acres of land. Bearings derived from O R 0067 at Pg. 0694.

Highway stations taken from year 1918 roadway plans for former Inter County Highway # 6 Section A-2 (see O.D.O.T. Library Micro film roll # 2). See sheet 7 of 23.

Markers set are 5/8 inch diameter steel rebar cut 30 inches long with plastic caps stamped R.I. Baker S-5539. There are no buildings at the present time... strictly a cultivated field with a low-depressed drainage swale and subsurface tile main running through this property.

This description is based on a recent field survey made by the undersigned.

*Rodger Irwin Baker* April 21, 2000  
 Rodger Irwin Baker Ohio surveyor licensed and registered # S-005539  
 1300 Plain City-Georgesville Road (South)  
 Gallows, Ohio 43119 Phone 614-879-6004

AERIAL PARCEL NUMBER	ACRES	TITLE	RECORD
279	276.9270	KIRK K. MILLER TRUSTEE 1/2, ZYRETTA B. MILLER, IRREVOCABLE TRUST 1/2	OR 106 Pg. 230
281	22.7000	SAME TITLE AS PARCEL N° 279 BUT IN VMS 9231	OR 106 Pg. 230
282	51.9700	SAME TITLE AS PARCEL N° 279 LOCATED IN VMS 9231	OR 106 Pg. 230
314	33.0400	JAMES V. PEARSON 1/2 AND CAROLINE H. PEARSON 1/2 VMS 6482	D.B. 219 Pg. 038
380	106.3600	LARRY ROTHWELL VMS 6644	Vol. 266 Pg. 016
280	15.0000	SAME TITLE AS PARCEL N° 279 BUT IN VMS 6644	OR 106 Pg. 230
9231	10.4900	RAYMOND P. KEETON VMS 9231, 5652, 12143	OR 098 Pg. 1621
284	72.1700	KIRK K. MILLER AND SUSAN M. MILLER VMS 12128, 9231, OR 67 Pg. 694	OR 64 Pg. 1133
280	13.5000	PATRICIA A. TONZI	OR 64 Pg. 1133
229	17.0600	PATRICIA A. TONZI - USE NATIONAL ROAD GOLF COURSE	OR 64 Pg. 1133
231	DEER CREEK TWP. 54.0600	PATRICIA A. TONZI	OR 64 Pg. 1133
321	45.9000	PATRICIA A. TONZI VMS 12143	OR 064 Pg. 1133
529	47.0000	KIRK K. MILLER AND SUSAN M. MILLER VMS 9131 & 12128	OR 67 Pg. 694
285	0.2800	SAME TITLE AS PARCEL N° 284 BUT IN VMS 5652	OR 67 Pg. 694
125	3.3000	KIRK K. MILLER AND SUSAN M. MILLER VMS 12128	OR 67 Pg. 694
411	28.7264	EARL EMERSON WISE AND BETTY A. WISE 64 1/2 VMS 5652	SEE PLAN 81, 98 88, 88, 82

I CERTIFY THAT DURING THE MONTH OF APRIL YEAR 2000 I DID PERSONALLY MAKE A BOUNDARY SURVEY FOR KIRK K. MILLER, KENNETH DALE MILLER AND OTHERS AND DID SET PINS OR PIPES AT THE CORNERS THERE OF. THE FIELD SURVEY CONTAINS 86.124 ACRES OR ONE FOURTH OF THE REPORTED 344.497 ACRES CITED IN DEED RECORDED IN OFFICIAL RECORD VOL. 0106 AT PAGES 230, 231, 232, 233 AND 234. RECORDED DECEMBER 01, 1999 AT 09:58 A.M. THIS INSTRUMENT N° 1999 0000 9127 NAMES MR. KIRK K. MILLER, AS TRUSTEE, TRUST "B" FAMILY TRUST UNDER ARTICLE II, LAST WILL AND TESTAMENT OF DELMAR K. MILLER WHO BECAME DECEASED JAN. 28, 98. KIRK K. MILLER'S RESIDENCE ADDRESS 5781 S.R. 142 W. JEFFERSON, O. 43162 DEED DESCRIPTION APPROVED BY CO. ENGR'S OFFICE (JOHN BULL) 11-19-99 (798.99) IN MY OPINION THIS PLAN DEPICTS THE LANDS AND BOUNDARY LIMITS.

*Rodger Irwin Baker* PS APRIL 21 ST. 2000  
 BY: RODGER IRWIN BAKER - SURVEYOR  
 OHIO LICENSE AND REGISTRATION N° S-005539

**PLAT OF 86.124 ACRES, NEW BOUNDARY SURVEY BEING IN VMS 5652 AND IN VMS 9231. LOCATED IN DEER CREEK CIVIL TOWNSHIP MADISON COUNTY STATE OF OHIO SURVEYED FOR KIRK K. MILLER, AND OTHERS ABUTTING 122.75 ACRES OWNED BY KIRK K. MILLER AND SUSAN M. MILLER OR 067 PG. 694. 696 SURVEYED IN APRIL VR. 2000 SCALE: AS SHOWN**

Property boundary description of 86.1242+ acres of land of which 59.5059 acres are in VMS 9231 and 29.6183 acres are in VMS 5652 all within Deer Creek Civil Township, Madison County, State of Ohio and is aerial parcels 281 & 282 and a part of aerial parcel 279 ( see aerial tax map 46 / 107 )...said 86.1242+ acres is one fourth of those total 344.497 acres described in Official Record Vol. 106 at Pages 230 through 234 Kirk K. Miller, Trustee, Trust B.....said 86.1242+ acres having been surveyed in April, 2000 by Rodger Irwin Baker, Ohio surveyor # S-005539 and is bounded and more particularly described as follows:

From a metal monumnet box found in the middle of Gregg Road ( Co. Rd. # 43 ) and in the centerline of State Route # 142 at I.C.H. 6 Sec. "A-2" station 276+19 ( aka Columbus-Cincinnati Road and aka London-West Jefferson Turnpike )...go then with the center of State Route # 142 N 64 deg 34 min 00 sec E 1346.50 feet to station 289+65.5 and the southwesterly corner of 122.75 acres belonging to Kirk K. Miller and Susan M. Miller O R 0067 at Pg. 0694...said point being the southeasterly corner of 10.43 acres belonging to Raymond P. Keeton Tract 3 O R 0098 at Pg. 1621...then with a wire fence and boundary between Miller and Keeton N 09 deg 13 min W 1512.0 feet to a set 5/8 inch rebar at the base of a wood corner post and fence corner; then again with a wire fence between Miller and Keeton ( passing a wood corner post and property corner of Keeton at 319.50 feet and passing through a set 5/8 inch rebar at 321.50 feet.... N 68 deg 52 min W 409.50 feet to a set 5/8 inch rebar at the true point of beginning;

Thence: With a new survey boundary line S 80 deg 34 min 14 sec W 1327.761 feet to a steel 5/8 inch rebar set;

Thence: N 09 deg 00 min 00 sec W 3154.751 feet to a set 5/8 inch rebar in a wire fence and northerly boundary of the Miller farm and being on the boundary between VMS 5652 and VMS 12143;

Thence: Following said VMS boundary and existing fence N 80 deg 33 min 33 sec E 372.396 feet to a wood corner post..a fence corner and corner to National Road Golf Course and corner to VMS 5652 ( a 5/8 inch rebar set 4.0 feet southwest on the 1/2 bisect of the interior angle for a point of reference );

Thence: Following a wire fence and line of National Road Golf Course and easterly boundary of VMS 5652 S 09 deg 23 min 18 sec E 458.325 feet to an end post between two other wood posts...being the corner of VMS 9231, 5652 and 12143 ( a 5/8 inch rebar set as a reference only at 2.5 feet S 80 deg 34 min 14 sec W from said true corner post );

Thence: Following the fence and VMS boundary between VMS 9231 and VMS 12143 and the northerly line of Miller farm...the southerly line of National Road Golf Course, N 80 deg 34 min 14 sec E 952.246 feet to a wood end post...former fence corner and being the northwesterly corner to the aforementioned 122.75 acres of Kirk K. Miller and Susan M. Miller; ( cited herein )

Thence: Following the westerly line of said 122.75 acres...a former fence but now removed...( passing through a set 5/8 inch rebar at 1.00 foot ) S 09 deg 00 min 00 sec E 2696.485 feet to the true point of beginning. This last call being the basis for bearings used in this description...adapted to O R 0067 Pg. 0694.

Containing within said bounds a total of 86.1242+ acres of land. Bearings derived from O R 0067 at Pg. 0694.

Highway stations taken from year 1918 roadway plans for former Inter County Highway # 6 Section A-2 ( see O.D.O.T. Library Micro film roll # 2 ). See sheet 7 of 23.

Markers set are 5/8 inch diameter steel rebar cut 30 inches long with plastic caps stamped R.I.Baker S-5539. There are no buildings at the present time..strictly a cultivated field with a low-depressed drainage swale and subsurface tile main running through this property.

This description is based on a recent field survey made by the undersigned.

Rodger Irwin Baker April 21, 2000

Rodger Irwin Baker Ohio surveyor licensed and registered # S-005539  
1300 Plain City-Georgesville Road ( South )  
Galloway, Ohio 43119 Phone 614-879-6004

