

CONRAIL

CONRAIL

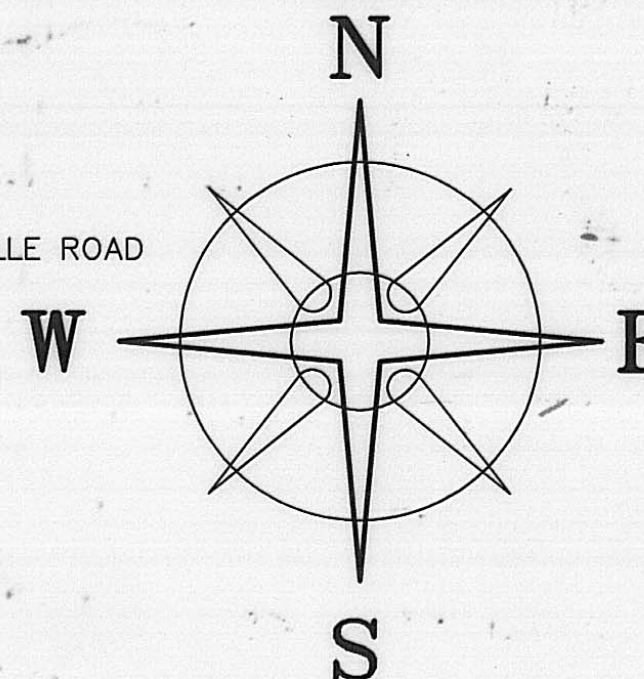

BEARINGS BASED ON THE \odot OF LILLY CHAPEL GEORGESVILLE ROAD (S 84°45'E) AS DESCRIBED IN O.R. 66, P. 817.

NEIL E. & LORETTA CONKEL VOL. 278, P. 133 0.468 AC. (346)

NEIL E. & LORETTA CONKEL VOL. 278, P. 133 1.95 AC. (522)

MORRIS D. & LIGAYA G. LILLY VOL. 237, P. 20 1.37 AC. (537)

MICHAEL KIM SWATSLER O.R. 93, P. 67 0.2306 AC. (469)

GROVER C. MORRIS VOL. 158, P. 448 0.27 AC. (412)

0.5723± ACRES

NOTE
0.5723± ACRE TRACT IS TO BECOME PART OF AND CONTINGENT TO SWATSLER'S 0.2306 ACRE TRACT.
DEED REFERENCE
GERTRUDE M. STONE
O.R. 66, P. 817
5.216 ACRES

LEGEND

- 6" SQ. CONCRETE FENCE POST (FOUND)
 - 3/4" IRON PIPE (FOUND)
 - ⊕ 3/4" IRON TEE BAR & CAP (FOUND)
 - 1" DIA. SOLID IRON PIN (FOUND)
 - △ 1" ϕ PIPE & YELLOW PLASTIC CAP STAMPED "PLUMMER 7595" (FD.)
 - RAIL ROAD SPIKE (FOUND)
 - ☆ HARROW TOOTH (SET)
 - 5/8" ϕ REBAR & YELLOW PLASTIC CAP STAMPED "COTTRILL 6858" (SET)
- ALL MONUMENTS FOUND OR SET ARE IN GOOD CONDITION UNLESS OTHERWISE NOTED.
- TAX MAP PARCEL NUMBER



JAMES R. COTTRILL P.S.

8256 S.R. 207 N.E. MT. STERLING, OHIO 43143 PH. (740) 869-3811

0.5723± ACRES, VMS 5280,
FAIRFIELD TOWNSHIP, VILLAGE OF
LILLY-CHAPEL, MADISON CO., OHIO.
SURVEYED FOR MICHAEL SWATSLER

DATE DRAWN: 8/14/01	SCALE : 1" = 50'	CREW: MW,EM
JOB #S010805	50' 25' 0 50'	DWN. BY: RC
F. B. # 28		CK. BY:

I HEREBY CERTIFY THAT THIS PLAT DEPICTS AN ACTUAL FIELD SURVEY PERFORMED BY JAMES R. COTTRILL P.S. #6858
James R. Cottrill DATE: 8-16-01

99-01

**Description of a 0.5723 Acre Tract
Surveyed for Michael Swatsler**

The following described 0.5723 +/- acre tract is situated in the State of Ohio, Madison County, Village of Lilly Chapel, Fairfield Township, VMS 5280, and being part of a 5.216 acre tract conveyed to Gertrude M. Stone by Official Record 66 Page 817, and being more particularly described as follows:

Beginning at an iron pin and cap set at the southwest corner of said 5.216 acre tract, said iron pin and cap also being the southeast corner of a 1.37 acre tract conveyed to Morris D. & Ligaya G. Lilly by Volume 237 Page 20, said iron pin also being in the north line of a 0.2306 acre tract conveyed to Michael Kim Swatsler by Official 93 Page 67.

Thence with the west line of said 5.216 acre tract North 02 deg. 04 min. 46 sec. East, passing a 1" diameter solid iron pin found at the southeast corner of a 1.95 acre tract conveyed to Neil E. and Loretta Conkel by Volume 278 Page 133 at 123.18 feet, also passing a 1" iron pipe found at the southeast corner of a 0.468 acre tract also conveyed to Neil E. & Loretta Conkel by Volume 278 Page 133 at 364.56 feet, a total distance of 414.56 feet to a 6" square concrete fence post found in the south line of ConRail.

Thence with the south line of said ConRail South 87 deg. 00 min. 32 sec. East a distance of 60.01 feet to an iron pin and cap set in said line.

Thence across said 5.216 acre tract South 02 deg. 04 min. 46 sec. West a distance of 416.37 to a harrow tooth set in concrete in the north line of a 0.27 acre tract conveyed to Grover C. Morris by Volume 158 Page 448.

Thence with said north line North 85 deg. 17 min. 15 sec. West, passing a 1" iron pipe and yellow plastic cap stamped "Plummer 7595" found at the northern corner common to said Morris's 0.27 and said Swatsler's 0.2306 acre tracts at 46.59 feet, a total distance of 60.06 feet, returning to the point of beginning, containing 0.5723 +/- acres more or less.

Bearings are based on the centerline of Lilly Chapel-Georgesville Road (South 84 deg. 45 min. East) as described in Official Record 66 Page 817.

This deed is subject to and with the benefit of all legal highways, restrictions, easements, limitations, and reservations, of record, if any and to zoning restrictions which have been imposed thereon, if any.

All iron pins set are 5/8 inch diameter rebar with yellow plastic caps stamped "Cottrill 6858."

This description is based on a field survey performed August 14, 2001 by James R. Cottrill registration #6858. (Job # S010805)

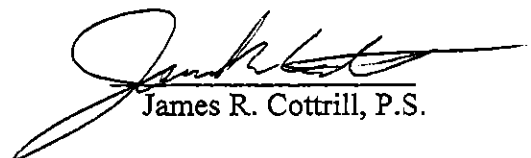
James R. Cottrill, P.S.