

This plat shows a 1.963 acre split from an 85.362 property and combines the split with a 6.396 acre lot to make an 8.359 acre lot.

LOCATION: Located in Virginia Military Survey 3900, Somerford Township, Madison County, Ohio, on the north side of Arbutle Road across the road from the intersection of Gwynne Road.

PRIOR DEED REFERENCE: Deed Book 290, Page 366, Madison County Recorder's Office.

OWNER: Hobart H. Neiswander

BASIS OF BEARING: Centerline of Arbutle Road as established by prior deed reference.

SURVEYOR: Casey Elliott, PS 7759, State of Ohio  
 212 West High Street  
 London, Ohio 43140  
 (740)852-1300

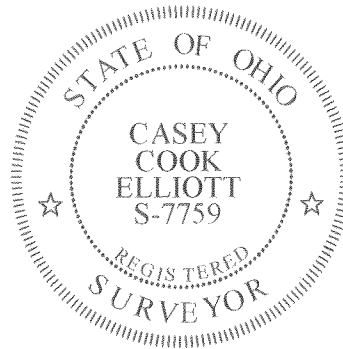

CERTIFICATION: I certify that this plat and the description developed from it meets the MINIMUM STANDARDS FOR BOUNDARY SURVEYS IN OHIO, as described in Chapter 4733-37 of the Ohio Administrative Code. This plat and the description were developed from an actual field survey performed in October, 1999.

*Casey Elliott*  
 Casey C. Elliott, PS 7759, State of Ohio

December 17, 2001

27-02

**EXHIBIT A**  
**Description of a 8.359 Acre Lot**  
**In Somerford Township, Madison County, Ohio**

This description is for a 1.963 acre split from an 85.362 acre property and combined with a 6.396 acre lot to form an 8.359 acre lot. The 85.362 acre property is in the name of Neiswander Family Farms LLC, an Ohio Limited Liability Company (Official Records 99, Page 1120, Madison County Recorder's records) and the 6.396 acre property is in the name of Hobart H. Neiswander (Deed Book 290, Page 366). The lot is located in Virginia Military Survey 3900 on the north side of Arbuckle Road (40 foot Right-of-Way) on the west side of the north extension of Gwynne Road in Somerford Township, Madison County, Ohio, and is further described as follows:

Beginning at an iron pin found buried at the intersection of Gwynne Road and Arbuckle Road, said point is the TRUE POINT OF BEGINNING;

thence N63°30'04"W, 968.57, along the centerline of Arbuckle Road, passing the southwest corner of the said Neiswander Lot at 701.29 feet to a point in the centerline of Arbuckle Road, said point is 657.04 feet along the same bearing from an iron pin found buried in the centerline of Arbuckle Road and the west line of the said Neiswander Family Farms LLC property;

thence N24°06'11"E, 390.60, into the said Neiswander Family Farms property to an iron pin set, passing an iron pin set at 30.00 feet;

thence S63°14'13"E, 171.61, to an iron pipe found with a plastic identification cap labeled *RET 6552* at the northwest corner of the said Neiswander lot;

thence S62°45'44"E, 796.97, to an iron pin set at the northeast corner of the said Neiswander lot, passing an iron pipe found with a cap labeled *RET 6552* at 790.11 feet;

thence S24°01'25"W, 76.08, along the east line of a property in the name of Bige and Tania G. Brock (OR.0060, PG.1215) along a wire fence to a point at the northeast corner of a cemetery (Madison County Cemetery Book, Page 62);

thence N65°58'35"W, 88.00, to a point that is N59°45'52"E, 7.72 feet, from a wood post found;

thence S24°01'25"W, 102.00, to a point that is N81°27'51"E, 2.75 feet, from a wood post found;

thence S65°58'35"E, 88.00, to a point in the west line of the said Brock property, said point is S79°49'24"E, 1.81 feet, from a wood post found;

thence S24°01'25"W, 201.46, along the west line of the said Brock property, passing a 5/8" steel pin with an identification cap labeled *COTTRILL PS6858*, to the TRUE POINT OF BEGINNING.

Said lot contains 8.359 acres and is subject to all easements and rights-of-way of record. The BASIS OF BEARINGS is the centerline of Arbuckle Road as established in Deed Book 290, Page 366. All monuments set are 5/8 inch diameter steel rebar with plastic identification caps labeled *ELLIOTT PS7759*. This description is based on a survey performed on October 19, 2001, by Casey Elliott, PS7759 State of Ohio. This survey and description meet the MINIMUM STANDARDS FOR BOUNDARY SURVEYS IN OHIO, as described in Chapter 4733-37 of the Ohio Administrative Code.