

BEARINGS BASED ON THE WEST LINE OF ENGLE'S 140.773 ACRE TRACT (S 10°58'E) AS SHOWN ON SCIOTO FARM UNITS 12 & 13 RECORDED IN TOWN PLAT RECORD VOL. 1, PG. 272.



**DEED REFERENCE**

- (A) JAMES D. AND JUDITH E. RHEINSCHELD  
O.R. 121 PAGE 762  
56.4494 ACRES  
(1212)
- (B) JAMES D. AND JUDITH E. RHEINSCHELD  
O.R. PAGE  
4.0000 ACRES
- (C) ROBERT L. & VIRGINIA L. ENGLE, TRUSTEES  
O.R. 100, PG. 1073  
55.666 ACRES  
(207)

**LEGEND**

- ⊙ 4" IRON PIPE FENCE POST (FOUND)
  - 2 1/2" IRON PIPE & CAP (FOUND)
  - ⊕ 3/4" IRON TEE BAR & CAP (FOUND)
  - SOLID IRON PIN (FOUND)
  - △ RECORD CORNER STONE (FOUND)
  - RAIL ROAD SPIKE
  - MAG NAIL (SET)
  - 5/8" REBAR & YELLOW PLASTIC CAP STAMPED "COTTRILL 6858" (SET)
- ALL MONUMENTS FOUND OR SET ARE IN GOOD CONDITION UNLESS OTHERWISE NOTED.
- TAX MAP PARCEL NUMBER

LINE	BEARING	DISTANCE
L1	N 87°52'59" W	43.96'
L2	N 87°52'59" W	65.90'
L3	N 04°48'41" E	8.14'
L4	N 25°53'04" E	131.71'
L5	S 85°06'34" E	126.93'
L6	S 06°09'38" E	143.01'
L7	N 77°45'00" E	188.32'
L8	N 87°52'19" W	131.13'

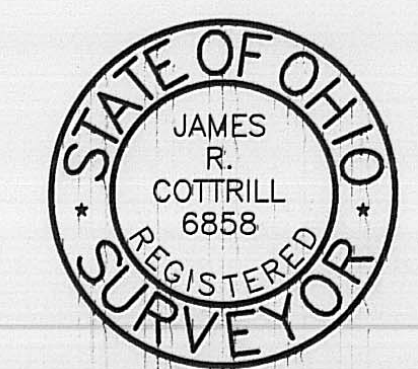

I HEREBY CERTIFY THAT THIS PLAT DEPICTS AN ACTUAL FIELD SURVEY PERFORMED BY JAMES R. COTTRILL P.S. #6858  
DATE: 6-6-02

**JAMES R. COTTRILL P.S.**  
8256 S.R. 207 NE MT. STERLING, OHIO 43143 PH. (740) 869-3811

PLAT OF  
**VMS 3972,**  
PLEASANT TOWNSHIP,  
MADISON COUNTY, OHIO.

DATE DRAWN: 5-22-02  
JOB#S020517  
F.B. # 30

SCALE: 1" = 200'  
200' 100' 0' 200'

CREW: MW,JB,RR  
DWN. BY: RC  
CK. BY:



20.1581 acres  
Surveyed for Bob Engle

The following described 20.1581 acre tract is situated in the state of Ohio, Madison County, Pleasant Township, VMS 3972, and being part of a 55.666 acre tract conveyed to Robert L. and Virginia L. Engle, Trustees by official record 100 page 1073 and be more particularly described as follows:

Beginning at a mag nail previously set in the centerline of State Route 323 (60 ft. right-of-way) at the southeast corner of a 56.4494 acre tract conveyed to James D. and Judith E. Rheinscheld by official record 121 page 762

Thence, with the east line of said 56.4494 acre tract the following two courses:

- 1) North 22 deg. 18 min. 56 sec. West, passing an iron pin cap set at 27.46 feet, a total distance of 1169.15 feet to an iron and cap set
- 2) North 00 deg. 04 min. 55 sec. West a distance of 59.27 feet to an iron pin cap set at the southwest corner of a 4.0000 acre tract conveyed to James D. and Judith E. Rheinscheld by official record , Page

Thence, with the south line of said 4.0000 acre tract, North 84 degrees 52 min. 42 sec. East a distance of 693.88 feet to an iron pin cap set at the southeast corner of said 4.0000 acre tract and in the west line of a 24.6593 acre tract survey by this surveyor February 2001 and not record to date

Thence, with the west line of said 24.6593 acre tract, South 22 deg. 18 min. 56 sec. East, passing an iron pin cap previously set at 1306.43 feet, a total distance of 1333.94 feet to a mag nail set in the centerline of said state Route 323

Thence, with said centerline, the following two (2) courses:

- 1) North 87 deg. 36 min. 37 sec. West a distance of 710.29 feet to an iron pin found
- 2) North 87 deg. 52 min. 59 sec. West a distance of 43.96 feet, returning to the point beginning containing 20.1581 acres more or less.

Bearings based on the west line at Engle's 140.773 acre tract (South 10 deg. 58 min. East) as shown on Scioto Farm Units 12 and 13 recorded in Town Plat record Volume 1 Page 272.

This deed is subject to and with the benefit of all legal highways, restrictions, easements, limitations, and reservations, of record, if any and to zoning restrictions which have been imposed thereon, if any.

All iron pins set are 5/8 inch diameter rebar with yellow plastic caps stamped "Cottrill 6858."

This description is based on a field survey performed May 28, 2002 by James R. Cottrill registration #6858. (Job # S020517)

  
James R. Cottrill, P.S.

60.4494 acres  
Surveyed for Jim Rheinscheld

The following described 60.4494 acre tract is situated in the state of Ohio, Madison County, Pleasant Township, VMS 3972, and being all of a 56.4494 acre tract conveyed to James D. and Judith E. Rheinscheld by official record 121 page 762, also being all of a 4.0000 acre tract conveyed to James D. and Judith E. Rheinscheld by official record Page      and being more particularly described as follows:

Beginning at a mag nail previously set in the centerline of State Route 323 (60 ft. right-of-way) at the southeast corner of said 56.4494 acre tract

Thence, with said centerline, North 87 degrees 52 min. 59 sec. West a distance a 65.90 feet to a mag nail previously set in said centerline at the southeast corner of a 7.1450 acre tract conveyed to Robert L. and Virginia L. Engle, trustees by official record 100 page 1075

Thence, with the east line of said 7.1450 acre tract, North 22 deg. 18 min. 56 sec. West, passing a four inch diameter iron pipe fence post found at 25.73 feet, also passing an iron pin cap previously set at the southeast corner of a 11.0153 acre tract survey by this surveyor February 2001 not recorded to date at 433.59 feet a total distance of 1153.68 feet to an iron pin cap set

Thence, containing with said 11.0153 acre tract the following two courses:

- 1) North 00 deg. 04 min. 55 seconds West a distance of 339.18 feet to an iron pin cap set
- 2) South 84 degrees 52 min. 42 sec. West a distance of 368.41 feet to an iron pin cap set in the east line of a 48.651 acre tract conveyed to Joyce H. and David L. Jenkins by official record 135 Page 2328

Thence, with said 48.651 acre tract the following two courses:

- 1) North 10 deg. 58 min. 00 sec. West a distance of 1005.16 feet to a 2 1/2 inch iron pipe and cap found
- 2) North 25 deg. 33 min. 04 sec. East a distance of 131.71 feet to iron pin cap set at the southeast corner of a 108.1860 acre tract conveyed to Carl L. and Carolyn Walters by Volume 288 Page 344 also corner to a 103.65 acre tract conveyed to Robert L. Taylor by official record 54 Page 124

Thence, with said 103.65 acre tract the following 5 courses:

- 1) South 85 deg. 06 min. 34 sec. East a distance of 126.93 ft. to a 2 1/2 inch diameter iron pipe and cap found
- 2) South 06 deg. 09 min. 38 sec. East a distance of 143.01 feet to a 2 1/2 inch diameter iron pipe and cap found
- 3) North 77 deg. 45 min. 00 sec. East a distance of 188.32 feet to an iron pin cap set
- 4) North 77 deg. 27 min. 12 sec. East a distance a 1069.44 feet
- 5) North 81 deg. 26 min. 57 sec. East, passing a 2 1/2 inch diameter iron pipe and cap found at 5.00 feet, a total distance of 641.94 feet to a record corner stone found in the west line of a 220.4636 acre tract conveyed to George W. Lohstroh by official record 107 Page 579

Thence, with said west line, also with the west line of a 50 acre tract conveyed to James M. and Vicky L. Wilson by volume 404 Page 843, and also the west line of a 82.80 acre tract conveyed to James M. and Vicky L. Wilson by official record 14 Page 552, also being the line between VMS 3971 and 3972, South 22 deg. 12 min. 12 sec. East a distance of 1201.12 feet to an iron pin cap set at the north east corner of a 24.6596 acre tract conveyed to Martha J. Adams by official record 133 Page 2149

Thence, with the south line of said 56.4494 acre tract, South 84 degrees 52 min. 42 sec. West, passing an iron pin cap previously set at the northwest corner of said 24.6596 acre tract at 644.82 feet, a total distance of 1319.13 feet to an iron pin cap previously set at the

northern corner common two said 4.0000 acre tract and a 24.6593 acre tract survey by this surveyor February 2001 not recorded today

Thence, with said 4.0000 acre tract the following two courses:

- 1) South 22 deg. 18 min. 56 sec. East a distance of 285.10 feet to an iron pin cap set at the southeast corner of said Tract
- 2) South 84 degrees 52 min. 42 sec. West a distance of 693.88 feet to an iron pin cap previously set in the east line of a 60 foot laneway of said 56.4494 acre tract

Thence, with said laneway the following two courses:

- 1) South 00 degrees 04 min. 55 sec. East a distance 59.27 feet to an iron pin cap set
- 2) South 22 deg. 18 min. 56 sec. East, passing an iron pin cap previously set at 1141.69 feet, a total distance of 1169.15 feet returning to the point beginning containing 60.4494 acres more or less, of which 56.4494 acres more or less is all of said 56.4494 acre tract, and 4.0000 acres more or less is all of said 4.0000 acre tract

Bearings based on the west line at Engle's 140.773 acre tract (South 10 deg. 58 min. East) as shown on Scioto Farm Units 12 and 13 recorded in Town Plat record Volume 1 Page 272.

This deed is subject to and with the benefit of all legal highways, restrictions, easements, limitations, and reservations, of record, if any and to zoning restrictions which have been imposed thereon, if any.

All iron pins set are 5/8 inch diameter rebar with yellow plastic caps stamped "Cottrill 6858."

This description is based on a field survey performed May 28, 2002 by James R. Cottrill registration #6858. (Job # S020517A)

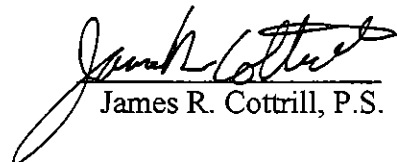
  
James R. Cottrill, P.S.