

BEARINGS BASED ON THE NORTH LINE OF RICHARDSON AVENUE
(S 55°30'W) AS DESCRIBED IN O.R. 124, P. 1539.

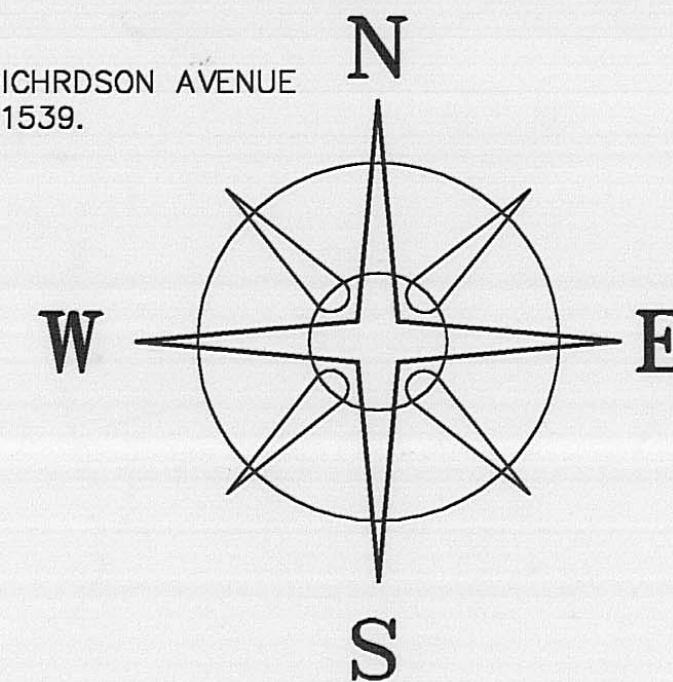

PENNSYLVANIA LINES, LLC RAILROAD

OLIVE STREET

WILLIAM M. JARRELLS
O.R. 33, P. 776
0.235 ACRES

RESTRICTION:

This 0.0075± acre parcel has been approved as an "ADJOINING PARCEL TRANSFER" and in the future shall be transferred only with the adjoining 0.054 acre tract, Parcel Number 457, as recorded in Deed Volume 289, Page 527, and shall not be used as a separate building site. This restriction shall run with the land and may be modified only upon the written approval of the Pickaway County Regional Planning Commission. A marginal entry shall be made on the above stated deed stating "See Volume _____, Page _____, for a restriction affecting this parcel."

DEED REFERENCE
WILLIAM R. & MARY BETH POTTS
O.R. 124, P. 1539
0.34 ACRES

0.3578± ACRES

0.0075± ACRES
SEE RESTRICTION

JIMMY & GANELLA D. CAIN
O.R. 124, P. 1847
0.25 ACRES

LEGEND

- ⊗ 6" WOOD FENCE POST (FOUND)
 - △ 2 1/2" METAL FENCE POST (FOUND)
 - 3/4" IRON PIPE (FOUND)
 - ⬡ 5/8" REBAR & YELLOW PLASTIC CAP STAMPED "COTTRILL 6858" (SET)
- ALL MONUMENTS FOUND OR SET ARE IN GOOD CONDITION UNLESS OTHERWISE NOTED.
- TAX MAP PARCEL NUMBER

RICHARDSON AVENUE (30')

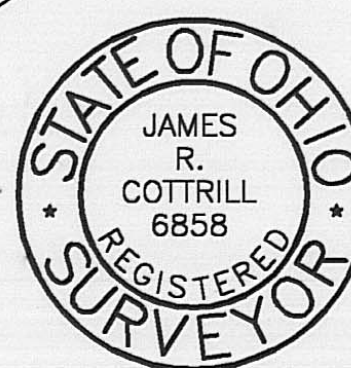

I HEREBY CERTIFY THAT THIS PLAT DEPICTS AN ACTUAL FIELD SURVEY PERFORMED BY JAMES R. COTTRILL P.S. #6858

James R. Cottrill DATE: 7-29-02

JAMES R. COTTRILL P.S.

8256 S.R. 207 N.E. MT. STERLING, OHIO 43143 PH. (740) 869-3811

0.3578± & 0.0076± ACRES,
VMS 8742, CITY OF LONDON,
MADISON COUNTY, OHIO.

SURVEYED FOR MARY BETH POTTS

DATE DRAWN:
7-26-02
JOB #S020719
F. B. # 30

SCALE : 1" = 20'
20' 10' 0' 20'

CREW: MW, EM
DWN. BY: JRC
CK. BY:

74-02

0.0075 acres
Surveyed for Mary Beth Potts

The following described 0.0075 acre tract is situated in the state of Ohio, Madison County, the City of London, VMS 8742, being part of a 0.34 acre tract conveyed to William R. and Mary Beth Potts by official record 124 Page 1539 and being more particularly described as follows:

Beginning at an iron pin and cap set in the north line of Richardson Avenue (30 feet wide) at the eastern most corner of said 0.34 acre tract also being the southernmost corner of a 0.054 acre tract conveyed to William E. M. Jarrells by Volume 289 Page 527;

Thence, with the north line of said Richardson Avenue, South 55 deg. 30 min. 00 sec. West a distance of 8.90 feet that iron pin cap set;

Thence, with a new line across said 0.34 acre tract, North 27 deg. 35 min. 26 sec. West a distance of 73.98 the to a ¾" iron pipe found at the southernmost corner of a 0.235 acre tract conveyed to William E. Jarrells by official record 33 Page 776 said pipe is also at the northwest corner of said 0.054 acre tract;

Thence, with the southwest line of said 0.054 acre tract, South 34 deg. 30 min. 00 sec. East a distance 73.44 feet returning to the point beginning containing 0.0075 acres more or less.

Bearings are based on the north line of Richardson Avenue (South 55 deg. 30 min. West) as described in official record 124 Page 1539.

The hereinabove described 0.0075 acre tract is to become part of and contingent to Jarrells 0.054 acre tract as described in Volume 289 Page 527.

This deed is subject to and with the benefit of all legal highways, restrictions, easements, limitations, and reservations, of record, if any and to zoning restrictions which have been imposed thereon, if any.

All iron pins set are 5/8 inch diameter rebar with yellow plastic caps stamped "Cottrill 6858."

This description is based on a field survey performed July 26, 2002 by James R. Cottrill registration #6858. (Job #S020719A)

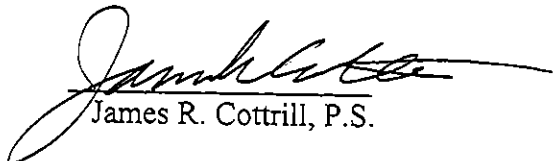
James R. Cottrill, P.S.

0.3578 acres
Surveyed for Mary Beth Potts

The following described 0.3578 acre tract is situated in the state of Ohio, Madison County, the City of London, VMS 8742, being part of a 0.34 acre tract conveyed to William R. and Mary Beth Potts by official record 124 Page 1539 and being more particularly described as follows:

Beginning at a three-quarter inch iron pipe found in the north line of Richardson Avenue (30 feet wide) said iron pipe is at the southernmost corner of said 0.34 acre tract and the eastern most corner of a 0.25 acre tract conveyed to Jimmy and Ganella D. Cain by official record 124 Page 1847;

Thence, with the line between said 0.34 and 0.25 acre tracts, North 34 deg. 30 min. 00 sec. West a distance of 226.22 feet to an iron pin and cap set in the south line of the Pennsylvania Lines, LLC railroad;

Thence, with said railroad, North 64 deg. 11 min. 44 sec. East a distance of 72.94 feet to an iron pin cap set at the northwest corner of a 0.235 acre tract conveyed to William E. Jarrells by official record 33 Page 776;

Thence, with the line between said 0.34 and said 0.235 acre tracts, South 34 deg. 30 min. 00 sec. East a distance of 141.75 feet to a three-quarter inch iron pipe found at the northwest corner of a 0.054 acre tract conveyed to William and Jarrells by Volume 289 Page 527;

Thence, with a new line across said 0.34 acre tract, South 27 deg. 35 min. 26 sec. East a distance of 73.98 feet to an iron pin cap set in the north line of said Richardson Avenue;

Thence, with said Richardson Avenue, South 55 deg. 30 min. 00 sec. West a distance of 63.20 feet returning to the point beginning containing 0.3578 acres more or less.

Bearings are based on the north line of Richardson Avenue (South 55 deg. 30 min. West) as described in official record 124 Page 1539.

This deed is subject to and with the benefit of all legal highways, restrictions, easements, limitations, and reservations, of record, if any and to zoning restrictions which have been imposed thereon, if any.

All iron pins set are 5/8 inch diameter rebar with yellow plastic caps stamped "Cottrill 6858."

This description is based on a field survey performed July 26, 2002 by James R. Cottrill registration #6858. (Job #S020719)

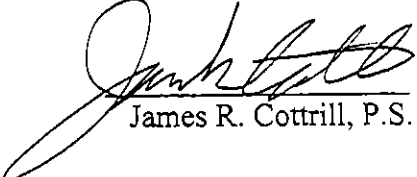
James R. Cottrill, P.S.