

BEING A PART OF VIRGINIA MILITARY SURVEY 8742, CITY OF LONDON, MADISON COUNTY, OHIO.
 BEING THE PROPERTY OF LUCILLE SNYDER OF DEED BOOK 271, PAGE 723 OF THE MADISON COUNTY RECORDER.

RESERVE "C"
 CHATFIELD SUBDIVISION
 SLIDE 587
 JAMES W. & NORMA J. HUFF
 O.R. BK. 54, PAGE 454
 PPN: 31-00739.000

P.O.B. TRACT "B" 0.1' ABOVE GRADE

TRACT "B"
 1.356 ACRES

JAMES W. & NORMA J. HUFF
 DEED BK. 204, PG. 418
 PPN: 31-01400.000

TRACT "A"
 0.643 ACRE

JAMES W. & NORMA J. HUFF
 DEED BK. 204, PG. 418
 PPN: 31-01400.000

JAMES W. & NORMA J. HUFF
 DEED BK. 204, PG. 418
 PPN: 31-01400.000



SURVEY FOR: DAVE HUME

0.64'
 0.3' ABOVE GRADE

(S 50°W 2.85 CHAINS) 194.70'
 N 50°00'00"E

N 36°30'00"W 47.52'
 (S 36°30'E 0.72 CHAINS)

(S 19°40'W 2.92 CHAINS) 192.41'
 N 19°38'19"E

N 50°00'00"E 294.88'
 S 50°00'00"W 294.88'

(N 50° E 3.22 CHAINS) 218.18'
 S 50°00'00"W

8.0'
 FRAME GARAGE

EXISTING RESIDENCE

GRAVEL DRIVE

4.3' X 85.0' + GRAVEL DRIVE ENCROACHMENT ONTO OTHERS.

R/W

S 33°20'00"E 220.00'

(N 33°20'W 5.00 CHAINS) 50' R/W

OLIVE STREET

S 33°20'00"E 110.00'

AT GRADE BENT

REFERENCES USED:
 COUNTY TAX MAPS
 DEED BOOKS & PAGES AS SHOWN.
 OFFICIAL RECORD BOOKS & PAGES AS SHOWN.
 SUBDIVISION PLAT SLIDE AS SHOWN.

BEARINGS ARE BASED ON THE
 SOUTHWEST LINE OF OLIVE STREET
 AS BEING N 33°20'W PER DEED
 BOOK 271, PAGE 723 AND ARE
 TO DENOTE ANGLES ONLY.
 PPN: 31-02812.000

LEGEND

- ☒ 5" X 5" STONE FOUND
- 5/8" BAR FOUND
- 6" X 8" RAILROAD TIE
- ⊗ 6" WOOD CORNER POST IN CONCRETE
- ⊗ PINS SET ARE 5/8" REBAR WITH PLASTIC CAPS LABELED R.E. HANKISON P.L.S. #7409 AND ARE SET AT GRADE UNLESS OTHERWISE SHOWN.
- ALL MONUMENTAIN FOUND IS IN GOOD CONDITION UNLESS OTHERWISE SHOWN.

Richard E. Hankison
 RICHARD E. HANKISON
 P.L.S. #7409
 DATE: 11-05-2003
 11-05-03

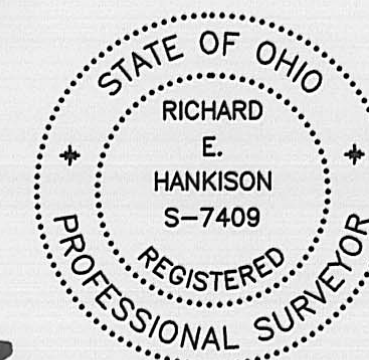

COPYRIGHT BY
RICHARD E. HANKISON SURVEYING
 620 NORTH FOUNTAIN AVENUE
 SPRINGFIELD, OHIO 45504
 937-323-8505
 FAX-937-323-7877

129-03

LEGAL DESCRIPTION
TRACT "A"
0.643 ACRE

Being a part of Virginia Military Survey 8742, City of London, Madison County, Ohio.
Being a part of the property of Lucille Snyder of Deed Book 271, page 723 of the
Madison County Recorder and being more particularly described as follows:
Beginning, for reference, at a stone found at the southwest corner of Reserve "C" of
Chatfield Subdivision of Slide 587 of the Madison County Recorder and in a east line of
the property of James W. and Norma J. Huff of Deed Book 204, page 418; Thence S
36°30'00"E 47.52 feet to a pin set; Thence S 19°38'19"W 192.41 feet to a wood corner
post; Thence S 70°20'00"E 85.54 feet to a pin set and being the principle place of
beginning of the parcel herein to be described;
Thence, leaving said Huff property with a new division line, N 50°00'00"E 294.88 feet to
a pin set in the southwest right-of-way line of Olive Street (50' R/W);
Thence, with the said road right-of-way, S 33°20'00"E 110.00 feet to a pin set at a
northeast corner of the said James W. and Norma J. Huff property;
Thence, leaving the road right-of-way with a northwest line of said Huff property, S
50°00'00"W 218.18 feet to a pin set;
Thence N 70°20'00"W 126.59 feet to the principle place of beginning. Containing 0.643
Acre, more or less and subject to all legal easements of record. Bearings are based on the
southwest line of Olive Street as being N 33°20'W per Deed Book 271, page 723 and are
to denote angles only. Pins set are 5/8" by 30" rebar with plastic caps labeled R.E.
Hankison P.L.S. #7409. The above description is based on the an actual field survey by
Richard E. Hankison P.L.S. #7409 on 11-05-2003. The above description is a part of
permanent parcel number 31-02612-000.



Richard E. Hankison
P.L.S. #7409
Date: 11-05-2003

11-05-03

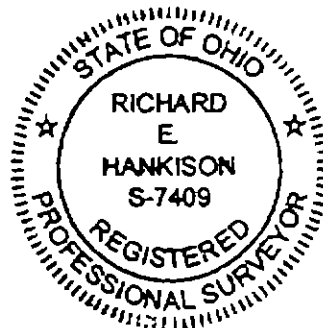

LEGAL DESCRIPTION
TRACT "B"
1.356 ACRE

Being a part of Virginia Military Survey 8742, City of London, Madison County, Ohio.
Being a part of the property of Lucille Snyder of Deed Book 271, page 723 of the
Madison County Recorder and being more particularly described as follows:
Beginning at a stone found at the southwest corner of Reserve "C" of Chatfield
Subdivision of Slide 587 of the Madison County Recorder and in a east line of the
property of James W. and Norma J. Huff of Deed Book 204, page 418;
Thence, with the a south line of said subdivision, N 50°00'00"E 194.70 feet to railroad tie
in the southwest right-of-way line of Olive Street (50' R/W), from said railroad tie a 5/8
inch bar found bears N 50°00'00"E 0.64 feet;
Thence, with the said road right-of-way, S 33°20'00"E 220.00 feet to a pin set;
Thence, leaving said road right-of-way with a new division line, S 50°00'00"W 294.88
feet to a pin set in a northeast line of said Huff property;
Thence, with the said Huff property, N 70°20'00"W 85.54 feet to a wood corner post;
Thence N 19°38'19"E 192.41 feet to a pin set;
Thence N 36°30'00"W 47.52 feet to the place of beginning. Containing 1.356 Acres,
more or less and subject to all legal easements of record. Bearings are based on the
southwest line of Olive Street as being N 33°20'W per Deed Book 271, page 723 and are
to denote angles only. Pins set are 5/8" by 30" rebar with plastic caps labeled R.E.
Hankison P.L.S. #7409. The above description is based on the an actual field survey by
Richard E. Hankison P.L.S. #7409 on 11-05-2003. The above description is a part of
permanent parcel number 31-02612-000.

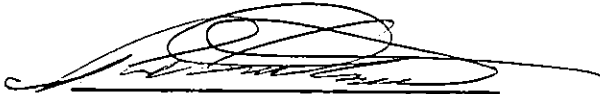

Richard E. Hankison
P.L.S. #7409
Date: 11-05-2003

