

LEGEND & SYMBOLS

- Δ = PROPERTY LINE
- --- = CENTERLINE
- R/W = RIGHT OF WAY
- --- LAND HOOK
- --- SAME OWNER
- REBAR = STEEL REINFORCE ROD
- 755 = AERIAL PARCEL NUMBER (TAX MAP)
- P.P.N. = PERMANENT PARCEL NUMBER (COUNTY AUDITOR)
- VMS = VIRGINIA MILITARY SURVEY (NUMBER)
- \odot = AT, --- = DIRECTION
- W.J. = WITHIN VILLAGE LIMITS
- TWP. = TOWNSHIP AREA

BEIN WITHIN N^o 49
MADISON COUNTY
OHIO
 IN JEFFERSON SCHOOL DISTRICT

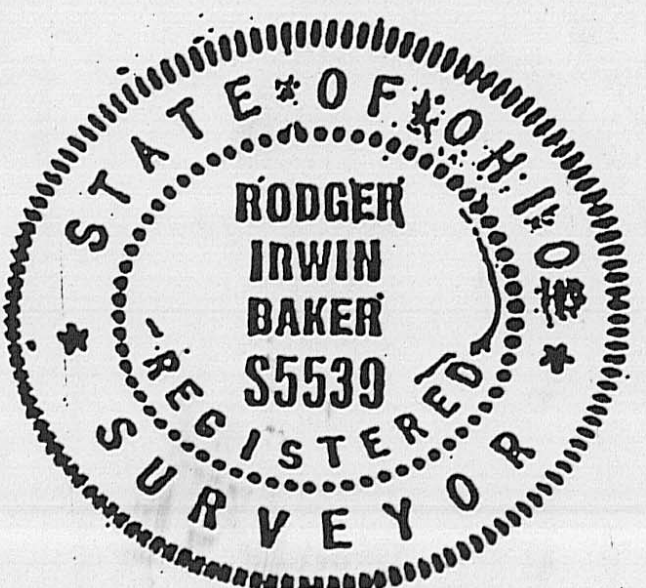

SURVEYOR'S STATEMENT:
 I CERTIFY THAT THIS PLAT IS BASED ON A CURRENT SURVEY.
 CORNERS ARE MARKED WITH STEEL REBAR, & MAG SPIKES.
 REBARS ARE CAPPED STAMPED "BAKER S.5539"
 BEARINGS DERIVED FROM \odot S.R. 29 O.R. 126 PG. 524

Rodger Irwin Baker L.L.S., P.S. NOVEMBER 16 TH., 2002
 RODGER IRWIN BAKER L.L.S. & P.S. REG. N^o S-005539
 1300 PLAIN CITY-GEORGESVILLE ROAD (SOUTH)
 GALLOWAY, OHIO 43119
 PHONE 614-879-6004

NANCY J. LOOBY - OWNER

PLAT

FIELD SURVEY OF LAND DIVISION

PLAT OF 7.68249 ACRES (7.682 AC.)
VMS 12143 JEFFERSON CIVIL TWP.
MADISON COUNTY, OHIO
FRONTING ALONG MIDDLE OF S.R. 29
PORTION OF P.P.N. 08.00549.000
PART OF AERIAL PARCEL N^o: 755

CAPPED REBARS SET @ CORNERS
 TOTAL = 405.450'
 S67° 05' 52" E

REBAR @ 13.550' REBAR @ 38.129'

Rd. R/W AREA = 0.27923 Ac.
 EXCLUDE R/W = 7.40326 Ac.
TOTAL AREA = 7.68249 AC.

EXISTING HOUSE AND FARM STRUCTURES (GRAIN BINS ETC.)
 HOUSE N^o 6010 S.R. 29 N.E. WEST JEFFERSON OHIO 43162

TOTAL DIST. 825.919' N 22° 45' 00" E

TOTAL DIST. S 22° 45' 00" W 824.841'

REBAR SET @ 30.000 FT. OFF & RD.

EXISTING BASE 31.019 FT. PIPE POST IN CONCRETE @ 31.019 FT. FROM \odot ROAD

EXISTING DRAIN TILE WORKING 8" MINIMUM

CLAY TILE IN WORKING CONDITION (DRAINING) 3' DEPTH

TWP. 755

P.P.N. 08.00549.000 AERIAL PARCEL N^o 755
 AERIAL MAP N^o 25 OF 107 VMS 12143
 AREA CITED 250 ACRES D.B. 222 PG. 55

NANCY J. LOOBY - OWNER
 (HER TAX MAILING ADDRESS = 6430 S.R. 29 N.E.)
 WEST JEFFERSON, OHIO 43162

MAG SPIKE SET @ 5149.627 N.W. FROM FD. SPIKE ORIGINAL \odot S.R. 40 (OLD NATIONAL RD.)
 POINT OF BEGINNING

LIBANA WEST JEFFERSON PIKE AKA ST. RTE. N^o 29 RIGHT OF WAY LINE

650.137' SPIKE FOUND @ 538.270'

ALONG CENTERLINE OF ROAD

CORP. LINE SPIKE FD. IN RD. \odot

36.357' TO I.P. EXISTING

TO U.S. RTE. 40

EXISTING I.P. FOUND @ 30.42' FROM \odot RD.

6.353 ACRES
 J.&L. ROTONDA LLC
 P.P.N. 10-01998.006
 O.R. 117 PG. 477
 PLAT REFERENCE 26-97

REFER TO YR. 1995 SURVEY OF 254.000 ACRES AND 151.549 ACRES KENNETH R. TUCKER, TRUSTEE THEN D.B. 267 PG. 511 & D.B. 186 PG. 239 VMS 12143 FOR SHUI-NAN AND CHIOU JEN CHUANG OWNERS CURRENTLY SEE PLAT 76-95 BASIS FOR BEARINGS DEPICTED BY GARY L. ELSWICK P.S. N^o 6395 FIRST CONSULTING LAND SURVEYORS SURVEYED OCTOBER 1995

W.J. 2091

P.P.N. 10-01010.000 AERIAL PARCEL N^o 2091 O.R. 126 PG. 524 (TRUSTEES)

2DBA W.J.

W.J. 1997

TRACT N^o 7
 JEFFERSON CIVIL TOWNSHIP
 CORPORATION OF WEST JEFFERSON - VILLAGE 1
 NANCY J. LOOBY - OWNER
 D.B. 222 PG. 0055
 TRACT N^o 3

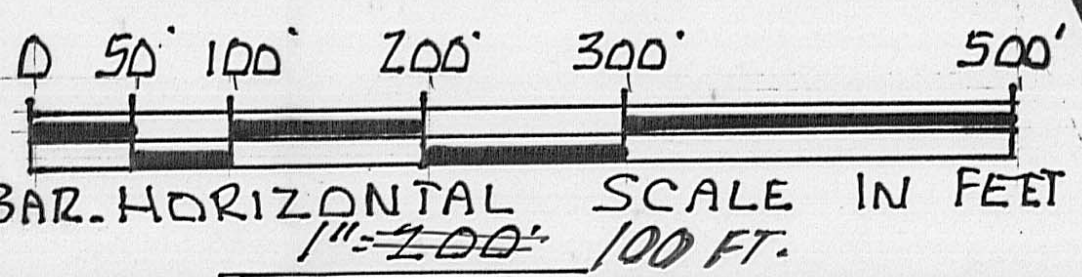

TWP. 755

CIVIL TWP. OF JEFFERSON BOUNDARY

S.R. 29 RIGHT OF WAY TO I. 70

CENTERLINE OF ROAD

RIGHT OF WAY

WEST JEFFERSON VILLAGE CORPORATION LINE IN \odot RD.

ANNEXED INTO VILLAGE

SURVEY
7.68249 AC.

405.449'

405.449' R/W

N 67° 15' 00" W

MAG SPIKES SET IN ROAD PAVEMENT

W.J. 2091

1219.510' TO R. COR.

N 11° 38' 45" W

Property boundary description of 7.68249 acres (rounded to 7.682 acres) surveyed out of 250 acres P.P.N. 08-00549.000 aerial parcel # 755 of record in D.B. 222 at Pg. 55 owned by Nancy J. looby in VMS 12143 Jefferson Civil Township, Madison County, Ohio fronting along the Village of West Jefferson Corporation line in middle of State Route # 29...said 7.682 acres being bounded and more particularly described as follows:

Commence with a found spike in the centerline of Old National Road (West bound U.S. Route # 40) and in the centerline projected for State Route # 29...go then along the middle of State Route # 29 northwesterly 5149.627 feet to a set mag spike at the true point of beginning (being N 67 deg 15 min 00 sec W 650.137 feet from a found spike in the middle of said 60 feet wide road right of way which spike is the northeasterly corner of 254 acres O.R. 126 Pg. 524 P.P.N. 10-02010.000 aerial parcel # 2091 owned by Shui-Nan and Chiou-Jeu-Chuang;

Thence: With the middle of State Route # 29 go N 67 deg 15 min 00 sec W 405.449 feet to a set mag spike;

Thence: Passing a set rebar capped at 30.000 feet go N 22 deg 45 min 00 sec E a total distance of 825.919 feet to a capped rebar set;

Thence: S 67 deg 05 min 52 sec E 405.450 feet to a set rebar;

Thence: Passing through a broken off pipe type end post secured with concrete at 793.822 feet, go S 22 deg 45 min 00 sec W 824.841 feet to the true point of beginning.

Containing within said bounds 7.682 acres of which 0.279 acre is within the 60 feet wide highway public right of way.

Bearings derived from U.R. 126 at Pg. 524 and survey plat 76-95 using N 67 deg 15 min W along the highway alignment.

Property address # 6010 State Route # 29 N.E., West Jefferson, Ohio 43162.

Rebar set are capped and stamped Baker S-5539.

This property is found to have a working 8 inch clay drainage tile crossing the front portion.

There is an existing residence and farm structures with grain bins on this property.

This land split has been approved by the zoning board of appeals, Madison County.

Surveyed in year 2002 by Rodger Irwin Baker, Ohio license # S-005539.



November 16, 2002

Rodger Irwin Baker L.L.S. & P.S. # S-005539 (Ohio)
1300 Plain City-Georgesville Road (South)
Galloway, Ohio 43119

Phone: 614-879-6004