

GROUND PROFILE OF PROPOSED DRAINAGE AREA
PROFILE OF PROPOSED DRAINAGE PIPE (3.33 FT. DEED AT 00+00)

NOTE:
BENCHMARK USED IS GPS 02-018
LOCATED AT JEFFERSON TOWNSHIP FIRE DEPARTMENT.
ELEVATION=946.16
T.B.M. #1 WEST BOLT FIRE HYDRANT=977.86
T.B.M. #2 SOUTH RIM MANHOLE=977.11

NANCY J. LOOBY
DEED BOOK 222 PAGE 55
JEFFERSON TOWNSHIP

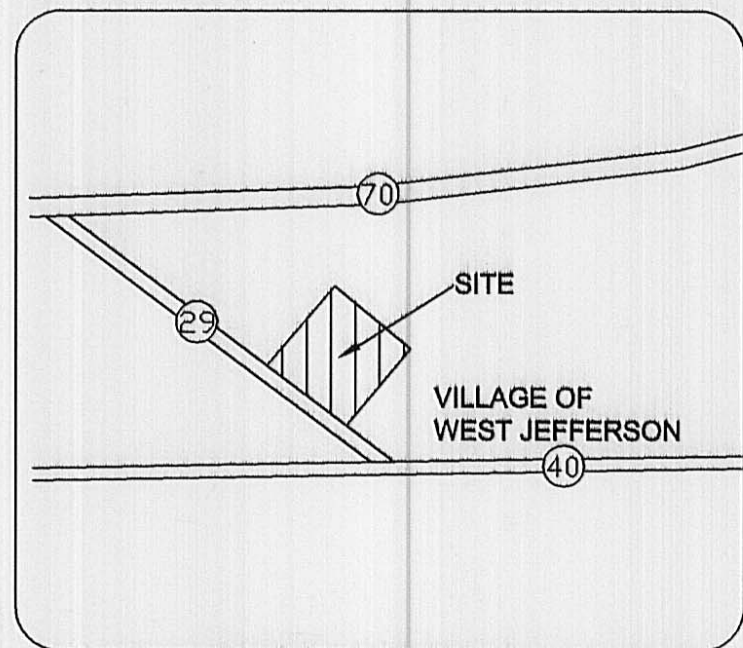
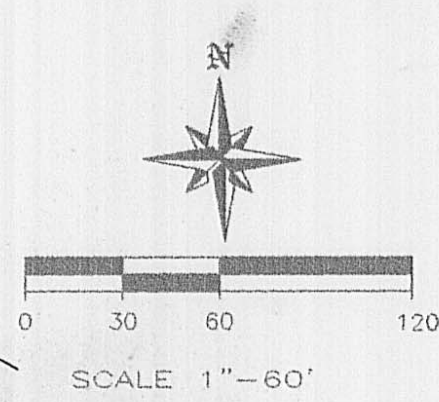

BUCKEYE READY MIX CONCRETE PLANT
INST# 200100001094
D.R. 118 PAGE 2133
16.797 ACRES

NANCY J. LOOBY
DEED BOOK 222 PAGE 55
JEFFERSON TOWNSHIP

BUCKEYE READY MIX CONCRETE PLANT
INST# 200100001094
D.R. 118 PAGE 2133
16.797 ACRES

7.662 ACRES

4.906 ACRES
IN VMS#10929

2.571 ACRES
IN VMS#12143

LAND SURVEY
PLAT OF SURVEY MADE FOR:
TODD ELFRINK
SHOWING A TRACT OF LAND LYING IN JEFFERSON
TOWNSHIP, VILLAGE OF WEST JEFFERSON,
VMS 12143 & VMS 10929 WITHIN THE BOUNDARIES
OF A 297 ACRE (ORIGINAL) TRACT
AS RECORDED IN IN DEED BOOK 222 PAGE 55
SURVEY MADE DURING DECEMBER, 2004.

by: *David E. Slagle* 01/14/05
DAVID E. SLAGLE P.S.# 7408



TOTAL ACRES IN VMS 12143=2.756
TOTAL ACRES IN VMS 10929=4.906
TOTAL ACREAGE =7.662

- LEGEND:
- 1" I.P. FOUND
 - 5/8" I.P. SET W/CAP
 - △ R/R SPIKE FOUND
 - ▲ R/R SPIKE SET

MADE FOR:	TODD ELFRINK
DATE:	1/3/2005
SCALE:	1" = 60'
REVISED:	
DRAWN BY:	M.P.G.
CHECKED BY:	D.E.S.
CAD FILE:	24-200

13-05

LEGAL DESCRIPTION

7.662 Acres

A tract of land situated in the State of Ohio, County of Madison, Village of West Jefferson and being a part of County Auditor Tax Map Parcel 10-02000.00 in the VMS 10929 and VMS 12143 and also being part of the Nancy J. Looby property as recorded in Deed Book 222, Page 055 and also being described in Deed Book 278, Page 862 and part of a 492.79 acre tract annexed to the Village of West Jefferson by Ordinance No. 89-9 and more particularly described by metes and bounds as follows:

Beginning for reference at P.K. nail at the intersection of the centerline of Old National Road (U.S. Highway 40) and the centerline of State Route 29 (County Highway No. 186);

Thence North 60 degrees 20 minutes 00 seconds West along the centerline of State Route 29, 2566.03 feet to a Mag nail at the Southwest corner of a 16.797 acre tract as owned by Buckeye Concrete Ready Mix LLC (Instrument No. 200100001094 - OR 118, page 2123) for the **True Point of Beginning** of the tract of land herein and hereby conveyed;

Thence continue North 60 degrees 20 minutes 00 seconds West along the centerline of State Route 29, 315.00 feet to a Mag nail set;

Thence leaving said centerline North 27 degrees 44 minutes 39 seconds East 300.00 feet (passing a 5/8 inch rebar set with cap at 30.00 feet) to a 5/8 inch rebar set with cap;

Thence North 60 degrees 20 minutes 00 seconds West 50.00 feet to a 5/8 inch rebar set with cap;

Thence North 27 degrees 44 minutes 38 seconds East 656.00 feet to a 5/8 inch rebar set with cap;

Thence South 60 degrees 20 minutes 00 seconds East 365.00 feet to a 5/8 inch rebar set with cap in the West line of the aforementioned Buckeye Ready Mix Concrete property;

Thence South 27 degrees 44 minutes 39 seconds West along the West line of the said Buckeye Ready Mix Concrete property (passing an existing iron pipe at 926.42 feet) a total distance of 956.00 feet to the **Point of Beginning**.

Containing in all 7.662 acres (2.756 acres in VMS 12143 and 4.906 acres in VMS 10929 all in Madison County, Ohio.

Basis for bearings is North 60 degrees 20 minutes 00 seconds West the centerline of Ohio State Route 29.

Survey made during December, 2004

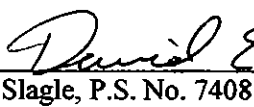
David E. Slagle, P.S. No. 7408

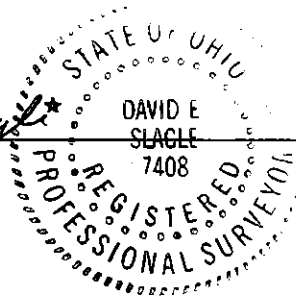

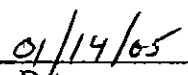
Date

LEGAL DESCRIPTION
Drainage Easement

A small strip of land 20.00 feet wide and 1060.00 feet long to be used for the purpose of a drainage easement described as follows:

A strip of land lying in the State of Ohio, County of Madison, Village of West Jefferson and being a part of County Auditor Tax Map Parcel 10-02000.00 in VMS 12143 and being part of the Nancy J. Looby property as recorded in Deed Book 222, Page 055 and more particularly described by metes and bounds as follows:

Beginning for reference at a P.K. nail at the intersection of the centerline of Old National Road (U.S. Highway 40) and the centerline of State Route 29 (County Highway No. 186);

Thence North 60 degrees 20 minutes 00 seconds West along the centerline of State Route 29, 2566.03 feet to a Mag nail at the Southwest corner of a 16.797 acre tract as owned by Buckeye Concrete Ready-Mix LLC (Instrument No. 200100001094 - OR 118, page 2123);

Thence North 27 degrees 44 minutes 39 seconds East along the West line of the aforementioned Buckeye Concrete Ready-Mix property 956.00 feet to a 5/8 inch rebar set with cap for the **True Point of Beginning** of said easement;

Thence leaving said West line North 60 degrees 20 minutes 00 seconds West 20.00 feet to a point;

Thence North 27 degrees 44 minutes 39 seconds East 1060.00 feet to a point;

Thence South 60 degrees 20 minutes 00 seconds East 20.00 feet to a point;

Thence South 27 degrees 44 minutes 39 seconds East 1060.00 feet to the **Point of Beginning**.

Containing 0.486 acres all in Madison County, Ohio.

Basis for bearings is North 60 degrees 20 minutes 00 seconds West the centerline of Ohio State Route 29.

Survey made during December, 2004.

David E. Slagle
David E. Slagle, P.S. No. 7408

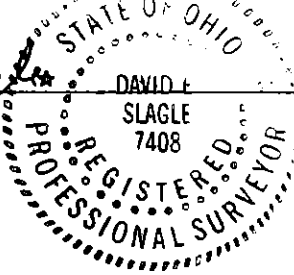

01/14/05
Date