

RUTH C. O'DAY (Vol. 189, Pg. 203)

B. & O. RAILROAD

N 36 -28'-30" E, 625.12'

RETRACEMENT SURVEY AND IMPROVEMENTS LOCATION ON 5.503 ACRE TRACT NATIONAL GLOVE INC., TO VERSA CORP.

LOCATED IN THE VILLAGE OF MT. STERLING, PLEASANT TOWNSHIP, MADISON COUNTY, OHIO

SURVEYOR'S CERTIFICATION

I hereby certify to VERSA CORPORATION that the above survey prepared by me, entitled 5.503 acre tract, was actually made upon the ground and that it and the information, courses and distances shown thereon are correct, that the title lines and lines of actual possession are the same, that the size, location and type of buildings and improvements are as shown and all are within the boundary lines of the property, and that there are no easements, encroachments or uses affecting this property appearing from a careful physical inspection of the same, other than those shown and depicted thereon. This survey is made in accordance with the "Minimum Standard Detail Requirements for Land Title Surveys" jointly established and adopted by ALTA and ACSM in 1962.

Clayton M. Lee
Clayton M. Lee
Registered Professional Surveyor No. 6181
January 11, 1988



S 30 -52'-45" W, 577.93'

AMERICAN LEGION, 1.22 AC.
D.V. 192, PG. 80

EXTENSION
CHALLENGER
AVE
(33')
S 59 -43'-20" E, 97.87'
REV.

LOT 1 LOT 2

16.5' ALLEY
MAPLEWOOD ADDITION

PLNT 23-22-24-4-23
TRACT 2, D.B. 151, PG. 573
TRACT 1, DEED BOOK 151, PG. 573
PT. SURVEY 12140
PLNT 17-21, 22-23-17

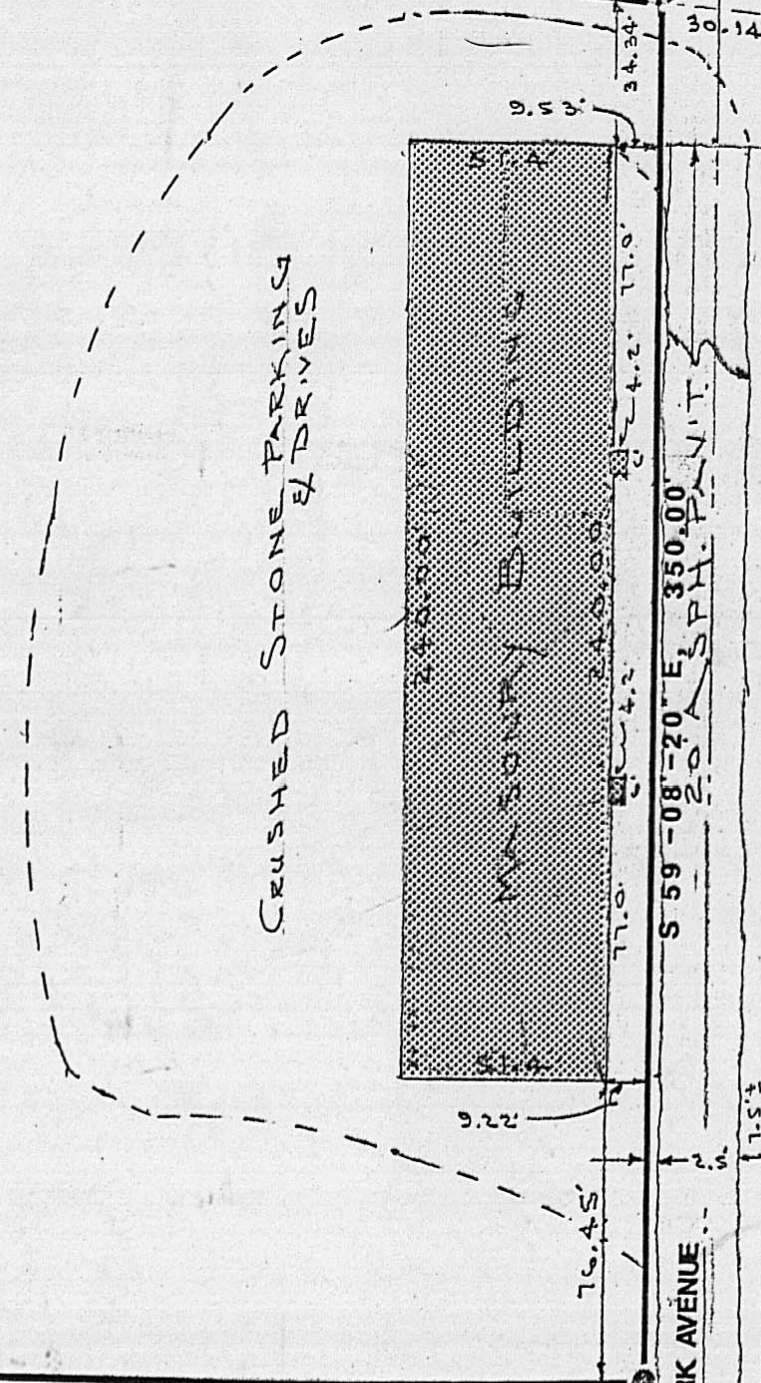

NO COR. MON. SET
SHALLOW BURIED
CABLES IN AREA.

REV. 1-25-88

- ⊙ = FOUND 3/4" IRON PIPE
- = " 1/2" " ROD
- = SET 3/4" " ROD

SCALE - 1" = 50'

VERSA CORP. (DEED BK. 162, PG. 658)
2.961 AC.
443.57 (NORTH), 444.1 (DEED)

TOLERANCES (EXCEPT AS NOTED)	REVISIONS			Lee Surveying & Mapping Co. 855 E. Sandusky Ave. BELLEFONTAINE, OHIO 43311 (513) 593-5780		
	NO.	DATE	BY			
DECIMAL	1	1-25-88	C.M.L.	DRAWN BY C.M. LEE	SCALE 1" = 50'	MATERIAL
±	2				DATE	
FRACTIONAL	3			CHK'D	APP'D	
±	4				TRACED	
ANGULAR	5					
±						

Situated in the State of Ohio, in the County of Madison and in the Village of Mt. Sterling and Pleasant Township and bounded and described as follows:

BEGINNING at a point in the southerly line of Clark Avenue at its intersection with the easterly line of the right-of-way of the Baltimore and Ohio Railroad said beginning point being distant from a three quarter inch iron pipe found in the northerly line of Clark Avenue at its intersection with the westerly line of a 16.5 foot wide alley abutting the westerly side of the Maplewood Addition along the following courses: (a) North 36° 28' 30" East along the eastern side of the right-of-way of the Baltimore and Ohio Railroad a distance of 30.14 feet to an iron pipe, thence (b) South 59° 08' 20" East along the northerly line of Clark Avenue a distance of 443.57 feet, and from said beginning point running thence:

- (1) South 59° 08' 20" East along the southerly line of Clark Avenue 350.00 feet to a point; thence
- (2) South 30° 52' 45" West a distance of 577.93 feet to a point; thence
- (3) South 59° 43' 20" East a distance of 97.87 feet to a point; thence
- (4) South 30° 45' West a distance of 40.00 feet to a point; thence
- (5) North 59° 43' 20" West a distance of 508.96 feet to a point in the easterly line of the right-of-way of the Baltimore and Ohio Railroad; thence
- (6) Along said easterly line of the right-of-way of the Baltimore and Ohio Railroad North 36° 28' 30" East a distance of 625.12 feet to the point and place of BEGINNING. Containing 5.503 acres, more or less.

The above description is drawn in accordance with a survey of Clayton M. Lee, Registered Professional Surveyor dated January 11, 1988.