

**THE DUTCH KITCHEN**

AERIAL PARCEL N° 140

PROPERTY BOUNDARY LINE  
N 87° 37' 00" E → 762.490 TOTAL

AERIAL PARCEL N° 602

10.09 ACRES SURVEYED FEB. 28, 1955  
BY MAD. CO. ENGR. HELGEN E. KEDRAHL  
AND EVA MAE KILGORE (UNMARRIED)  
APRIL 27TH, 1956 CONVEYED BY D.B. 152 PG. 392 TO:  
THE BOARD OF EDUCATION OF THE JONATHAN ALDER  
LOCAL SCHOOL DISTRICT

MAG SPIKE SET @  
POINT OF BEGINNING  
U.S. ROUTE N° 42  
N 11° 48' 00" E  
373.740' FRONTAGE

R/W BOUNDARY @ 30.000'  
STATE HWY. N° 241 ST. C.  
CENTERLINE & R/W MAIL  
LINE 154.169'  
R/W BOUNDARY  
165.353'

36.985' FOUND R/W MONUMENT BROKEN OFF  
334.645' ALONG R/W LINE SET 5/8" STEEL PIN CAPPED  
PART OF AUDITOR'S PARCEL N° 01-00492.000

2.277 ACRES MENLY SURVEYED FOR: WILMA G. YODER (WIDOW) 8601 U.S. ROUTE N° 42 NORTH PLAIN CITY, OHIO 43064 BEING PART OF AERIAL PARCEL N° 281 WHICH IS TOTALLY 128.63 ACRES CITED IN DEED BOOK 256 AT PAGE 0105

GARAGE BLDG.

D.B. 256 AT PG. 105-106 EXHIBIT "A" CITED 100 ACRES ±  
SECOND TRACT BOUNDARY ONLY  
FIRST TRACT BOUNDARY CITED EXHIBIT "A"  
28 3/4 ACRES MORE OR LESS  
D.B. 256 PG. 105-106  
TRANSFERRED DEC. 17, 1981

SEE AERIAL MAP N° 8 P.P.N. 01-00492.000  
IN CANAAN CIVIL TOWNSHIP  
MADISON COUNTY, OHIO  
VMS 6508  
KILMA G. YODER SURVIVING SPOUSE  
AND JOINT TENANT OF JOINT  
AND SURVIVORSHIP PROPERTY  
MOSE J. YODER (HIM BEING DECEASED)  
18 DEC. 1980  
AERIAL PARCEL N° 281

PRIOR DEED FOR REFERENCE  
VOL. 247 PGS. 841, 842, 843

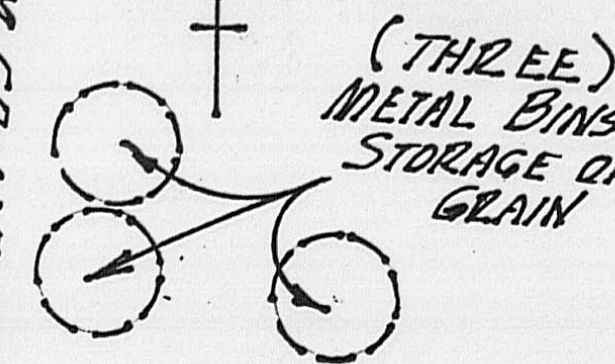
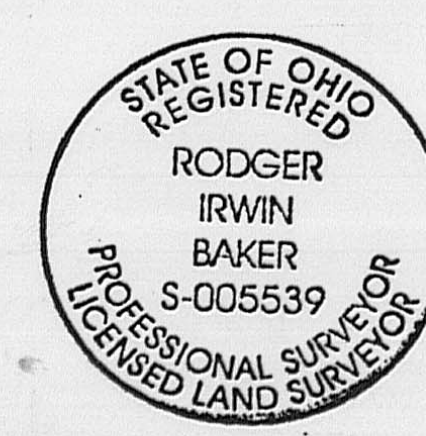

LEGEND & SYMBOLS  
P: PROPERTY LINE - BOUNDARY  
E: CENTERLINE - ROADWAY  
L: LANDHOOK SAME OWNER  
D.B.: DEED BOOK PG.: PAGE  
R/W: RIGHT OF WAY - LIMITS  
@: AT  
VMS: VIRGINIA MILITARY SURVEY  
P.P.N.: PERMANENT PARCEL N°.

VMS 6508 (ORIGINAL SCALE)

FIELD SURVEY PLAT

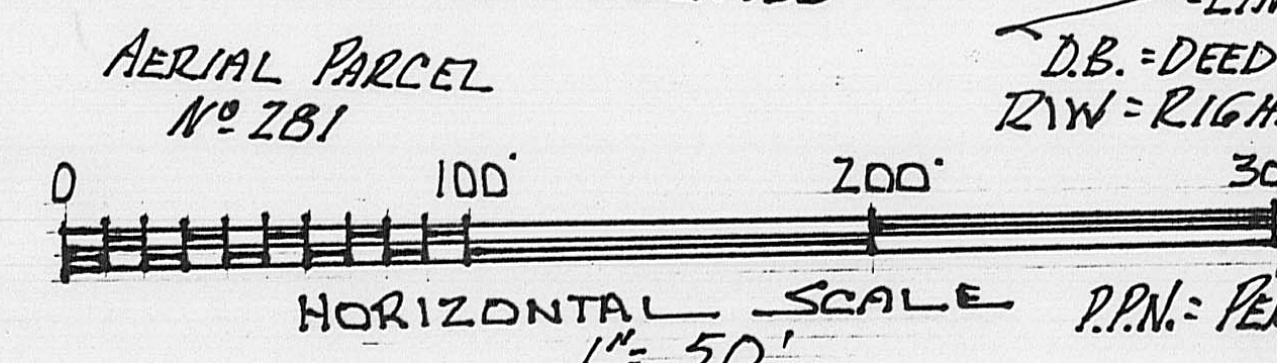

FIRST TRACT 28.75 ACRES / TRACT BOUNDARY ONLY  
SECOND TRACT 100 ACRES / CITED BY DEED

Being a property boundary survey description of 2.277 acres of land in VMS 6508, Canaan Civil Township, County of Madison, State of Ohio, located at 8601 U. S. Route # 42, Plain City, Ohio 43604 currently owned by Wilma G. Yoder of record in D.B. 256 at Pg. 105 & 106, being a portion of permanent parcel number 01-00492.000 ( see aerial parcel number 281 at map # 8 )....said 2.277 acres being bounded and more particularly described as follows:

- Commence for a point of starting reference with a buried nail in the middle of U.S. Route # 42 at the centerline projection of Kilbury-Huber Road ( Co. Rd. # 33 50 feet right of way width ) go then along the middle of 60 feet wide U.S. Route # 42 toward Plain City N 11 deg 48 min 00 sec E 82.471 feet to a set mag spike at the point of beginning;
- Thence: Continue with the road frontage herewith and middle of U.S. Route # 42 N 11 deg 48 min 00 sec E 373.740 feet to a set small mag spike;
- Thence: Leaving the roadway and passing a set 5/8 inch steel rod capped at 30.135 feet S 83 deg 37 min 03 sec E 247.423 feet to a set 5/8 inch steel rod capped;
- Thence: S 03 deg 17 min 05 sec W 351.690 feet to a set 5/8 inch steel rod capped;
- Thence: With the southerly boundary herewith and passing a set 5/8 inch steel rod capped at 272.030 feet N 87 deg 34 min 42 sec W a total distance of 302.436 feet to the true point of beginning.

Containing within said bounds 2.277 acres of land including the residence and garage.

Bearings adapted to the middle of U.S. Route # 42 as cited in D.B. 152 at Pg. 392. ( Cited S 11 deg 48 min W ).

Steel rods set are capped with plastic caps stamped R.I. Baker S-5539.

This description is based on a current field survey made by William Troy Barton and Rodger I. Baker, Ohio registration # S-005539.

*Rodger I. Baker* October 14 th., 2006  
Rodger I. Baker P.S., L.L.S., Ohio License # S-005539  
P.O. Box 315 West Jefferson, Ohio 43162  
Phone: 614-879-6004

**2.277 ACRES SPLIT OUT OF  
128.63 ACRES IN VMS 6508  
CANAAN CIVIL TOWNSHIP,  
MADISON COUNTY, OHIO  
FOR: WILMA G. YODER  
PART OF P.P.N. 01-00492.000  
PART OF AERIAL PARCEL # 281**

Being a property boundary survey description of 2.277 acres of land in VMS 6508, Canaan Civil Township, County of Madison, State of Ohio, located at 8601 U. S. Route # 42, Plain City, Ohio 43604 currently owned by Wilma G. Yoder of record in D.B. 256 at Pg. 105 & 106, being a portion of permanent parcel number 01-00492.000 ( see aerial parcel number 281 at map # 8 )....said 2.277 acres being bounded and more particularly described as follows:

Commence for a point of starting reference with a buried nail in the middle of U.S. Route # 42 at the centerline projection of Kilbury-Huber Road ( Co. Rd. # 33 50 feet right of way width ) go then along the middle of 60 feet wide U.S. Route # 42 toward Plain City N 11 deg 48 min 00 sec E 82.471 feet to a set mag spike at the point of beginning;

Thence: Continue with the road frontage herewith and middle of U.S. Route # 42 N 11 deg 48 min 00 sec E 373.740 feet to a set small mag spike;

Thence: Leaving the roadway and passing a set 5/8 inch steel rod capped at 30.135 feet S 83 deg 37 min 03 sec E 247.423 feet to a set 5/8 inch steel rod capped;

Thence: S 03 deg 17 min 05 sec W 351.690 feet to a set 5/8 inch steel rod capped;

Thence: With the southerly boundary herewith and passing a set 5/8 inch steel rod capped at 272.030 feet N 87 deg 34 min 42 sec W a total distance of 302.436 feet to the true point of beginning.

Containing within said bounds 2.277 acres of land including the residence and garage.

Bearings adapted to the middle of U.S.Route # 42 as cited in D.B. 152 at Pg. 392. ( Cited S 11 deg 48 min W ).

Steel rods set are capped with plastic caps stamped R.I.Baker S-5539.

This description is based on a current field survey made by William Troy Barton and Rodger I. Baker, Ohio registration # S-005539.



October 14 th., 2006

Rodger I. Baker P.S., L.L.S, Ohio License # S-005539

P.O.Box 315 West Jefferson, Ohio 43162

Phone: 614-879-6004

