

**EXHIBIT OF 3.270 ACRES
SITUATED IN THE STATE
OF OHIO'
MADISON COUNTY, PAINT
TOWNSHIP,
AND BEING IN VMS. 6061.**

LITTLE MIAMI & COLUMBUS
RAILROAD

POINT OF REFERENCE
FOR 3.270 ACRE TRACT,
SOLID IRON PIN FOUND
AT N.E. COR. OF 75.88 ACRE
TRACT ON S. R/W LINE OF RAILROAD,
AND WEST R/W LINE OF NEIL ROAD

RANDY E. FINNEY &
LINDA L. FINNEY
DB. 279 PG. 272
4.0574 ACRES

JAMES C. MITCHELL, TRUSTEE
CAROLYN L. MITCHELL, TRUSTEE
OR.220 PG. 840
75.88 ACRES

GRAPHIC SCALE

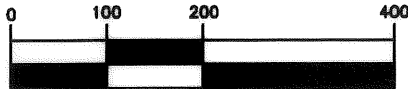

(IN FEET)
1 inch = 200 ft.

TRUE POINT OF BEGINNING
FOR 3.270 ACRE TRACT
IRON PIN AND CAP SET

AGRICULTURAL LANDS, INC.
OR. 67 PG. 290
158.13 ACRES

20' DRAINAGE EASEMENT

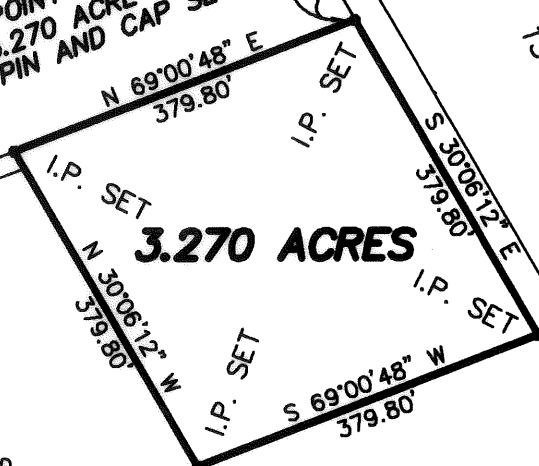

3.270 ACRES

BEARINGS FOR THIS SURVEY ARE BASED
ON THE WEST R/W OF NEIL ROAD
S 30°06'12" E

3.270 ACRE TRACT BEING SPLIT FROM
AN ORIGINAL 17636 ACRE TRACT

ALL IRON PINS SET ARE
3/4" PIPES WITH YELLOW
PLASTIC CAPS STAMPED PSS.



GERALD T. BAYNES
OR. 126 PG. 2610
176.86 ACRES

NEIL ROAD

PRECISION SURVEYING SERVICES, LLC
CONSULTING SURVEYORS

John W. Evers
JOHN W. EVERS
P.S. 7869 8-03-2003

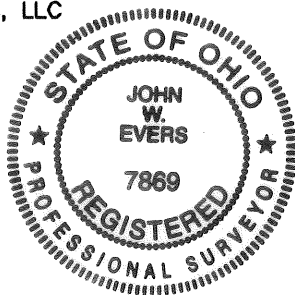

o = 30" IRON PIN SET WITH CAP

PREPARED BY
PRECISION SURVEYING SERVICES, LLC.
CONSULTING SURVEYORS
9055 S.R. 58 S.E.
MT. STERLING, OHIO 43143
~ OFFICE ~ (740) 845-1412
~ FAX ~ (740) 845-1422

DRAWN BY: J.W.E.	CHECKED BY: JWE	ORDER No.	AREA No.	SHEET
SCALE: 1"=200'	DATE: DEC. '06		MAD	1 OF 1

132.06

**EXHIBIT OF A 20' DRAINAGE EASEMENT
CONTAINING 0.715 ACRES
SITUATED IN THE STATE OF OHIO,
MADISON COUNTY, PAINT TOWNSHIP,
0.264 ACRES BEING IN VMS #10773
AND 0.451 ACRES BEING IN VMS #6061**

GRAPHIC SCALE

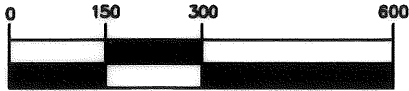

(IN FEET)
1 inch = 300 ft.

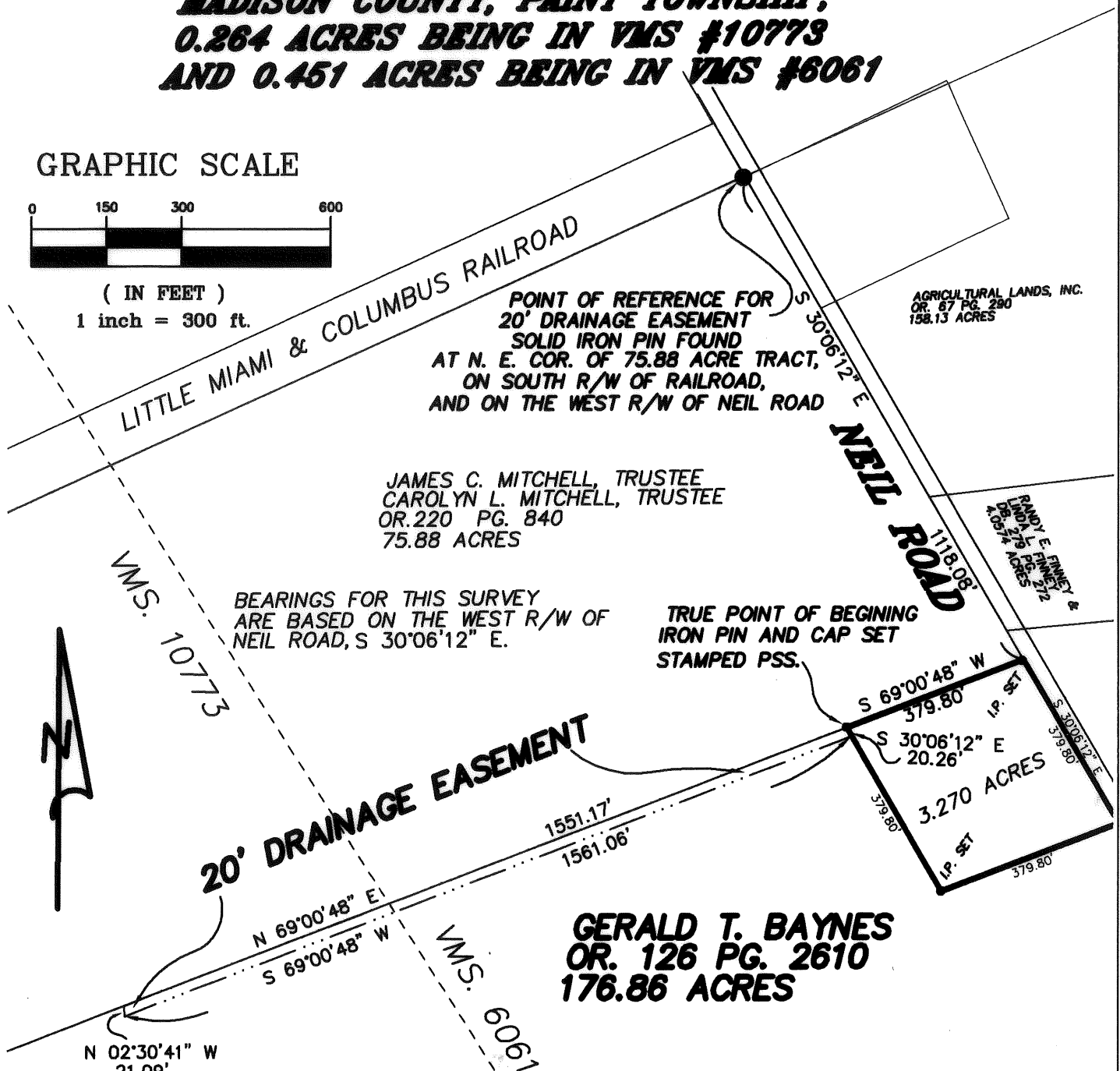

POINT OF REFERENCE FOR
20' DRAINAGE EASEMENT
SOLID IRON PIN FOUND
AT N. E. COR. OF 75.88 ACRE TRACT,
ON SOUTH R/W OF RAILROAD,
AND ON THE WEST R/W OF NEIL ROAD

AGRICULTURAL LANDS, INC.
OR. 67 PG. 280
158.13 ACRES

JAMES C. MITCHELL, TRUSTEE
CAROLYN L. MITCHELL, TRUSTEE
OR.220 PG. 840
75.88 ACRES

BEARINGS FOR THIS SURVEY
ARE BASED ON THE WEST R/W OF
NEIL ROAD, S 30°06'12" E.

TRUE POINT OF BEGINNING
IRON PIN AND CAP SET
STAMPED PSS.

20' DRAINAGE EASEMENT

**GERALD T. BAYNES
OR. 126 PG. 2610
176.86 ACRES**

RANDY E. FINNEY &
LINDA L. FINNEY
OR. 274 PG. 272
2.0574 ACRES

S 69°00'48" W
379.80' I.P. SET
S 30°06'12" E
20.26' I.P. SET
3.270 ACRES
S 30°06'12" E
379.80' I.P. SET
379.80'

N 02°30'41" W
21.09'

PRECISION SURVEYING SERVICES, LLC
CONSULTING SURVEYORS

John W. Evers
JOHN W. EVERS
P.S. 7869 12-12-2006

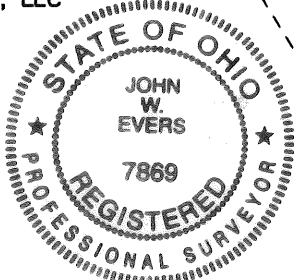

o = 30" IRON PIN SET WITH CAP

PREPARED BY
PRECISION SURVEYING SERVICES, LLC.
CONSULTING SURVEYORS
9055 S.R. 56 S.E.
MT. STERLING, OHIO 43143
~ OFFICE ~ (740) 845-1412
~ FAX ~ (740) 845-1422

DRAWN BY: J.W.E.	CHECKED BY: JWE	ORDER No.	AREA No.	SHEET
SCALE: 1"=300'	DATE: DEC. '06		MAD	1 OF 1

**DESCRIPTION OF 3.270 ACRES
FROM LANDS OWNED BY
GERALD T. BAYNES
PAINT TOWNSHIP, MADISON COUNTY, OHIO**

Situate in Virginia Military Survey No. 6061, Paint Township, County of Madison, State of Ohio, and being 3.270 acres of land all out of a 176.86 acre tract of land owned by Gerald T. Baynes, of record in Official Record 126, Page 2610 (all references to records being on file in the Office of the Recorder, Madison County, Ohio), said 3.270 acre tract being further described as follows:

The Point of Reference being a solid iron pin found at the northeast corner of a 75.88 acre tract owned by James C. Mitchell, Trustee, and Carolyn L. Mitchell, Trustee, of record in Official Record 220, Page 840, and also being at the intersection of the south Right-of-Way of The Little Miami and Columbus Railroad, and the west Right-of-Way of Neil Road (33' wide) Thence South 30°06'12" East, along said west Right-of-Way of Neil Road, a distance of 1118.08', to an iron pin and cap set at the True Point of Beginning of the herein described 3.270 acre tract, and being the northeast corner of said 176.86 acre tract of land.

Thence South 30°06'12" East, along the west Right-of-Way line of Neil road, a distance of 379.80 feet to an iron pin and cap set;

Thence South 69°00'48" West, into said 176.86 acre tract, a distance of 379.80 feet to an iron pin and cap set;

Thence North 30°06'12" West, a distance of 379.80 feet to an iron pin and cap set in the northerly line of said 176.86 acre tract;

Thence North 69°00'48" East, along the southerly line of said 75.88 acre tract being the north line of said 176.86 acre tract, a distance of 379.80 feet to the True Point of Beginning and containing 3.270 acres of land.

For the purpose of this description, a bearing of South 30°06'12" East was used on the west Right-of-Way of Neil Road, and also being the easterly line of said 176.86 acre tract of land owned by Gerald T. Baynes, on record in Official Record 126, Page 2610, on file in the Office of the Recorder, Madison County, Ohio.



PRECISION SURVEYING SERVICES, LLC
Consulting Surveyors

John W. Evers P.S. 7869
John W. Evers 12-12-06