

DAVID WATSON WILLIAMS EST.  
DEED BOOK 236 PAGE 266  
146.9344 ACRES

DAVID WATSON WILLIAMS EST.  
DEED BOOK 236 PAGE 266  
146.9344 ACRES

SAMMY RAY & NANCY  
CLEMMONS  
OFFICIAL RECORD 138 PAGE 1894  
92.66 ACRES

BARBARA A. GEESLING  
OFFICIAL RECORD 127 PAGE 1242  
105.25 ACRES

**DEED REFERENCE**  
**WILLIAM R. BALL**  
**DEED BOOK 254 PAGE 24**  
**58.969 ACRES**

**43.9663± ACRES**

**15.0010± ACRES**

WILLIAM R. BALL  
OFFICIAL RECORD 98 PAGE 2424  
5.002 ACRES

JERRY L. & DEBRA S. BALL  
DEED BOOK 254 PAGE 26  
63.97 ACRES

BARBARA A. GEESLING  
OFFICIAL RECORD 127 PAGE 1242  
105.25 ACRES

METAL BARN

DRURY ROAD (CR-23)(50' R/W)

**LEGEND**

- 6" WOODEN FENCE POST (FOUND)
- ⊙ 3/4" IRON PIPE & CAP STAMPED "RET 6552"
- ⊗ 4" STEEL POST IN CONCRETE (FOUND)
- DIA. SOLID IRON PIN (FOUND)
- ▲ 5/8" REBAR & ALUMINUM CAP STAMPED "NCB 5969" (FOUND)
- ⊙ P.K. NAIL (FOUND)
- 1/2" SOLID IRON PIN
- MAG NAIL (SET)
- 5/8" ϕ REBAR & YELLOW PLASTIC CAP STAMPED "COTTRILL 6858" (SET)

ALL MONUMENTS FOUND OR SET ARE IN GOOD  
CONDITION UNLESS OTHERWISE NOTED.

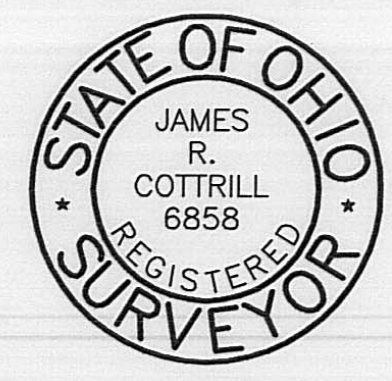

I HEREBY CERTIFY THAT THIS PLAT DEPICTS  
AN ACTUAL FIELD SURVEY PERFORMED BY  
JAMES R. COTTRILL P.S. #6858  
*James R. Cottrill* DATE: 12/29/05

**COTTRILL SURVEYING, L.L.C.**  
8256 S.R. 207 N.E. MT. STERLING, OHIO 43143 PH. (740) 869-3811

**43.9663± & 15.0010± ACRES,**  
**VMS 12730, PAINT TOWNSHIP,**  
**MADISON COUNTY, OHIO.**  
**SURVEYED FOR KAREN BALL**

DATE DRAWN: 12/15/06	SCALE : 1"=200' 200' 100' 0 200'	CREW: MW, TB
JOB # S051206		DWN. BY: MW
F. B. #38		CK. BY: RC

27-06

15.0010 Acre Tract  
Surveyed for Karen Ball

The following described 15.0010 acre tract is situated in the State of Ohio, Madison County, Paint Township, V.M.S. 12730, being part of a 58.969 acre tract conveyed to William R. Ball by Deed Book 254 Page 24 and being more particularly described as follows:

Beginning at a 1/2" solid iron pin found in the centerline of Drury Road (County Road 23)(50 ft. right-of-way), said iron pin is at the southwest corner of a 105.25 acre tract conveyed to Barbara A. Geesling by Official Record 127 Page 1242 also at the southeast corner of said 58.969 acres and in the line between V.M.S. 12730 and V.M.S. 8122;

Thence, with the centerline of said Drury Road North 88° 29 minutes 53 seconds West a distance of 418.13 ft. to a mag nail set in the centerline of said road, said mag nail is also in the southeast corner of a 5.002 acre tract conveyed to William R. Ball by Official Record 98 Page 2424;

Thence, with Ball's said 5.002 acres the following 4 courses:

- 1) North 00° 24 minutes 53 seconds West, passing a 3/4" pipe and cap stamped "RET 6552" at 30.14 ft. a total distance of 516.66 ft. to a 3/4" iron pipe and cap stamped "RET 6552"
- 2) North 06° 00 minutes 22 seconds East a distance of 167.31 ft. to a 6" Wooden Fence Post found
- 3) North 80° 15 minutes 43 seconds West a distance of 316.81 ft. to a 3/4" pipe and cap stamped "RET 6552" found
- 4) South 01° 30 minutes 13 seconds West, passing a 3/4" iron pipe & cap stamped "RET 6552" at 698.48 ft., a total distance of 728.55 ft. to a mag nail set in the centerline of said Drury Road

Thence, with said road, North 88° 29 minutes 53 seconds West a distance of 129.84 ft. to a mag nail set in said centerline;

Thence, with a new line across said 58.969 acre tract the following 2 courses:

- 1) North 01° 30 minutes 13 seconds East, passing an iron pin and cap set at 30.00 ft. a total distance of 1016.54 ft. to an iron pin and cap set (buried 1.00 ft.)
- 2) South 87° 31 minutes 33 seconds East a distance of 861.25 ft. to an iron pin and cap set in the west line of Geesling's said 105.25 acres and the east line of Ball's said 58.969 acres, said iron pin is also in the line between said V.M.S. 12730 & V.M.S. 8122

Thence, with the line between said Ball's 58.969 acres and Geesling's 105.25 acres and said V.M.S. lines, South 01° 14 minutes 36 seconds West, passing a 4" steel post in concrete at 976.25 ft., a total distance of 1001.93 ft. returning to the point of beginning containing 15.0010 acres more or less.

Bearings are based on the centerline of Drury Road (North 88° 29 minutes 53 seconds West) as described in Deed Book 254 Page 24.

This deed is subject to and with the benefit of all legal highways, restrictions, easements, limitations, and reservations, of record, if any and to zoning restrictions which have been imposed thereon, if any.

All iron pins set are 5/8 inch diameter rebar with yellow plastic caps stamped "Cottrill L.L.C. 6858."

This description is based on a field survey performed December 15, 2005 by James R. Cottrill registration #6858. (Job #S051206A)

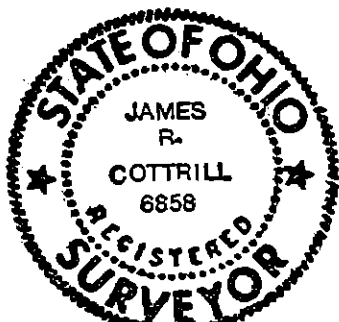

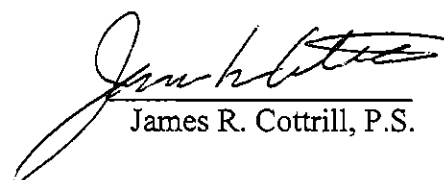
  
James R. Cottrill, P.S.

43.9663 Acre Tract  
Surveyed for Karen Ball

The following described 43.9663 acre tract is situated in the State of Ohio, Madison County, Paint Township, V.M.S. 12730, being part of a 58.969 acre tract conveyed to William R. Ball by Deed Book 254 Page 24 and being more particularly described as follows:

Beginning at a p.k. nail found in the centerline of Drury Road (County Road 23)(50 ft. right-of-way), said p.k. nail also being in the southeast corner of a 63.97 acre tract conveyed to Jerry L. & Debra S. Ball by Deed Book 254 Page 26;

Thence, with the line of said Ball's 63.97 acres the following 3 courses:

- 1) North 01° 29 minutes 32 seconds East, passing a 5/8" rebar and aluminum cap stamped "NCB 5969" at 25.95 ft., a total distance of 592.04 ft. to a 5/8" rebar and aluminum cap stamped "NCB 5969" found
- 2) North 88° 30 minutes 29 seconds West a distance of 1133.88 ft. to an iron pin and cap (buried 1.00' deep) set
- 3) North 03° 33 minutes 06 seconds East a distance of 712.24 ft. to a 5/8" rebar and aluminum cap stamped "NCB 5969" in the south line of a 146.9344 acre tract conveyed to David Watson Williams Estate, said rebar is also in the northwest corner of Ball's said 58.969 acres, and also in the north line of said V.M.S. 12730;

Thence, with the north line of said 58.969 acres and said V.M.S. line, South 87° 31 minutes 33 seconds East a distance of 2678.20 ft. to a 4" steel post in concrete found in the northeast line of said 58.969 acres and in a corner of a 105.25 acre tract conveyed to Barbara A. Geesling by Official Record 127 Page 1242;

Thence, with the line of said Geesling and the East line of V.M.S. 12730, South 01° 14 minutes 36 seconds West a distance of 256.26 ft. to an iron pin and cap set in the east line of said 58.969 acres;

Thence, with a new line across said 58.969 acres the following 2 new courses:

- 1) North 87° 31 minutes 33 seconds West a distance of 861.25 ft. to an iron pin and cap set;
- 2) South 01° 30 minutes 13 seconds West, passing an iron pin and cap set at 986.54 ft., a total distance of 1016.54 ft. to a mag nail set in the centerline of said Drury Road;

Thence, with said Drury Road North 88° 29 minutes 53 seconds West a distance of 709.31 ft. returning to the point of beginning containing 43.9663 acres more or less.

Bearings are based on the centerline of Drury Road (North 88° 29 minutes 53 seconds West) as described in Deed Book 254 Page 24.

This deed is subject to and with the benefit of all legal highways, restrictions, easements, limitations, and reservations, of record, if any and to zoning restrictions which have been imposed thereon, if any.

All iron pins set are 5/8 inch diameter rebar with yellow plastic caps stamped "Cottrill L.L.C. 6858."

This description is based on a field survey performed December 15, 2005 by James R. Cottrill registration #6858. (Job #S051206)

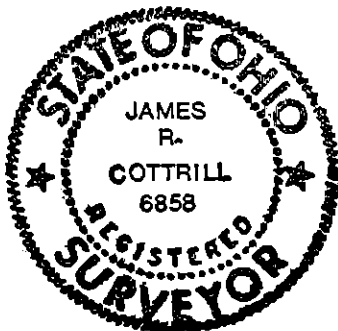

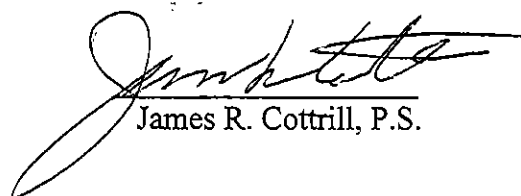
  
James R. Cottrill, P.S.