

BEARINGS BASED ON THE CENTERLINE OF GREEN LANE
(S 25°29'18" E) AS DESCRIBED IN OFFICIAL RECORD 71 PAGE 679.

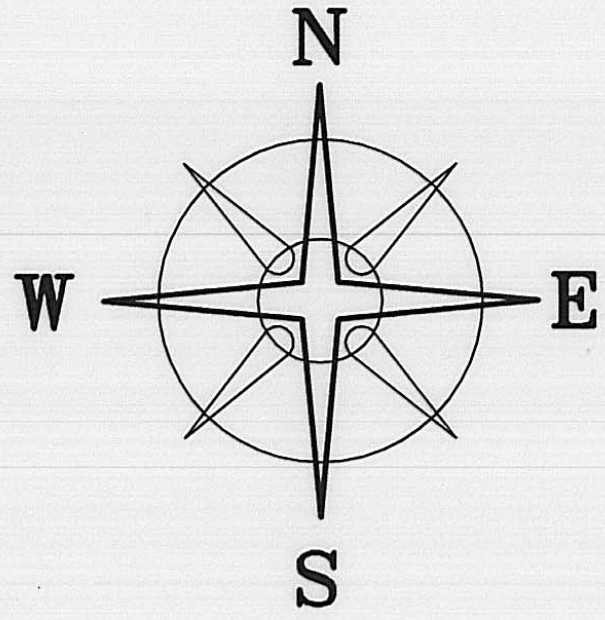

RICHARD W. PARKER
OFFICIAL RECORD 53 PAGE 29
5.1282 ACRES

3.6109± ACRES

DEED REFERENCE
 CHAD A. & CRYSTAL L.
 HIGGINS
 OFFICIAL RECORD 71 PAGE 679
 14.980 ACRES

- LEGEND**
- 5/8" Ø REBAR & YELLOW PLASTIC CAP STAMPED "COTTRILL 6858" (PREVIOUSLY SET)
 - RAIL ROAD SPIKE (FOUND)
 - MAG NAIL (SET)
 - 5/8" Ø REBAR & YELLOW PLASTIC CAP STAMPED "COTTRILL 6858" (SET)
- ALL MONUMENTS FOUND OR SET ARE IN GOOD CONDITION UNLESS OTHERWISE NOTED.
- TAX MAP PARCEL NUMBER

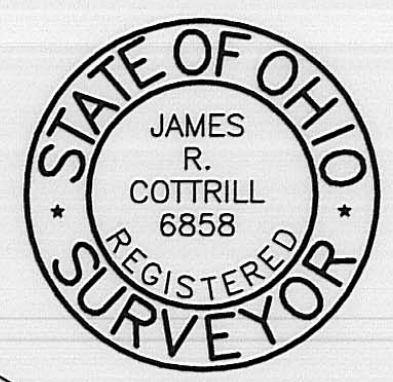

COTTRILL SURVEYING, L.L.C.
 8256 S.R. 207 N.E. MT. STERLING, OHIO 43143 PH. (740) 869-3811

3.6109 ACRES, V.M.S. 3900,
SOMERFORD TOWNSHIP, MADISON COUNTY
STATE OF OHIO
SURVEYED FOR CHAD HIGGINS

I HEREBY CERTIFY THAT THIS PLAT DEPICTS AN ACTUAL FIELD SURVEY PERFORMED BY JAMES R. COTTRILL P.S. #6858
 DATE: 3/18/05

DATE DRAWN: 3/16/05	SCALE : 1"=100'	CREW: MW
JRB #S050310	100' 50' 0 100'	DWN. BY: MW
F. B. #36		CK. BY: RC

38-06

3.6109 Acre Tract
Surveyed for Chad Higgins

The following described 3.6109 acre tract is situated in the State of Ohio, Madison County, Somerford Township, VMS 3900, being part of a 14.980 active tract conveyed to Chad A. and Crystal L. Higgins by official record 71 page 679 and being more particularly described as follows:

Beginning at a railroad spike found at the centerline intersection of Arbuckle Road (40 ft. right-of-way)(County Road 110) with Green Lane (right-of-way width unknown)(County Road 112), said spike is also at the southeast corner of said 14.980 acre tract;

Thence, with the centerline of said Arbuckle Road, North 60° 00 minutes 00 seconds West a distance of 313.76 ft. to a railroad spike found at the southeast corner of a 5.1282 acre tract conveyed to Richard W. Parker by official record 53 page 29;

Thence, with the east line of said 5.1282 acre tract, North 25° 29 minutes 18 seconds East, passing an iron pin and cap previously set at 25.00 ft., a total distance of 469.32 ft. to an iron pin and cap previously set corner to said 5.1282 acre tract;

Thence, with a new line across said 14.980 acre tract, South 72° 13 minutes 51 seconds East, passing an iron pin and cap set at 289.24 ft., a total distance of 315.65 ft. to a mag nail set in the centerline of said Green Lane;

Thence, with the centerline of said Green Lane, South 25° 29 minutes 18 seconds West a distance of 536.40 ft. returning to the point beginning containing 3.6109 acres more or less.

With the benefit of a 20 ft. drainage easement, said 20 ft. drainage easement extends from the north line of the hereinabove described 3.6109 acre tract in the northern direction to the centerline of Deer Creek, and is tangent to, and 10 ft. left and right of the following described centerline: beginning at a point in the north line of the hereinabove described 3.6109 acre tract, said point bears South 72° 13 minutes 51 seconds East a distance of 10.1 ft. from an iron pin and cap previously set at the northwest corner of said 3.6109 acre tract, thence, North 07° 17 minutes 37 seconds East a distance of 735.98 ft. to a point in the centerline of Deer Creek and the northern terminus of said 20 ft. drainage easement.

Bearings are based on the centerline of Green Lane (South 25° 29 minutes 18 seconds West) as described in official record 71 page 679.

This deed is subject to and with the benefit of all legal highways, restrictions, easements, limitations, and reservations, of record, if any and to zoning restrictions which have been imposed thereon, if any.

All iron pins set are 5/8 inch diameter rebar with yellow plastic caps stamped "Cottrill 6858."

This description is based on a field survey performed March 18, 2005 by James R. Cottrill registration #6858. (Job #S050310)

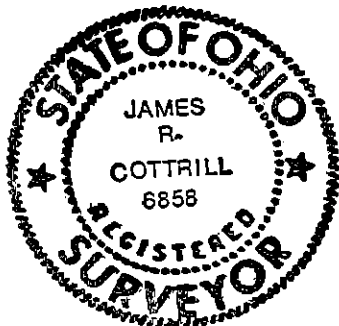

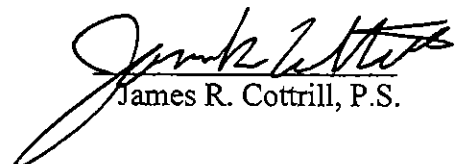
James R. Cottrill, P.S.