

BEARINGS BASED ON THE  $\bar{C}$  OF TAYLOR-BLAIR ROAD (S40°30'E)  
AS DESCRIBED IN OFFICIAL RECORD 154, PAGE 296.

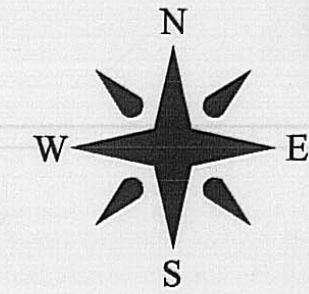

**DEED REFERENCE**  
**CHRISTOPHER G. & JACKIE S. CAMPBELL**  
**OFFICIAL RECORD 194 PAGE 1901**  
**85.00 ACRES (ORIGINAL)**

REGINA A. COLLINS  
DEED BOOK 270, PAGE 503  
5.15 AC.

U.S. ROUTE 42 (60'R/W)

2.6560± ACRES

2.6561± ACRES

TAYLOR BLAIR ROAD (CR 14)(50'R/W)

**LEGEND**

- ⊙ 3/4" SOLID IRON PIN (FOUND)
- ☆ COUNTY MONUMENT BOX (FOUND)
- DIA. SOLID IRON PIN (FOUND)
- ⊙ CONCRETE NAIL & WASHER (PREVIOUSLY SET)
- RAIL ROAD SPIKE (PREVIOUSLY SET)
- MAG NAIL (SET)
- ⊕ 5/8"  $\phi$  REBAR & YELLOW PLASTIC CAP STAMPED "COTTRILL 6858" (SET)

ALL MONUMENTS FOUND OR SET ARE IN GOOD  
CONDITION UNLESS OTHERWISE NOTED.

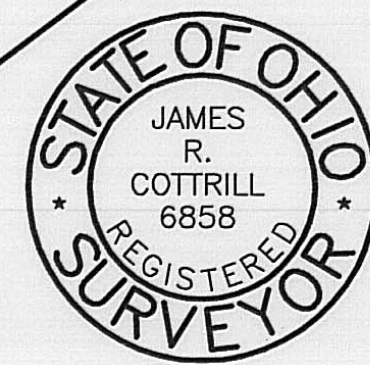

I HEREBY CERTIFY THAT THIS PLAT DEPICTS  
AN ACTUAL FIELD SURVEY PERFORMED BY  
JAMES R. COTTRILL P.S. #6858

*James R. Cottrill* DATE: 12/12/05

**COTTRILL SURVEYING, L.L.C.**

8256 S.R. 207 N.E. MT. STERLING, OHIO 43143 PH. (740) 869-3811

**2.6560 & 2.6561 ACRE TRACTS,**  
**V.M.S. 6000, JEFFERSON TOWNSHIP**  
**MADISON COUNTY, STATE OF OHIO.**  
**SURVEYED FOR FRANK ZOLLINGER**

DATE DRAWN:  
12/12/05  
JOB # S051205  
F. B. #38

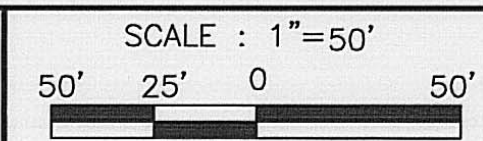

CREW: MW, TB  
DWN. BY: MW  
CK. BY: RC

39-06



2.6560 Acre Tract  
Surveyed for Frank Zollinger

The following described 2.6560 acre tract is situated in the State of Ohio, Madison County, Jefferson Township, V.M.S. 6000 and being part of a 85.00 (Original Acre) Tract conveyed to Christopher G. & Jackie S. Campbell by Official Record 194 Page 1901;

Commencing at a Madison County Monument box found in the centerline intersection of U.S. Route 42 (60 ft. right-of-way) and Taylor Blair Road (County Road 14)(50 ft. right-of-way);

Thence, with the centerline of said Taylor Blair Road South 40° 30 minutest 00 seconds East passing a railroad spike previously set by this surveyor at 281.54 ft. a total distance of 353.81 ft. to a mag nail set in the southernmost corner of a 5.15 acre tract conveyed to Regina A. Collins by Deed Book 270 Page 503 and the westernmost corner to said Campbell's 85.00 acre tract, said mag nail also being the true point of beginning;

Thence, with the line between said Collins and Campbell North 52° 53 minutes 13 seconds East passing an iron pin and cap set at 25.50 ft. a total distance of 579.49 ft. to a 3/4" solid iron pin (found) in the easternmost corner of said Collin's 5.15 acre tract;

Thence, with a new line across said Campbell's 85.00 acres the following 2 new courses:

- 1) South 40° 30 minutes 00 seconds East a distance of 200.00 ft. to an iron pin and cap set
- 2) South 52° 53 minutes 13 seconds West passing an iron pin and cap set at 555.49 ft. a total distance of 579.49 ft. to a mag nail set in the centerline of said Taylor Blair Road

Thence, with said centerline North 40° 30 minutes 00 seconds West a distance of 200.00 ft. returning to the point of beginning containing 2.6560 acres more or less.

Bearings are based on the centerline of Taylor Blair Road (South 40° 30 minutes 00 seconds East) as described in Official Record 154 Page 296.

This deed is subject to and with the benefit of all legal highways, restrictions, easements, limitations, and reservations, of record, if any and to zoning restrictions which have been imposed thereon, if any.

All iron pins set are 5/8 inch diameter rebar with yellow plastic caps stamped "Cottrill L.L.C. 6858."

This description is based on a field survey performed December 12, 2005 by James R. Cottrill registration #6858. (Job #S051205)

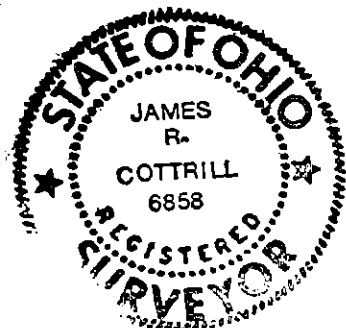

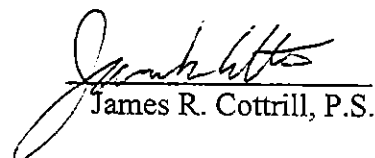
  
James R. Cottrill, P.S.

2.6561 Acre Tract  
Surveyed for Frank Zollinger

The following described 2.6561 acre tract is situated in the State of Ohio, Madison County, Jefferson Township, V.M.S. 6000 and being part of a 85.00 (Original Acre) Tract conveyed to Christopher G. & Jackie S. Campbell by Official Record 194 Page 1901;

Commencing at a Madison County Monument box found in the centerline intersection of U.S. Route 42 (60 ft. right-of-way) and Taylor Blair Road (County Road 14)(50 ft. right-of-way);

Thence, with the centerline of said Taylor Blair Road South 40° 30 minutest 00 seconds East passing a railroad spike previously set by this surveyor at 281.54 ft., also passing a mag nail set at 353.81 ft. a total distance of 553.81 ft., said mag nail also being the true point of beginning:

Thence, with a new line across said Campbell's 85.00 acre tract the following 3 new courses:

- 1) North 52° 53 minutes 13 seconds East passing an iron pin and cap set at 24.00 ft. a total distance of 579.49 ft. to an iron pin and cap set
- 2) South 40° 30 minutes 00 seconds East a distance of 200.01 ft. to an iron pin and cap set
- 3) South 52° 53 minutes 13 seconds West passing an iron pin and cap set at 554.74 ft. a total distance of 579.49 ft. to a mag nail set in the centerline of said Taylor Blair Road

Thence, with said centerline North 40° 30 minutes 00 seconds West a distance of 200.01 ft. returning to the true point of beginning containing 2.6561 acres more or less.

This deed is subject to and with the benefit of all legal highways, restrictions, easements, limitations, and reservations, of record, if any and to zoning restrictions which have been imposed thereon, if any.

All iron pins set are 5/8 inch diameter rebar with yellow plastic caps stamped "Cottrill L.L.C. 6858."

This description is based on a field survey performed December 12, 2005 by James R. Cottrill registration #6858. (Job #S051205a)

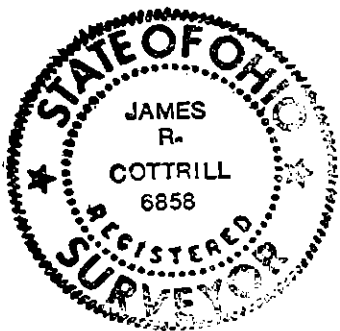

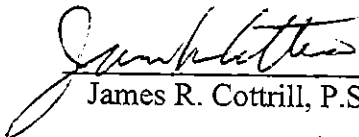
  
James R. Cottrill, P.S.