

JAMES TYSON THOMAS
OFFICIAL RECORD 114 PAGE 1368
7.25 ACRES

POINT OF BEGINNING

BEARINGS BASED ON THE SOUTHWEST LINE OF GILL'S 0.7413 ACRE TRACT
(S 45°07'00" E) AS DESCRIBED IN OFFICIAL RECORD 135 PAGE 913.

DEED REFERENCE
MARIA G. GILL
OFFICIAL RECORD 135 PAGE 913
0.7413 ACRES

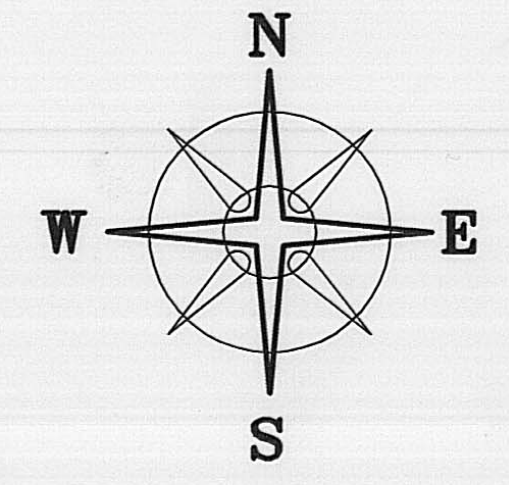

0.0593± ACRES

MARIA G. GILL
OFFICIAL RECORD 49 PAGE 212
.324 ACRES

RICHARD & JUDITH
BIDWELL
OFFICIAL RECORD 23 PAGE 862
0.564 ACRES

BILLY J. WILSON
OFFICIAL RECORD 110 PAGE 402
0.1722 ACRES

****NOTE****

THE 0.0593 ACRE TRACT IS TO BECOME
PART OF AND CONTINGENT TO WILSON'S 0.1722 ACRE TRACT

LEGEND

- ⊙ 5/8" ⌀ REBAR & YELLOW PLASTIC CAP STAMPED "R.I. BAKER S5939" (FOUND)
- 3/4" IRON PIPE (FOUND)
- ⊙ 5/8" ⌀ REBAR & YELLOW PLASTIC CAP STAMPED "COTTRILL 6858" (SET)

ALL MONUMENTS FOUND OR SET ARE IN GOOD
CONDITION UNLESS OTHERWISE NOTED.

OLD R/W LINE
ORIGINAL CENTERLINE OF GARFIELD AVENUE
GARFIELD AVENUE (50' WIDE)
OLD R/W LINE
CURB
(RELOCATED)

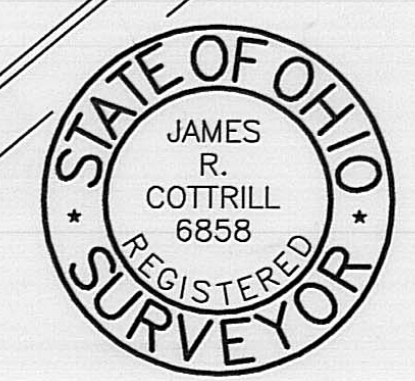

I HEREBY CERTIFY THAT THIS PLAT DEPICTS
AN ACTUAL FIELD SURVEY PERFORMED BY
JAMES R. COTTRILL P.S. #6858
James R. Cottrill DATE: 2/20/06

COTTRILL SURVEYING, L.L.C.
8256 S.R. 207 N.E. MT. STERLING, OHIO 43143 PH. (740) 869-3811

0.0593 ACRES, V.M.S. 8863,
CITY OF LONDON, MADISON COUNTY
STATE OF OHIO.
SURVEYED FOR BILLY WILSON

DATE DRAWN: 2/10/06	SCALE: 1" = 20'	CREW: MW
JOB # S060208	20' 10' 0 20'	DWN. BY: MW
F. B. # 39		CK. BY: RC

55.06

0.0593 Acre Tract
Surveyed for Billy Wilson

The following described 0.0593 acre tract is situated in the State of Ohio, City of London, Madison County, V.M.S. 8863, and being part of a 0.7413 acre tract conveyed to Maria G. Gill by Official Record 135 Page 913 and being more particularly described as follows:

Commencing at a 5/8" rebar and yellow plastic cap stamped "R.I. Baker S5939" found in the northeast corner of a 0.564 acre tract conveyed to Richard & Judith Bidwell by Official Record 23 Page 862, said rebar is also in the northwest corner of said Gill's 0.7413 acre tract;

Thence, with the line between said Gill & Bidwell South 45° 07 minutes 00 seconds East a distance of 226.29 ft. to an iron pin and cap set in said line, said iron pin and cap also being the **true point of beginning**;

Thence, with a new line across said 0.7413 acre tract North 50° 54 minutes 50 seconds East a distance of 60.09 ft. to an iron pin and cap set in the southwest line of a 0.324 acre tract conveyed to Maria G. Gill by Official Record 49 Page 212, from said iron pin and cap a 3/4" pipe found in the northwest corner of said 0.324 acre tract bears North 45° 06 minutes 03 seconds West a distance of 7.26 ft.;

Thence, with the southwest line of said 0.324 acre tract South 45° 06 minutes 03 seconds East a distance of 42.74 ft. to a 3/4" iron pipe found in the northeast corner of a 0.1722 acre tract conveyed to Billy J. Wilson by Official Record 110 Page 402;

Thence, with the northwest line of said 0.1722 acre tract South 49° 58 minutes 25 seconds West a distance of 59.98 ft. to a 3/4" iron pipe found in the westernmost corner of said 0.1722 acre tract and in the northeast line of said Bidwell's 0.564 acre tract;

Thence, with the northeast line of said Bidwell and the southwest line of said Gill's 0.7413 acre tract North 45° 07 minutes 00 seconds West a distance of 43.73 ft. returning to the **point of beginning** containing 0.0593 acres more or less:

Said 0.0593 acre tract is to become part of and contingent to Wilson's 0.1722 acre tract.

Bearings are based on the southwest line of Gill's 0.7413 acre tract (South 45° 07 minutes 00 seconds East) as described in Official Record 135 page 913;

This deed is subject to and with the benefit of all legal highways, restrictions, easements, limitations, and reservations, of record, if any and to zoning restrictions which have been imposed thereon, if any.

All iron pins set are 5/8 inch diameter rebar with yellow plastic caps stamped "Cottrill L.L.C. 6858."

This description is based on a field survey performed February 13, 2006 by James R. Cottrill registration #6858. (Job #S060208)

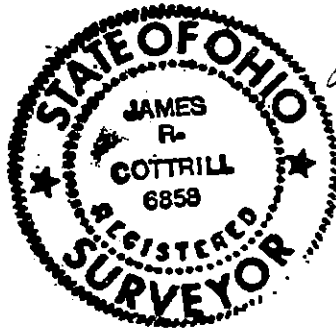

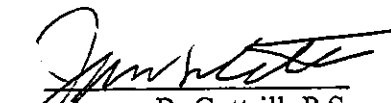
James R. Cottrill, P.S.