

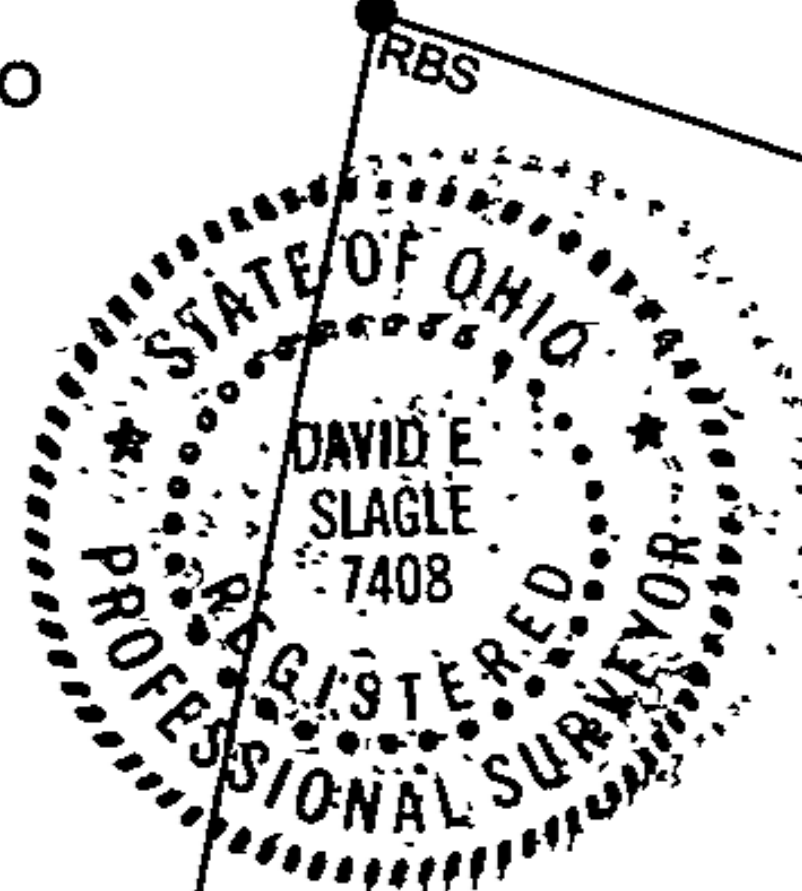

SITUATED IN THE STATE OF OHIO
MADISON COUNTY
DARBY CREEK TOWNSHIP
PART OF V.M.S. 7059



I CERTIFY THAT THIS PLAT AND THE DESCRIPTION
DEVELOPED FROM IT MEETS THE MINIMUM
STANDARDS FOR BOUNDARY SURVEYS IN OHIO,
AS DESCRIBED IN CHAPTER 4733-37 OF THE
ADMINISTRATIVE CODE. THIS PLAT AND THE
DESCRIPTION DEVELOPED FROM IT ARE BASED
ON AN ACTUAL FIELD SURVEY IN NOVEMBER 2006.

David E. Slagle 11/21/06
DAVID E. SLAGLE DATE
PROFESSIONAL SURVEYOR # 7408

13.653 ACRES REMAINING BY SURVEY
PART OF ORIGINAL 20 ACRES
CRAIG A. LOMBARD
OFFICIAL RECORD 192, PAGE 673

JOHNATHON & KIETH HOSTETLER
OFFICIAL RECORD 92, PAGE 0524

JEANNE RHOADES, ETAL.
OFFICIAL RECORD 162, PAGE 25

STONE FD.
SET LARGE
PIN NEXT
TO STONE

STONE FD.
SET LARGE
PIN NEXT
TO STONE

4.715 ACRES BY SURVEY
PART OF ORIGINAL 20 ACRES
CRAIG A. LOMBARD
OFFICIAL RECORD 192, PAGE 673

2.010 ACRE TRACT
ZENDALL GINGERICH
D.B. 221, PG. 221

RBS
PKS

N 12°46'29"E 328.96'
(32.37')
N 54°10'48"W 266.84'
N 57°20'47"W 105.60'

LOMBARD-CHUCKERY ROAD
CO. RD. 29 (60' WIDE)

200' 400'
SCALE 1"=200'

DETAIL
N 57°36'00"W 213.05'
N 55°44'55"W 4.90'
N 87°04'45"W 19.13'
RRS FD IPF
IPF P.O.R.

FOR: CRAIG A. LOMBARD

XYZ

DATE: 11/21/06 JOB NO 26-189
SCALE: 1" = 200' F.B. NO
REVISED: MAP NO 26-189

SURVEY SERVICE INC.
3011 COLUMBUS STREET
GROVE CITY OH 43123
FAX: 614-875-7882 PH: 614-539-8220

DRAWN BY: MP
CKD BY: D.E.S.
CAD FILE LOMBARD

DELEON
O.R. 98-2464
RRS FD SEE DETAIL
ROSEDALE-
PLAIN CITY RD.
CO. RD. 24
P.O.R.

LEGAL DESCRIPTION

TRACT NO. 1

4.715 ACRES

A tract of land located in the State of Ohio, Madison County, Darby Creek Township and being a part of Virginia Military Survey No. 7059 and being a part of an 18 acre tract as recorded in Deed Book 192 Page 673 in the Madison County Records and now more particularly described by metes and bounds as follows:

Beginning for reference at an iron pin buried in the road at the intersection of Lombard-Chuckery Road (County Road 29) and Rosedale-Plain City Road (County Road 24);

Thence North 87 degrees 04 minutes 45 seconds West 19.13 feet to an iron pin;

Thence North 55 degrees 44 minutes 55 seconds West 4.90 feet to a railroad spike at the southeast corner of a small tract owned by Charles and Deborah Deleon (OR 98 Page 2464);

Thence along the centerline of Lombard-Chuckery Road (County Road 29) North 57 degrees 36 minutes 00 seconds West 213.05 feet to a railroad spike buried in the center of the road at the southwest corner of the Deleon property;

Thence continue along the centerline of said road North 57 degrees 20 minutes 47 seconds West 471.22 feet to a P.K. nail at the southeast corner of a 2 acre tract owned by Zendall Gingerich (Book 221 Page 221);

Thence continue along said centerline North 57 degrees 20 minutes 47 seconds West 200.00 feet to a P.K. nail for the **True Point of Beginning** of the tract of land herein and hereby conveyed;

Thence continue along said centerline North 57 degrees 20 minutes 47 seconds West 105.60 feet to a P.K. nail set;

Thence North 54 degrees 10 minutes 48 seconds West 266.64 feet to a P.K. nail set at the southeast corner of the Jeane Rhoads property;

Thence leaving said centerline North 12 degrees 46 minutes 29 seconds East (passing a 5/8 inch rebar set with cap stamped XYZ at 32.37 feet), a total distance of 328.96 feet to an existing stone (set large pin beside stone);

Thence South 84 degrees 30 minutes 00 seconds East 583.45 feet to a stone (set large pin beside stone);

Thence South 11 degrees 44 minutes 20 seconds West 163.33 feet to a 5/8 inch rebar set with cap stamped XYZ in the North line of the Gingerich property;

Thence North 57 degrees 20 minutes 40 seconds West along the Gingerich property 93.76 feet to a 5/8 inch rebar set with cap stamped XYZ;

Thence South 32 degrees 39 minutes 11 seconds West (passing a 5/8 inch rebar set with cap stamped XYZ at 407.79 feet), a total of 437.79 feet to the **Point of Beginning**.

Containing 4.715 acres all in Madison County, Ohio.

Subject to all easements, reservations, and rights-of-way of record.

Survey made during October and November, 2006 by David E. Slagle, P.S. No. 7408 of XYZ
Survey Service Ltd.

David E. Slagle
David E. Slagle, P.S. No. 7408

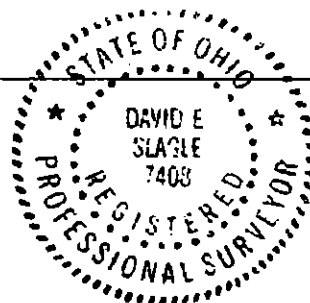

NOV 21, 2006
Date

26-189