

PLAT OF SURVEY

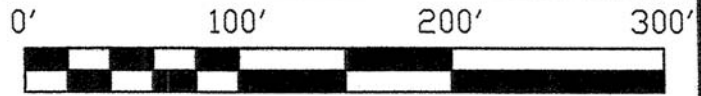

SCALE 1" = 100'

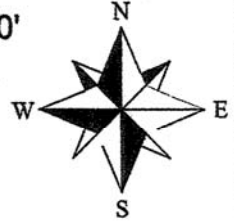

CAMP CHASE RAILROAD
O.R. 13, PG. 688 N

S 87°05'29" E 46.17'
S 87°25'12" E 350.55'
09°23'03" W 86.85'
3/4" IPF W/
COTTRILL CAP

REBAR SET
WOOD FENCE POST
FOUND (LEANING)
0.9' SOUTH

S & S INVESTMENTS
4.35 AC.
O.R. 242, PG. 2672

RAYMOND ELWOOD COTTON
4.6437 AC.
O.R. 240, PG. 145

4.697 ACRES
(TOTAL, BY SURVEY)

PLAT OF SURVEY
4.697 ACRES (BY SURVEY)
LOCATED IN VMS 5280,
VILLAGE OF LILLY CHAPEL,
FAIRFIELD TOWNSHIP,
MADISON CO., OHIO

REMAINDER OF
"PARCEL II"

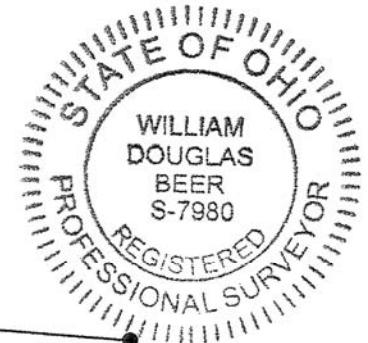

3/4" IPF W/
COTTRILL CAP
3/4" IPF W/
COTTRILL CAP
3/4" IPF W/
COTTRILL CAP

N 85°51'49" W WOOD FENCE POST FOUND

REBAR SET
WOOD FENCE POST FOUND
0.7' NORTH

HARROW TOOTH FOUND (SET IN CONC.)
COMMENCING FOR REFERENCE POINT

DAVID JR. & PATRICIA BOYSEL, 0.27 AC. O.R. 195, PG. 2391

YOLANDO O. WILLIAMS, 0.23 AC. O.R. 50, PG. 940

"PARCEL I"
METEL FENCE POST FOUND
T.P.O.B.

MARCUS W. WATKINS, 0.37 AC. O.R. 16, PG. 62

RAY D. & JUDITH E. JOHNSON, 0.59 AC. O.R. 203, PG. 231

3/4" IPF W/
PLUMMER CAP

LEGEND:

- ⊙ = 5/8" - REBAR SET (w/ "S-7980" CAP)
- = IRON PIN FOUND (as noted)
- = CONC. FENCE POST FOUND
- ⊙ = WOOD FENCE POST FOUND
- ◊ = HARROW TOOTH FOUND
- ◇ = "MAG" NAIL SET

WEST JEFFERSON - KIOUSVILLE RD.

S 84°53'48" E 579.20'

N 84°53'48" W 97.91'

LILLY CHAPEL - GEORGESVILLE RD. (C.R. 102)

Bearings are based on N 02° 04' 46" E, as given for the easterly line of that 0.5723 acre tract conveyed in O.R. 137, Page 448, of record in the Madison County Recorder's Office, Madison County, Ohio.

I hereby certify that this boundary survey was prepared from an actual field survey and to the best of our knowledge and belief is correct and that this plat was prepared in accordance with Ohio Administrative Code Chapter 4733-37 "Standards for Boundary Surveys". All monumentation is found or to be set as shown.

BENCHMARK LAND SURVEYING
3501 MANILA DRIVE
WESTERVILLE, OH 43081
(614) 794-9609 ~ Office
(614) 899-0336 ~ Fax
bmlsurveying@yahoo.com

63-10

William D. Beer 10/14/2010
William D. Beer Date
Registered Professional Surveyor No. 7980

October 14, 2010

DESCRIPTION OF A 4.697 ACRE TRACT

Situated in the Village of Lilly Chapel, Township of Fairfield, County of Madison, State of Ohio, located in VMS #5280, being 4.6437 acres (Auditors Tax Map Record), conveyed as "Parcel I" and "Parcel II" to Raymond Elwood Cotton in O.R. 240, Page 145, said 4.6437 acres (4.697 acres by survey) being more particularly described as:

Commencing for reference at a point marking the intersection of the centerline of Lilly Chapel-Georgesville Road (County Road 102) and the centerline of West Jefferson-Kiousville Road;

Thence, South 84° 53' 48" East, with the centerline of said Lilly Chapel-Georgesville Road, a distance of 579.20 feet to a mag nail set in said centerline, being the southwesterly corner of said "Parcel I", being the southeasterly corner of that 0.23 acre tract conveyed to Yolando O. Williams in O.R. 50, Page 940 and being the TRUE PLACE OF BEGINNING;

Thence, from said TRUE PLACE OF BEGINNING, North 04° 35' 09" East, with the westerly line of said "Parcel I", and with the easterly line of said 0.23 acres, passing a metal fence post ("end post" in previous conveyance) found at a distance of 29.36 feet, a total distance of 155.47 feet to a wood fence post found at the northwesterly corner of said "Parcel I", the same being in the southerly line of the remainder of said "Parcel II" and being the northeasterly corner of said 0.23 acres;

Thence, North 85° 51' 49" West, with the southerly line of said remainder, with the northerly line of said 0.23 acres and with a portion of the northerly line of that 0.27 acre tract of land conveyed to David Jr. and Patricia Boysel in O.R. 195, Page 2391, a distance of 110.42 feet to a harrow tooth (in concrete) found at the southwesterly corner of said remainder, the same being in the northerly line of said 0.27 acres and being the southeasterly corner of that 0.5723 acre tract conveyed to Kevin Rawlings in O.R. 137, Page 449;

Thence, North 02° 04' 46" East, with the westerly line of said remainder and with the easterly line of said 0.5723 acres, a distance of 416.23 feet to a 3/4-inch iron pin with cap ("Cottrill") found at a northerly corner of said remainder, the same being the northeasterly corner of said 0.5723 acres and being in the southerly right-of-way line of the Camp Chase Railroad, of record in O.R. 13, Page 688;

1243-10

Page Two (4.697 Ac.)

Thence, South 87° 05' 29" East, with a northerly line of said 4.6437 acres and with a southerly line of said railroad right-of-way, a distance of 46.17 feet to a concrete fence post found at an angle point;

Thence, North 09° 23' 03" West, with a westerly line of said remainder and with an easterly line of said railroad right-of-way, a distance of 86.85 feet to concrete fence post found at the northwesterly corner of said remainder, the same being in said southerly right-of-way line;

Thence, South 87° 25' 12" East, with a northerly line of said remainder and with said southerly right-of-way line, a distance of 350.55 feet to a rebar set at the base of a (leaning) wood fence post, said rebar set being the northeasterly corner of said remainder, being in said southerly right-of-way line and being the northwesterly corner of that 4.35 acre tract conveyed to S & S Investments in O.R. 242, Page 2672;

Thence, South 02° 12' 32" West, with an easterly line of said remainder and with a westerly line of said 4.35 acres, a distance of 515.35 feet to a rebar set (wood fence post found 0.7 feet north) at the southeasterly corner of said remainder, the same being in the northerly line of that 0.59 acre tract conveyed to Ray D. and Judith E. Johnson in O.R. 203, Page 231;

1243-10

Thence, North 85° 32' 18" West, with a southerly line of said remainder, with a portion of the northerly line of said 0.59 acres and with the northerly line of that 0.37 acre tract conveyed to Marcus W. Watkins in O.R. 16, Page 62, a distance of 169.04 feet to a 1/2-inch iron pin found at the northeasterly corner of said "Parcel I", the same being the northwesterly corner of said 0.37 acres;

Thence, South 05° 04' 46" West, with the easterly line of said "Parcel I" and with the westerly line of said 0.37 acres, passing a 1/2-inch iron pin found at a distance of 121.30 feet, a total distance of 153.95 feet to a mag nail set in the centerline of said Lilly Chapel-Georgesville Road, the same being the southeasterly corner of said "Parcel I" and being the southwestery corner of said 0.37 acres;

Thence, North 84° 53' 48" West, with the centerline of said road and with the southerly line of said "Parcel I", a distance of 97.91 feet to the TRUE PLACE OF BEGINNING.

Containing 4.697 acres of land (by Survey).
Subject to all easements, restrictions and rights-of-way of record.
All rebar's set are 5/8-inch in diameter and 30-inches long with a cap bearing the inscription "S-7980".
Bearings are based on North 02° 04' 46" East, as given for the easterly line of that 0.5723 acre tract conveyed in O.R. 137, Page 448.

All references are to records of the Recorder's Office, Madison County, Ohio.

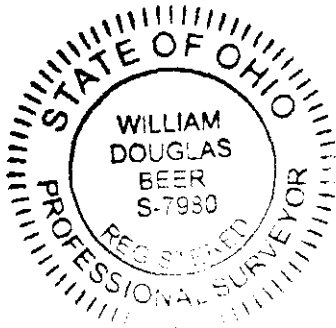

William D. Beer 10/14/2010
Date
Registered Professional Surveyor No. 7980