

7-10

Bill G. & Kay Graham
99.00 Ac.
Deed Book 257, Page 98

Leonard A. & Elizabeth A. Brinkneader
72.00 Ac.
Official Record 101, Page 1630

139.000 Acres
Candle Fire Investments LTD., LLC
139.167 Ac.
Official Record 252, Page 1896

Albert R. & Shela A. McIntier
100.06 Ac.
Official Record 121, Page 436

Albert R. & Shela A. McIntier
96.557 Ac.
Official Record 212, Page 398

McKendree Road (T-55)

N03°10'00"E 1084.38'

N45°52'00"E 1425.860'

Nioga-Toops Road (C-60)

S03°10'00"W 2889.23' Total

N45°52'00"E 1425.860'

Iron Pin Set

Iron Pin Set
Ø 35.00'

Iron Pin Set

Iron Pin Set

Iron Pin Found

Iron Pin Found

Iron Pin Found
Ø 19.89'

P.K. Nail Found

S87°28'44"E 2695.87' Total

N88°29'26"W 1143.82'

N02°49'17"E 1214.22' Total

N66°18'03"W 287.81'

N83°51'56"W 1277.65'

Parcel 1 - 89.00 Acres
Parcel 2 - 50.00 Acres

Parcel 1 - 52.637 Acres
Parcel 2 - 42.63 Acres

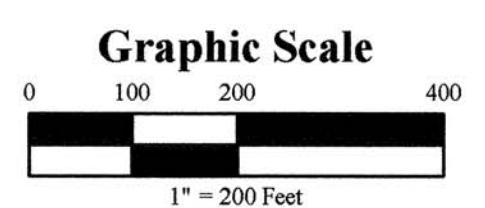
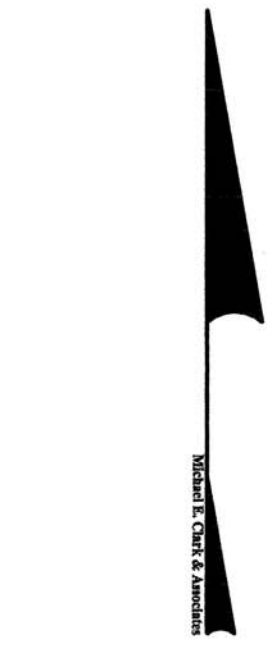
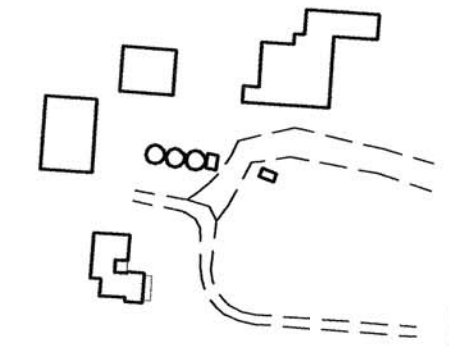

Legend

- Iron Pin Set
- Iron Pin Found
- ▲ Railroad Spike Set
- △ Railroad Spike Found
- P.K. Nail Set
- P.K. Nail Found
- Post Found



BEARING REFERENCE: CENTERLINE OF NIOGA-TOOPS ROAD AS DESCRIBED IN OFFICIAL RECORD 252, PAGE 1896 BEING S03°10'00"W.
IRON PINS SET ARE 5/8" DIAMETER X 30" REBAR WITH YELLOW PLASTIC CAP STAMPED "M.E. CLARK ASSOC."
ALL IRON PINS SHOWN AS FOUND ARE IN GOOD CONDITION UNLESS NOTED OTHERWISE.
I HEREBY CERTIFY THAT THE ATTACHED PLAT IS A TRUE REPRESENTATION OF A SURVEY PERFORMED BY MICHAEL E. CLARK & ASSOCIATES UNDER MY DIRECT SUPERVISION AND THAT THE ACCURACY OF SAID SURVEY IS CONSISTENT WITH CURRENT ACCEPTED SURVEYING STANDARDS.

Michael E. Clark
MICHAEL E. CLARK P.S. #6808

11-18-09
DATE

MICHAEL E.	
CLARK & ASSOCIATES	
ENGINEERS - SURVEYORS - PLANNING CONSULTANTS	
115 WEST MAIN STREET CIRCLEVILLE, OHIO 43113	
PHONE (740) 474-6333	FAX (740) 474-9553
PLEASANT TOWNSHIP, MADISON COUNTY, OHIO	
V.M.S. 5799	
PLAT OF SURVEY	
For: The Owen Firm	
File No.: S09-2654	Drawn By: JAF
Date: November 2009	Scale: 1" = 200'

Legal Description
Pleasant Township, Madison County, Ohio
V.M.S. 5799
139.000 Acres
For: The Owen Firm

Situated in the Township of Pleasant, County of Madison, the State of Ohio and a part of V.M.S. 5799 being more particularly bounded and described as follows,

Being all of a 139.167 acre tract described in three parcels in Official Record 252, Page 1896 in the Madison County Recorder's Office.

Beginning at a pk nail found in the centerline of Nioga-Toops Road at the Southeast corner of said tract and the Northeast corner of a 96.557 acre tract (reference Official Record 212, Page 398);

Thence leaving said centerline and going with the line between said tracts N83°51'56"W 1277.65 feet (passing an iron pin found at 19.88 feet) to an iron pin found;

Thence with another line between said tracts N66°18'03"W 287.81 feet to an iron pin found at a Southwest corner of said 139.167 acre tract, the Northwest corner of said 96.557 acre tract and in the East line of a 100.06 acre tract (reference Official Record 121, Page 436);

Thence with said East line N02°49'17"E 1214.22 feet to an iron pin set at the Northeast corner of said 100.06 acre tract;

Thence with the North line of said tract N88°29'26"W 1143.82 feet to an iron pin set at the Northwest corner of said 100.06 acre tract, a Southwestern corner of said 139.167 acre tract and in the East line of a 99.00 acre tract (reference Deed Book 257, Page 98);

Thence with said East line N03°10'59"E 1490.64 feet to an iron pin set at the Northeast corner of said 99.00 acre tract, the Northwest corner of said 139.167 acre tract and in the South line of a 72.00 acre tract (reference Official Record 101, Page 1630);

Thence with said South line S87°28'44"E 2695.87 feet (passing an iron pin set at 2660.87 feet) to a point in the centerline of Nioga-Toops Road at the Southeast corner of said 72.00 acre tract from which a railroad spike was found N03°10'00"E 1084.38 feet distant;

Thence with said centerline S03°10'00"W 2869.23 feet to the **POINT OF BEGINNING**;

Containing **139.000 Acres**, more or less.

Subject to all existing valid rights-of-way and easements of record.

Bearings as shown are based on the centerline of Nioga-Toops Roads as described in Official Record 252, Page 1896 being S03°10'00"W.

I hereby certify that the foregoing legal description and the attached plat are a true representation of the conditions as they existed on the date of the survey and that the accuracy of same is consistent with accepted surveying standards.

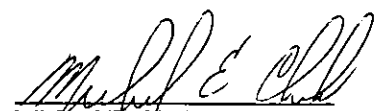
Michael E. Clark
Professional Surveyor # 6808



File No. S09-2654

11-18-09
Date