

JOHN E. WILSON
AND
CHRISTINA R. WILSON
O.R. 255, PAGE 128
92.851 Ac.
P.N. 05-00207.000
SURVEY PLAT 13-10

ROMAN CATHOLIC BISHOP
OF THE
DIOCESE OF COLUMBUS
D.B. 280, PAGE 720

PAUL W. SCHROCK
O.R. 98, PAGE 1739
TRACT 1
178.877 Ac.
P.N. 05-00214.000
SURVEY PLAT 42-99

RYAN McMURRAY
AND
ELIZABETH E. CLUCHEY
O.R. 232, PAGE 1983
TRACT II
51.981 Ac.
P.N. 05-00156.000
SURVEY PLAT DE-24A

PARCEL I
TRACT THREE
37.6240 Ac.
P.N. 05-00224.000
SURVEY PLAT DE-21E
(37.604 Ac.)

41.476 Ac.

NATIONAL GEODETIC SURVEY CONTROL MONUMENTS		ELLIPSOID		OHIO STATE PLANE COORDINATES		NAVD 88
NAD 83 (2011)		LATITUDE	LONGITUDE	NORTHING	EASTING	ELEVATION
NAME	MADISON COUNTY CORRS (OHMD)	39°52'28.79991"N	83°28'45.11264"W	684287.1812	1693677.0030	-
	RESIDUALS			ΔH = 0.000 SFT		ΔV = -
MAD12-016		39°57'06.066968"N	83°22'37.915789"W	890.983	712047.3823	1722575.8039
	RESIDUALS				ΔH = 0.087 SFT	ΔV = +0.034 SFT
TRUCK (2001)		39°57'10.14483"N	83°22'55.14938"W	894.866	712473.0669	1721237.8033
	RESIDUALS					1003.203
SITE BASE STATION "TRUCK (2001)" LOCAL SITE SETTINGS						
GROUND SCALE FACTOR: 1.0000576428		LOCAL GROUND COORDINATES				NAVD 88
GEOID MODEL: GEOID09 (CONUS)		NORTHING		EASTING		ELEVATION
		712473.0669		1721237.8033		1003.203
				UNITS ARE IN U.S. SURVEY FEET (SFT)		
		P.O.B. N. 716,116.890		E. 1,716,680.830		
		MAD12-016 - P.O.B. N 55°22'53" W		7163.29'		
		MAD12-016 - TRUCK (2001) N 72°21'6" W		1404.17'		

VOLUME _____ PLAT NO. _____
MADISON COUNTY ENGINEER'S
RECORD OF LAND SURVEYS
DATE AUGUST 31, 2015
SCALE 1"=200'
DEED REFERENCE
DEED BOOK 280 PAGE 720
TOWNSHIP DEERCREEK
MILITARY SURVEY NUMBER

BEARINGS ARE BASED UPON THE GRID AZIMUTH (AZ 46°09'04.5") BETWEEN NATIONAL GEODETIC SURVEY CORRS STATION "OHMD" AND MADISON COUNTY GEODETIC SURVEY MONUMENT "MAD 02-016" AND DERIVED FROM GPS OBSERVATIONS TAKEN JULY 25, 2014, UTILIZING THE TRIMBLE ODOT CORRS VRS (VIRTUAL REFERENCE SYSTEM).

LEGEND

- 5/8" IRON PIN (SET) WITH PLASTIC CAP STAMPED "McCARTY ASSOCIATES"
- 5/8" IRON PIN (FOUND)
- 1" IRON PIPE (FOUND)
- ◇ 4 1/2" STEEL POST (FOUND)
- MAG NAIL (FOUND)
- ⊙ MAG NAIL (SET)
- P.K. NAIL (FOUND)
- x- WOVEN WIRE FENCE GENERALLY ON OR NEAR LINE UNLESS OTHERWISE SHOWN.

DEED REFERENCE
ROMAN CATHOLIC BISHOP
OF THE
DIOCESE OF COLUMBUS
D.B. 280, PAGE 720
PARCEL I TRACT THREE 37.6240 Ac. P.N. 05-00224.000 SURVEY PLAT DE-21E
PARCEL I TRACT TWO 30.18 Ac. P.N. 05-00225.000

SURVEY FOR
MADISON COUNTY
BOARD OF COMMISSIONERS
DEERCREEK TOWNSHIP
MADISON COUNTY, OHIO
V.M.S. Nos. 8965-10927 & 12142-12153

McCARTY ASSOCIATES, LLC
ARCHITECTS — ENGINEERS — SURVEYORS
213 N. HIGH ST., HILLSBORO, OHIO 45133 PH. 937-393-9971 FAX 937-393-2480
1515 ST. RT. 28 SUITE E, LOVELAND, OHIO 45140 PH. 513-722-0300 FAX 513-722-0500
304 E. MARKET ST., WASHINGTON C.H., OHIO 43160 PH. 740-335-3816 FAX 740-335-5828
www.mccartyassociates.com

DATE	SCALE	PROJECT NO.
AUGUST 31, 2015	1"=200	S15-777

NOTES
THE ABOVE LISTED DEED REFERENCES WERE USED AS A BASIS FOR CARRYING OUT THE WORK.
NO EVIDENCE OF OCCUPATION EXISTS ALONG PROPERTY LINES INDICATED BY SOLID LINES.
ALL MONUMENTS FOUND OR SET ARE IN GOOD CONDITION UNLESS OTHERWISE INDICATED.

I HEREBY CERTIFY THIS TO BE A PLAT OF A SURVEY MADE UNDER MY DIRECTION IN AUGUST 2015.
Thomas E. Purcell
THOMAS E. PURCELL, P.S. 6519

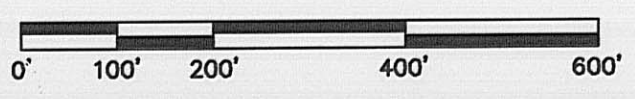
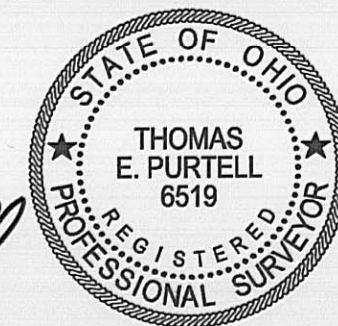

MCCARTY ASSOCIATES, LLC

ARCHITECTS—ENGINEERS—SURVEYORS

HILLSBORO ————— WASHINGTON C.H. ————— LOVELAND

213 N. HIGH ST., HILLSBORO, OHIO 45133 PH 937-393-9971 FAX 937-393-2480

Michael L. McCarty, P.E., P.S.— Thomas E. Purtell, P.S.— Loren M. Puckett, P.E.— Eric N. Lutz, P.S.— Jerrold B. Bradley, AIA

File No. S15-777
September 1, 2015

LEGAL DESCRIPTION

Roman Catholic Bishop
Of The Diocese of Columbus
To
Madison County Board of Commissioners
3.872 Acres Tract

Situated in the Township of Deercreek, County of Madison, State of Ohio, being a part of V.M.S. No. 12142-12153, contains 3.872 acres of the 30.18 acres "Parcel I, Tract Two" (Parcel No. 05-00225.000), as conveyed to the Roman Catholic Bishop of the Diocese of Columbus and recorded in Deed Book 280, Page 720 of the Madison County Recorder's Office, and being further bounded and described as follows:

Beginning at a 5/8" iron pin (set) near the east edge of the pavement of LaFayette-Plain City Road (County Road No. 5), said iron pin being a corner to the 92.851 acres tract as conveyed to John E. Wilson and Christina R. Wilson (O.R. 255, Page 128) as shown on Survey Plat No. 13-10, and having Ohio State Plane Coordinates Northing 716,116.890 feet, Easting 1,716,680.830 feet South Zone and based upon NAD 83 (2011);

thence with Wilson's southerly line S 70°23'00" E, passing a 5/8" iron pin (found) at 16.70 feet, a total distance of 3980.58 feet to a 4 1/2" diameter steel post (found) in the northwesterly line of the 178.877 acres "Tract 1" as conveyed to Paul W. Schrock (O.R. 98, Page 1739) as shown on Survey Plat No. 42-99;

thence with Schrock's northwesterly line S 43°42'12" W, a distance of 179.12 feet to a 1" iron pipe (found), said iron pipe being the northerly most corner of the 37.6240 acres "Parcel I, Tract Three" as conveyed to the Roman Catholic Bishop of the Diocese of Columbus and recorded in (D.B. 280, Page 720) ;

thence with northwesterly line of the 37.6240 acres "Parcel I, Tract Three" as conveyed to the Roman Catholic Bishop of the Diocese of Columbus S 48°33'34" W, a distance of 40.59 feet to a 5/8" iron pin (set);

thence with a new division line for the next three calls:

- (1) N 51°13'02" W, a distance of 36.70 feet to a 5/8" iron pin (set);
- (2) N 28°15'35" E, a distance of 148.68 feet to a 5/8" iron pin (set);
- (3) N 70°23'00" W, passing a 5/8" iron pin (set) at 3848.68 feet, a total distance of 3872.03 feet to a Mag nail (set) in LaFayette-Plain City Road;

thence with LaFayette-Plain City Road N 14°38'00" E, a distance of 40.15 feet to the beginning, containing 3.872 acres of land.

Subject to all legal easements and rights-of-way of record.

Bearings are based upon the Grid Azimuth (AZ. 46° 09' 04.5") between National Geodetic Survey CORS Station "OHMD" and Madison County Geodetic Survey Monument "MAD 02-016" and derived from GPS observations taken July 25, 2014, utilizing the Trimble ODOT CORS VRS (Virtual Reference System).

Land surveyed in August 2015, under the direction of Thomas E. Purtell, Registered Professional Surveyor No. 6519, the survey plat of which is referred to as Project No. S15-777 on file in the office of McCarty Associates, LLC, Washington C.H., Ohio.

All iron pins (set) are 5/8" diameter with 1-1/4" diameter plastic caps stamped "McCARTY ASSOCIATES".

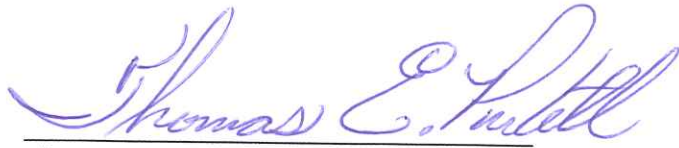

Thomas E. Purtell, P.S. 6519



MCCARTY ASSOCIATES, LLC

ARCHITECTS—ENGINEERS—SURVEYORS

HILLSBORO ————— WASHINGTON C.H. ————— LOVELAND

213 N. HIGH ST., HILLSBORO, OHIO 45133 PH 937-393-9971 FAX 937-393-2480

Michael L. McCarty, P.E., P.S.— Thomas E. Purtell, P.S. — Loren M. Puckett, P.E. — Eric N. Lutz, P.S.— Jerrold B. Bradley, AIA

File No. S15-777

August 28, 2015

LEGAL DESCRIPTION

Roman Catholic Bishop
Of The Diocese of Columbus
To
Madison County Board of Commissioners
41.476 Acres Tract

Situated in the Township of Deercreek, County of Madison, State of Ohio, being a part of V.M.S. Nos. 8965-10927 and 12142-12153, contains 3.872 acres of the 30.18 acres "Parcel I, Tract Two" (Parcel No. 05-00225.000), and contains all (37.604 acres) of the 37.6240 acres "Parcel I, Tract Three" (Parcel No. 05-00224.000) as conveyed to the Roman Catholic Bishop of the Diocese of Columbus and recorded in Deed Book 280, Page 720 of the Madison County Recorder's Office, and being further bounded and described as follows:

Beginning at a 5/8" iron pin (set) near the east edge of the pavement of LaFayette-Plain City Road (County Road No. 5), said iron pin being a corner to the 92.851 acres tract as conveyed to John E. Wilson and Christina R. Wilson (O.R. 255, Page 128) as shown on Survey Plat No. 13-10, and having Ohio State Plane Coordinates Northing 716,116.890 feet, Easting 1,716,680.830 feet South Zone and based upon NAD 83 (2011);

thence with Wilson's southerly line S 70°23'00" E, passing a 5/8" iron pin (found) at 16.70 feet, a total distance of 3980.58 feet to a 4 ½" diameter steel post (found) in the northwesterly line of the 178.877 acres "Tract 1" as conveyed to

Paul W. Schrock (O.R. 98, Page 1739) as shown on Survey Plat No. 42-99;

thence with Schrock's northwesterly line S 43°42'12" W, a distance of 179.12 feet to a 1" iron pipe (found);

thence with Schrock's southwesterly line S 51°13'02" E, a distance of 1757.73 feet to a 5/8" iron pin (found) in the northerly limited access right-of-way line of Interstate 70 (MAD-70-6.25) from which a 1" iron pipe (found bears S 55°02'19" E, a distance of 1.66 feet;

thence with the northerly limited access right-of-way line of Interstate 70 for the next three calls:

- (1) S 77°56'08" W, a distance of 528.51 feet to a 5/8" iron pin (set);
- (2) S 75°03'44" W, a distance of 685.11 feet to a 5/8" iron pin (set);
- (3) S 74°19'06" W, a distance of 485.17 feet to a 5/8" iron pin (set), said iron pin being the southeasterly corner of the 51.981 acres "Tract II" as conveyed to Ryan McMurray and Elizabeth E. Cluchey (O.R. 232, Page 1983) as shown on Survey Plat No. DE-24A;

thence with McMurray's easterly line N 21°40'11" W, a distance of 154.08 feet to a 5/8" iron pin (set);

thence also with McMurray's easterly line N 29°38'15" W, a distance of 828.90 feet to a 5/8" iron pin (set) near a post stub, said iron pin being the southerly most corner of the original 50.28 acres "Parcel I, Tract One" as conveyed to the Roman Catholic Bishop of the Diocese of Columbus and recorded in (D.B. 280, Page 720);

thence with the southeasterly line of the Roman Catholic Bishop of the Diocese of Columbus N 48°33'34" E, passing the

northeasterly corner of the original 50.28 acres "Parcel I, Tract One" and continuing with the southeasterly corner of the 30.18 acres "Parcel I, Tract Two" as conveyed to the Roman Catholic Bishop of the Diocese of Columbus and recorded in (D.B. 280, Page 720), a distance of 949.89 feet to a 5/8" iron pin (set);

thence with a new division line for the next three calls:

- (1) N 51°13'02" W, a distance of 36.70 feet to a 5/8" iron pin (set);
- (2) N 28°15'35" E, a distance of 148.68 feet to a 5/8" iron pin (set);
- (3) N 70°23'00" W, passing a 5/8" iron pin (set) at 3848.68 feet, a total distance of 3872.03 feet to a Mag nail (set) in LaFayette-Plain City Road;

thence with LaFayette-Plain City Road N 14°38'00" E, a distance of 40.15 feet to the beginning, containing 41.476 acres of land.

Subject to all legal easements and rights-of-way of record.

Bearings are based upon the Grid Azimuth (AZ. 46° 09' 04.5") between National Geodetic Survey CORS Station "OHMD" and Madison County Geodetic Survey Monument "MAD 02-016" and derived from GPS observations taken July 25, 2014, utilizing the Trimble ODOT CORS VRS (Virtual Reference System).

Land surveyed in August 2015, under the direction of Thomas E. Purtell, Registered Professional Surveyor No. 6519, the survey plat of which is referred to as Project No. S15-777 on file in the office of McCarty Associates, LLC, Washington C.H., Ohio.

All iron pins (set) are 5/8" diameter with 1-1/4" diameter plastic caps stamped "McCARTY ASSOCIATES".

Thomas E. Purtell

Thomas E. Purtell, P.S. 6519

