

BIGELOW AVENUE (26.5' WIDE)

BEARINGS ARE BASED ON A
GPS OBSERVATION ON 01/16/14
WGS 1984 GEODETIC NORTH.

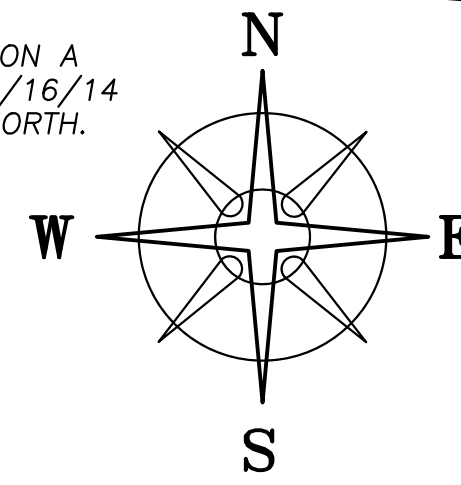

POB
N=768405.71'
E=1754436.13'

DEED REFERENCE
VILLAGE OF PLAIN CITY
COUNCIL BLDG & JAIL

PARCEL No. 04-00725.000
Ⓐ 0.588 ACRES
BEING THE PUBLIC SQUARE OF
ISAAC BIGELOW'S THIRD ADDITION
RECORDED IN PB 14 PG 478

0.0882± ACRES

Ⓐ
WATER
TOWER

LEGEND

ALL MONUMENTS FOUND OR SET ARE IN
GOOD CONDITION UNLESS OTHERWISE NOTED.

- ⊙ 3/4" Ø IRON PIPE (FOUND)
- 5/8" Ø IRON PIN (FOUND)
- ⬡ 5/8" Ø REBAR & YELLOW PLASTIC CAP
STAMPED "COTTRILL SURVEYING" (SET)
- △ MADISON CO MON #05-028 (FOUND)
- ⊕ 3/4" Ø PIPE & YELLOW PLASTIC CAP
STAMPED "BIRD & BULL LTD" (FOUND)

LOCATION MAP

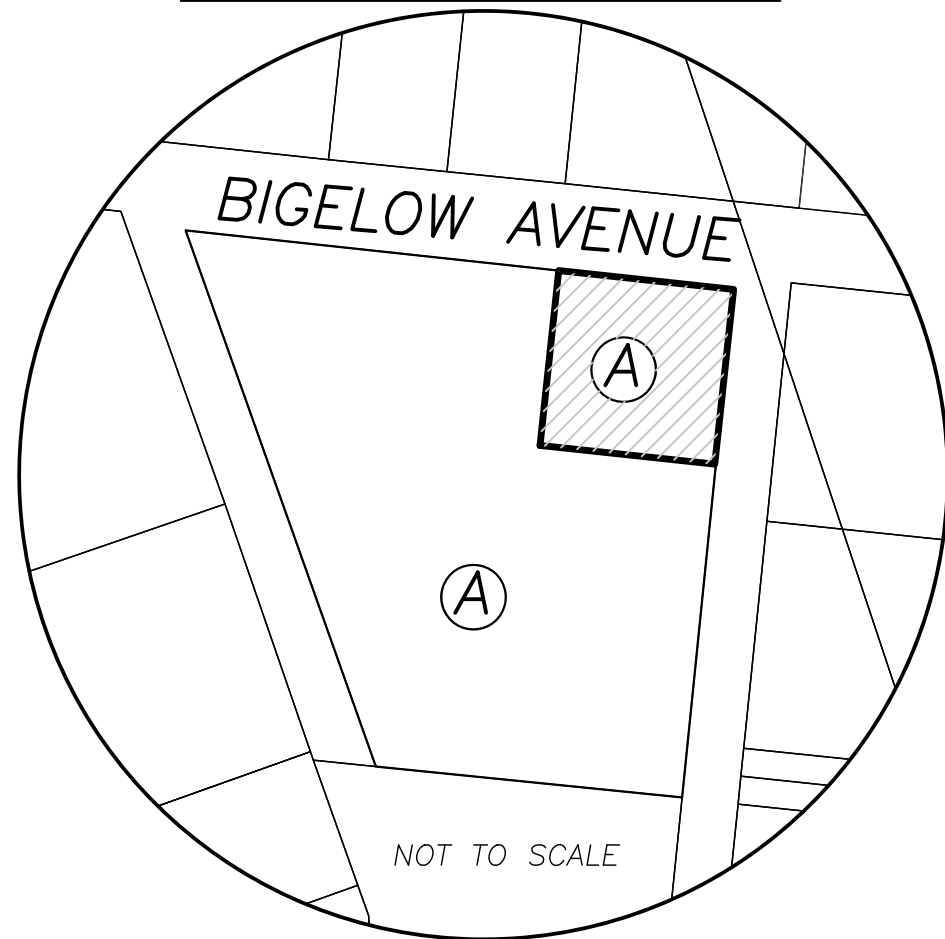

19.8' ALLEY

VMS 5128
VMS 7758

S 42°52'59" W
4044.32'



I HEREBY CERTIFY THAT THIS PLAT DEPICTS
AN ACTUAL FIELD SURVEY PERFORMED BY
NATHAN L. COTTRILL, P.S. #8821

Nathan L. Cottrill DATE: 04/25/23

COTTRILL SURVEYING, INC

James R Cottrill, PS Nathan Cottrill, PE PS
15882 US Route 62 NE, Mt. Sterling, Ohio 43143
Office: (740) 869-3811 www.cottrillsurveying.com

0.0882± ACRES,
VMS 7758, VILLAGE OF PLAIN CITY
MADISON COUNTY, STATE OF OHIO.
SURVEYED FOR VILLAGE OF PLAIN CITY

SCALE : 1" = 10'
10' 5' 0' 10'

JOB No. S230410 CREW: MW
SURVEYED 04/18/23 DWN BY: NC
DRAWN 04/20/23 CHECK: RC

COTTRILL SURVEYING, INC

15882 US Route 62 SE, Mt. Sterling, Ohio 43143, Ph. 740.869.3811, www.cottrillsurveying.com

0.0882 Acre Tract *Surveyed for Village of Plain City*

The following described 0.0882 acre tract is situated in the State of Ohio, Madison County, Village of Plain City, VMS 7758, being part of a 0.588 acre tract (Parcel 04-00725.000; being the Public Square of Isaac Bigelow's Third Addition as recorded in Plat Book 14 page 478) as dedicated to the Village of Plain City Council Building and Jail, and being more particularly described as follows:

Beginning at a 5/8 inch diameter iron pin found at the intersection of the South line of Bigelow Avenue (26.5 feet wide) with the West line of a 19.8 feet wide alley and being the Northeast corner of said 0.588 acre tract;

Thence, with the West line of said alley, **South 04° 38' 12" West** a distance of **62.00 feet** to an iron pin and cap set;

Thence, across said 0.588 acre tract with the following two courses:

- 1) **North 85° 21' 48" West** a distance of **62.00 feet** to an iron pin and cap set;
- 2) **North 04° 38' 12" East** a distance of **62.00 feet** to an iron pin and cap set in the South line of Bigelow Avenue;

Thence, with the South line of Bigelow Avenue, **South 85° 21' 48" East** a distance of **62.00 feet** returning to the **Point of Beginning**, containing **0.0882 Acres** more or less.

Bearings are based on a GPS observation on January 16, 2014, WGS 1984 Geodetic North.

Subject to and with the benefit of all legal highways, restrictions, easements, limitations, and reservations, of record, if any and to zoning restrictions which have been imposed thereon, if any.

All iron pins set are 5/8-inch diameter rebar with yellow plastic cap stamped "Cottrill Surveying"

This description is based on an actual field survey performed by Nathan L. Cottrill, PS registration #8821 on April 18, 2023.



A handwritten signature in blue ink that reads "Nathan Cottrill".

Nathan L. Cottrill, PS #8821
(Job #S230410-0.0882)