

AMHERST MEADOWS SECTION 4

Situated in the State of Ohio, County of Madison, City of London, being part of Virginia Military Survey No. 5802 and containing a Total of 8.856 acres of land, more or less, of which 3.461 acres are out of that 34.000 acre tract of land conveyed to Community Development Company, as shown for record in Official Record Volume 20, Page 500, and of which 5.395 acres are out of that 18.160 acre tract of land conveyed to Community Development Company, as shown for record in Official Record Volume 40, Page 168, Recorder's Office, Madison County, Ohio.

The undersigned, William A. Goldman, President of F&G Property Development, Inc. a managing Partner of Community Development Company and Frank J. Cipriano, President of Parkmead Corporation, a managing Partner of Community Development Company, owner of the lands platted herein, being duly authorized in the premises, does hereby certify that this plat correctly represents their "AMHERST MEADOWS SECTION 4", a subdivision of Lots, Numbered 104 through 135 inclusive, and does hereby accept this plat of same and dedicates to public use as such all or parts of Amherst Boulevard, Wilshire Court, Dorset Drive and Banberry Court shown hereon and not heretofore dedicated.

Easements are reserved where indicated on the plat for the construction, operation and maintenance of all public and private utilities, and the cable television industry, both above and beneath the surface of the ground and, where necessary, are for the construction, operation and maintenance of service connections to all adjacent lots and lands and for storm water drainage.

In witness whereof, William A. Goldman, President of F&G Property Development, Inc. and Frank J. Cipriano, President of Parkmead Corporation managing partners of Community Development Company, has hereunto set their hands this _____ day of _____, 2000.

WITNESSES:

_____ BY _____
F&G PROPERTY DEVELOPMENT COMPANY, INC.
Managing Partner
William A. Goldman, President

_____ BY _____
PARKMEAD CORPORATION
Managing Partner
Frank J. Cipriano, President

State of Ohio
County of Franklin, SS

Before me, a Notary Public in and for said State, personally appeared William A. Goldman, President of F&G Property Development, Inc. and Frank J. Cipriano, President of Parkmead Corporation, managing partners of Community Development Company who acknowledged the signing of the foregoing instrument to be their free and voluntary act and deed for the uses and purposes therein expressed.

In Witness Whereof, I have hereunto set my hand and affixed my official seal this _____ day of _____, 2000.

My Commission Expires: _____
Notary Public, State of Ohio

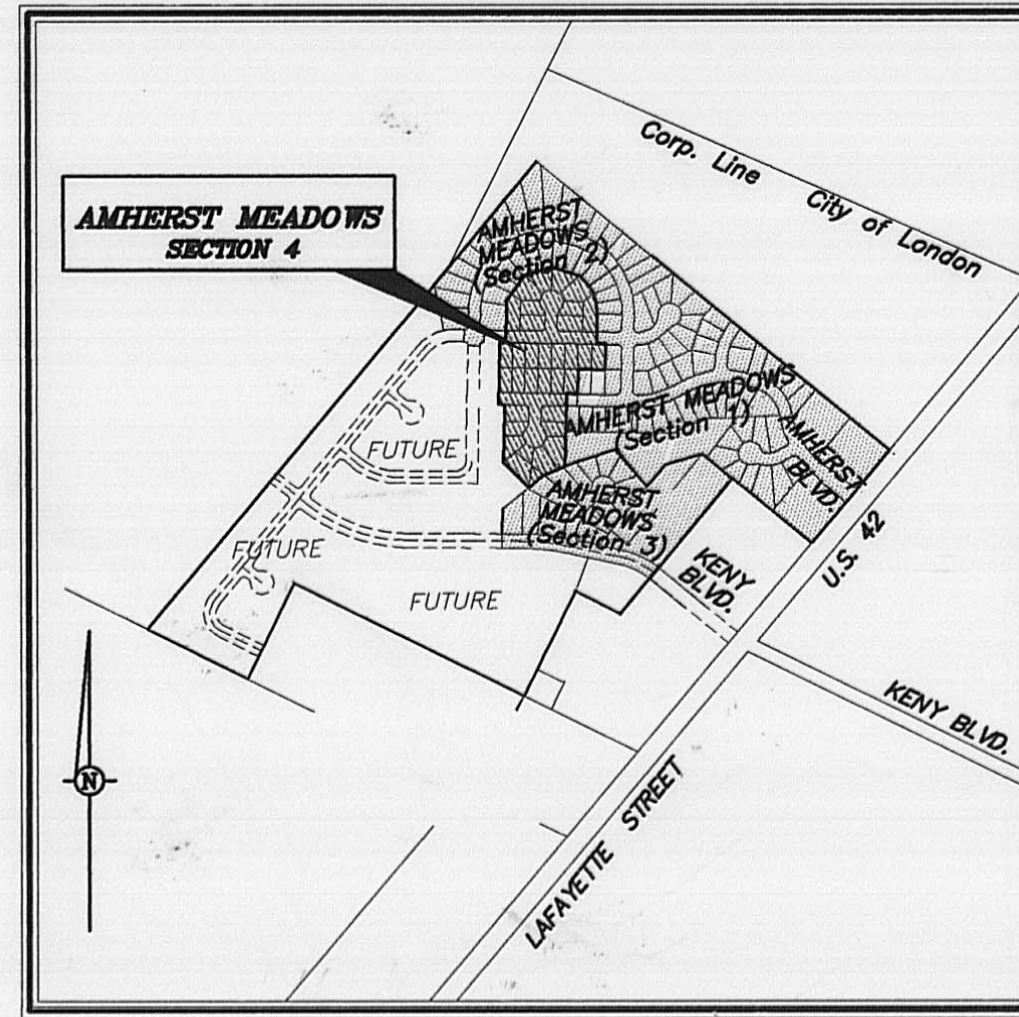

LOCATION MAP
NO SCALE

PREPARED BY:
Geo-Graphics Inc.
Land Surveying & Civil Engineering
685 North James Road Columbus, Ohio 43219
614-231-2016



CERTIFICATION BY SURVEYOR

We do hereby certify that we have surveyed the above premises and prepared the attached plat and that said plat is correct. All measurements are shown in feet and decimal parts thereof. Dimensions along curves are chord measurements unless otherwise indicated. Iron pipes are indicated by the following symbol: —○—. Permanent monuments to be set upon completion of construction necessary to the improvement of this land are indicated by the following symbol: —⊙—.

The bearings shown on the plat are based on the centerline of U.S. 42 (Lafayette Street) as described in Deed Volume 271, Page 453 of the public records of the Madison County Recorder's Office, Madison County, Ohio.

By _____
Robert E. Blackburn — Ohio Surveyor No. 6305

Approved this _____ day of _____, 2000.

Planning Commission Chairman
City of London

Approved this _____ day of _____, 2000.

Mayor, City of London

Approved this _____ day of _____, 2000.

Safety-Service Director
City of London

Transferred this _____ day of _____, 2000.

Auditor, Madison County, Ohio

Filed for record this _____ day of _____, 2000. at _____, _____ M.

Fee \$ _____ File No. _____

Recorder, Madison County, Ohio

Recorded this _____ day of _____, 2000, in Plat Cabinet _____