

Newport

William Coberlys Second Addition

William Coberlys Second Addition.

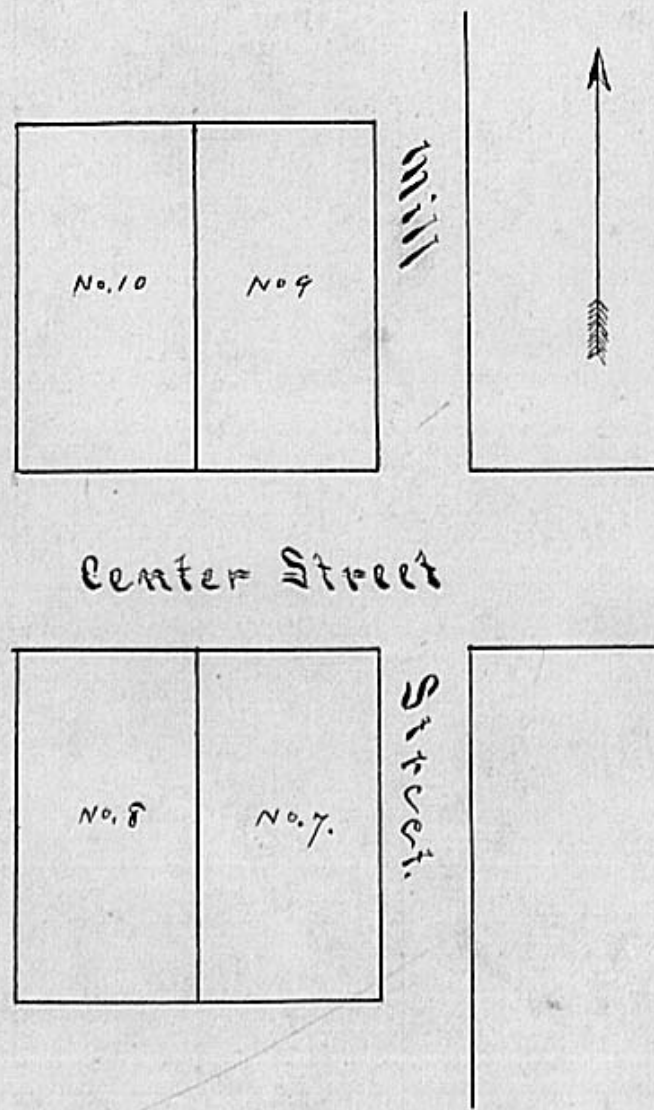

William Coberlys 2nd Addition to the Town of Newport situated in Madison County and is described as follows Center Street is laid out and Continued from said Wm Coberly's 1st Addition to said Town. S 89° W 8 poles and 4 poles wide. Lot No 7 lies on the south side of said Center Street - Extending 4 poles on said Street and 8 poles South on Mill Street No 8 also four 4 poles on the south side of Center Street and extending 8 poles South No 9 which is designed for a church lot fronts 4 poles on Center Street lying on the north side thereof and extending North eight poles and bounded on the East by Mill Street No 10 also fronts 4 poles on the North side of Center Street and extends 8 poles North all which is fully and clearly shown by a plat of said 2nd Addition. Connected with a plat of the first.

May 17th 1854.

John Rouse Surveyor.

The State of Ohio, Madison County, ss.

Before me the subscriber a Justice of the peace in and for the said County aforesaid personally appeared William Coberly and acknowledged Coberlys second addition to the Town of Newport according to the plat and Specifications hereunto annexed to be his voluntary act and deed for the purposes herein contained

John Jones,
John Rouse.

Wm Coberly.

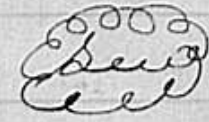
John Jones J. P. 

The foregoing plat and specifications were filed for Record on the 25th day of May A.D. 1854. and Recorded instant, Original Record. Town Plat. Book. Vol 1. Page 1^a

O. P. Crabb. R. M. C.