

London  
William Watson's  
Addition.

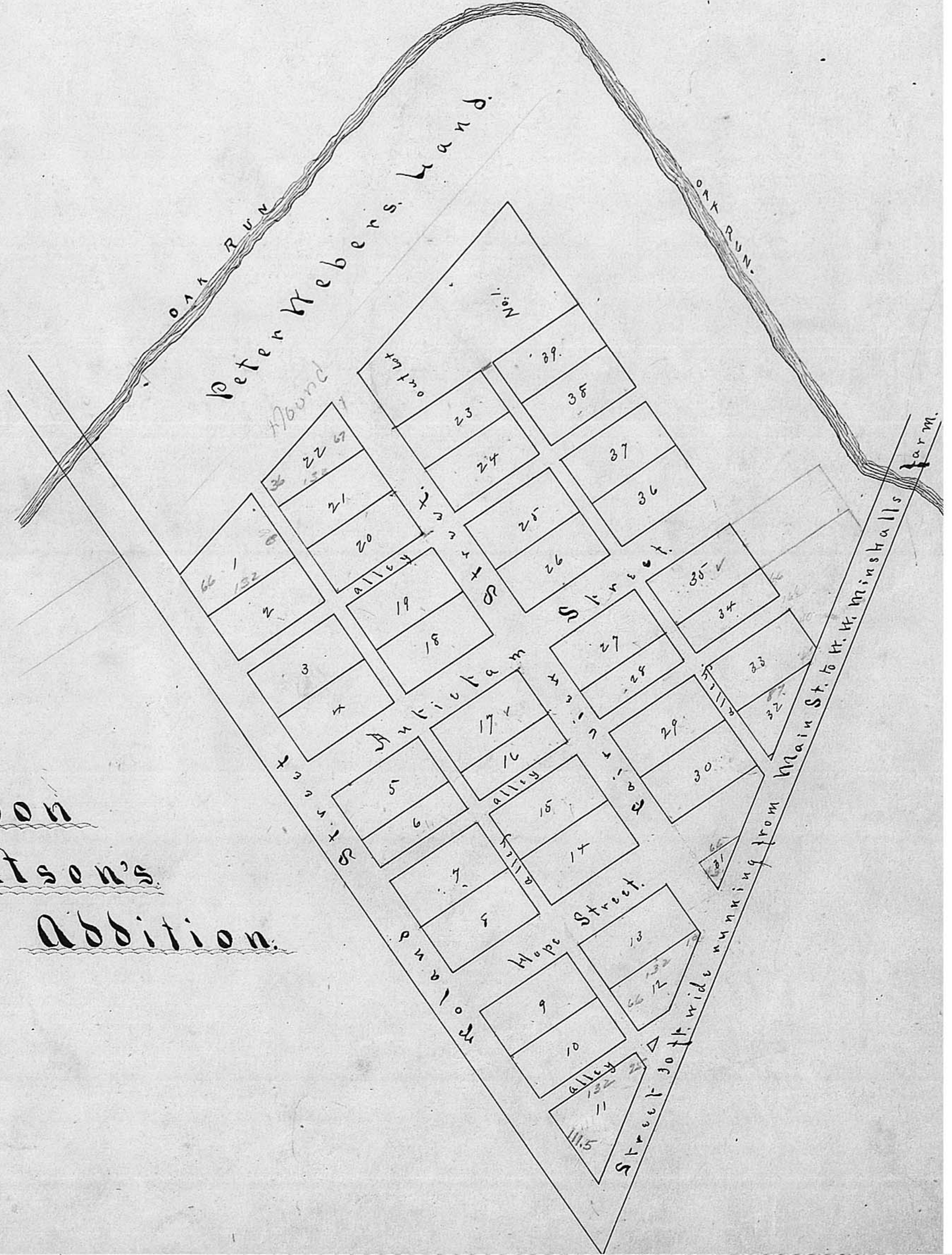

London

William Watson's Addition.

This is to Certify that J. Levin Willoughby surveyed and laid out for William Watson the aforesaid Addition bounded and described as follows.

Said Lots are based on and laid out in right Angles to Soland Street. Said Street being laid out by Jesse Watson and J. L. Minshall, through and from their Addition to London. Lots Nos 2, 3, 4, 5, 6, 7, 8, 9, 10, 13, 14, 15, 16, 17, 18, 19, 20, 21, 23, 24, 25, 26, 27, 28, 29, 30, 32, 33, 34, 35, 36, 37, 38 & 39, are each 66 feet front by 132 feet back. No 1 is 66 feet front 132 feet back and 98 feet rear. No 11 is 111 1/2 feet front, by 132 feet back, and 25 feet rear. No 12 is 66 feet rear, 10 feet front and 132 feet back. No 22 is 67 feet 8 inches front 36 feet rear and one hundred thirty two feet back. No 31 is 43 feet front 66 feet back and nothing in the rear. No 32 is 63 feet in the rear running to a point 87 feet back. No 33 is 66 feet rear and of equal breadth for 87 feet then for forty five (45) feet tapers to 40 feet front. Out Lot No 1 is 9 rods in front and 4 rods 14 feet in the rear. The Streets are 50 feet in width excepting the one marked 30 feet which is with Soland Street are no part of said addition to London. The Alleys are one rod wide. The N.W. corner of Lot No 1 is the N.W. corner to William Watsons land.

Levin Willoughby Surveyor.