

Abraham J. & Elizabeth Farmwald
Pt. of 45^{ac} D.B. 149, p. 315

N. 10° 33' E.
675.84'

5.808^{AC}

S. 78° 12' E.
433.47'

U.S. ROUTE No. 42 60' R/W.

S. 14° 02' W.
528.70'

DARBY

To Plain City

To London

To London

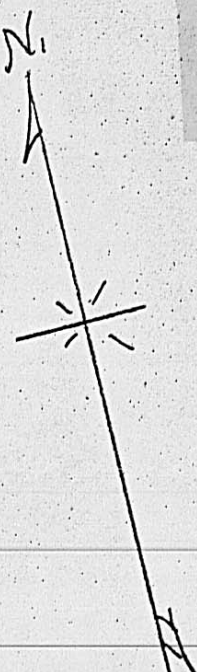

Chiseled "X" on Conc. Block
N. 79° 55' W.
180.25'

Lowell L. Wellman
0.400^a
D.B. 216
p. 69, 70

Abraham J. Farmwald
0.10^a

Center of Conc. post 24.00' N. 79° 44' W. 170.95'

CONVERSE-HUFF ROAD

Begin for Darby Plains Dairy, Inc. Description

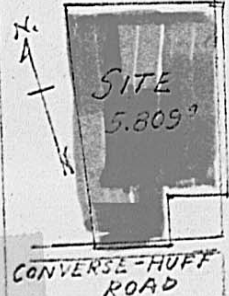
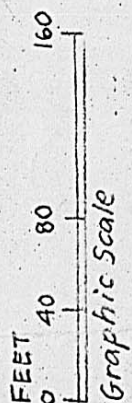

SITE MAP
Scale, 1" = 500'

SURVEY OF 5.808^{AC} TRACT
VIRGINIA MILITARY SURVEY "7432-7756"
DARBY TWP. MADISON COUNTY
OHIO

Harvey & Probasco
Engineers & Surveyors
London Grove City

Scale, 1" = 80'

July, 1977

F. K. Harvey
Registered Surveyor No. 2570

Surveyed for,
Mr. Abraham J. Farmwald

18A

REFERENCE: Being part of a 45 acre tract as conveyed to Abraham J. & Elizabeth Farmwald as recorded in Deed Book 149, page 315 in Madison County, Ohio records.