

Dorothy Downing et al
D.B. 117, Page 274
N 8° 30' 00\"/>

1630.15' to SW.
Property Corner
(Stone)
of 95.68 Ac. Tract

Corner is
Center of Steel Fence
Post

James V. Shaw
Tract I, 2nd Parcel

James V. Shaw
Tract I, 2nd Parcel

1.167 Acres

James V. Shaw
Deed Book 176, Page 284
Tract I, 2nd Parcel

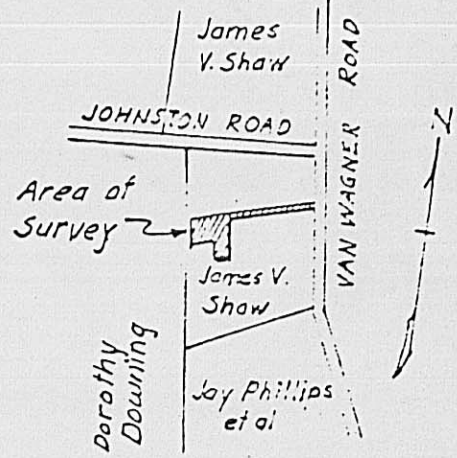

LOCATION MAP
No Scale

REFERENCE:

Being part of a 95.68 Acre Tract (Second Parcel) as conveyed to James V. Shaw by Certificate for Transfer in the matter of the Estate of Florence V. Shaw, deceased, as recorded in Deed Book 176, Page 284, Madison County, Ohio records.

L. W. Probasco
Registered Surveyor No. 2496

HARVEY & PROBASCO
Registered Engineers & Surveyors

SURVEY OF 1.167 ACRE TRACT
VIRGINIA MILITARY SURVEY No. 805B
OAK RUN TWP., MADISON CO., OHIO

FOR
MADISON PORK, INC. **8B**
Scale: 1" = 50' JULY, 1973