

PENN-CENTRAL RAILROAD SYSTEM

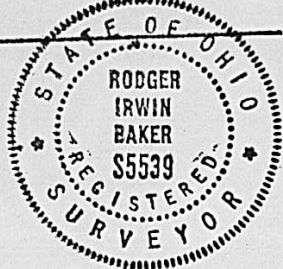

S67°07'W  
288.00'

S67°07'W  
85.33'

I certify I have prepared this plat and description from the best field data... and from the information furnished me.. In my opinion this platting does conform with the existing evidence....I believe it to be correct:  
*Rodger Irwin Baker*  
Surveyor #S-05539...Ohio

SCALE: 1"=50'

3.148 ACRES  
VMS 8742  
UNION TOWNSHIP  
VOL. 167 PAGE 163

"THE COLUMBUS PRODUCTION CREDIT"  
ASSOCIATION  
"GRANTEE"

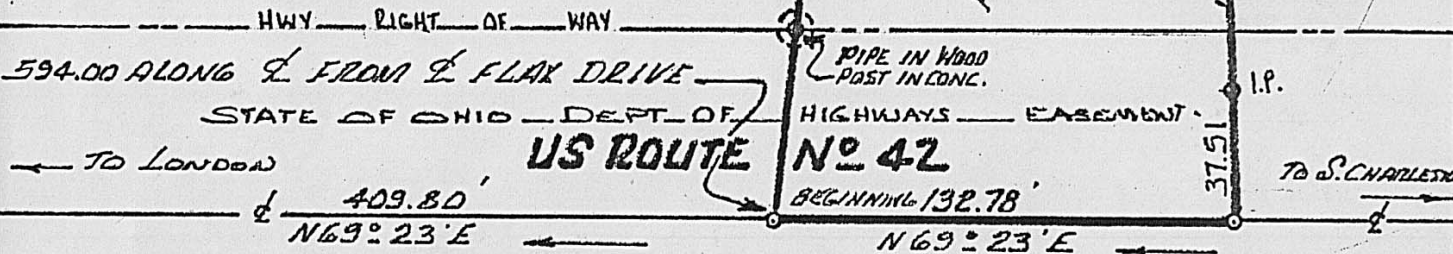

1.007 ACRES PART OF VMS 8742  
PART OF ORIGINAL DEED VOL. 156 PG. 686  
HAROLD AND EDWINA JACKSON PROPERTY  
OUT OF APPARENT EXISTING 4.893 ACRES

NEW PROPERTY LINE SURVEYED SEPT. 1974  
N 22° 28' W 404.26'

HAROLD AND EDWINA JACKSON PROPERTY  
APPARENT RESIDUE OF 3.886 ACRES  
VMS 8742

Beginning with the northwesterly corner to 3.148 acres belonging to Columbus Production Credit...in the centerline to US Route 42...S 69 deg 23 min W along said centerline from the middle to Flax Drive...London, Ohio.....

- Thence: With Production Credit's westerly boundary..S 15 deg 42 min E 402.15 feet to the north boundary of Penn-Central Railroad;
- Thence: Following Penn-Central Right of way..S 67 deg 07 min W 85.33 feet;
- Thence: At a near right angle...crossing a flowing ditch..N 22 deg 28 min W 404.26 feet to a pin in the centerline of US Route # 42;
- Thence: With said centerline...N 69 deg 23 min E 132.78 feet to the beginning

Containing 1.007 acres...in VMS 8742...Union Township, Madison County, Ohio, a portion of 4.893 acres belonging to Harold and Edwina Jackson; surveyed by Rodger Irwin Baker...Ohio Licensed Surveyor No. S-05539:

*Rodger Irwin Baker*  
Rodger Irwin Baker S-05539  
235 South Main Street  
London, Ohio 43140

Deed Reference: 156 vol page 686 was original deed to Jackson's:

- Less Vol. Prod'n Credit vol 167 pg 163
- Less Jean Dunkle vol. 213 pg 510